

REFERENCE: FILE APPLICATION #S-72129

SITUATED IN THE NE 1/4 SW 1/4 AND W 1/2 SE 1/4 OF SECTION 8, AND THE E 1/2 OF SECTION 17, T40S, R14EW, KLAMATH COUNTY, OREGON

SEPTEMBER 1993

RECEIVED

MAP PREPARED FOR  
-- RICHARD A. SMITH --

MAP PREPARED FROM  
-- U. S. G. S. 7.5' QUADRANGLE MAPS --  
-- AERIAL PHOTO --

AUG 12 1996  
WATER RESOURCES DEPT.  
SALEM, OREGON



SCALE  
1" = 1320'

LOCATION OF RESERVOIR DIVERSION  
1700 feet south and 338 feet east  
of northeast corner of Section 17

LOCATION OF WELL BY OWNER  
1700 FEET SOUTH AND 200 FEET EAST OF  
THE NORTHEAST CORNER OF SECTION 17

TOTAL AREA THIS APPLICATION  
-- 170.7 Ac. --

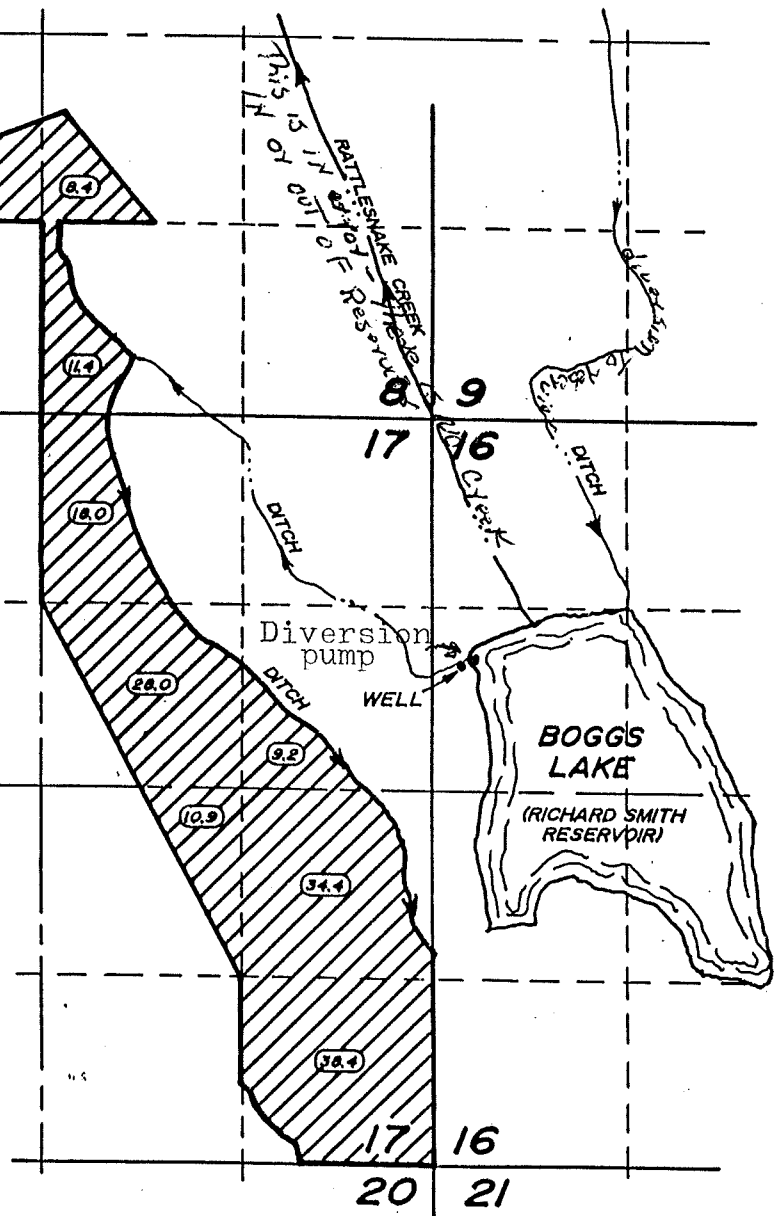
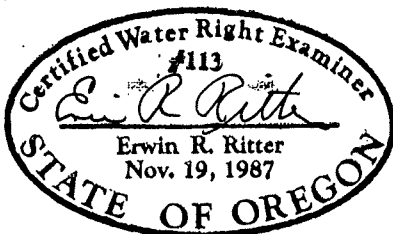

Application No. S 72129  
Permit No. 53428

THE PURPOSE OF THIS MAP IS TO IDENTIFY THE LOCATION OF THE  
WATER RIGHT. IT IS NOT INTENDED TO PROVIDE INFORMATION RELATIVE  
TO THE LOCATION OF PROPERTY OWNERSHIP BOUNDARY LINES.

TRU-LINE SURVEYING  
2333 SUMMERS LANE  
KLAMATH FALLS, OR. 97603