

T.5S., R.1E., W.M.

RECEIVED

MAR 25 1996

WATER RESOURCES DEPT.
SALEM, OREGON

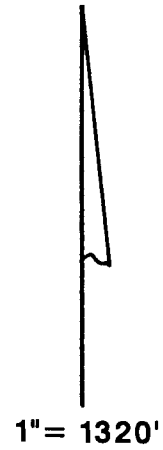
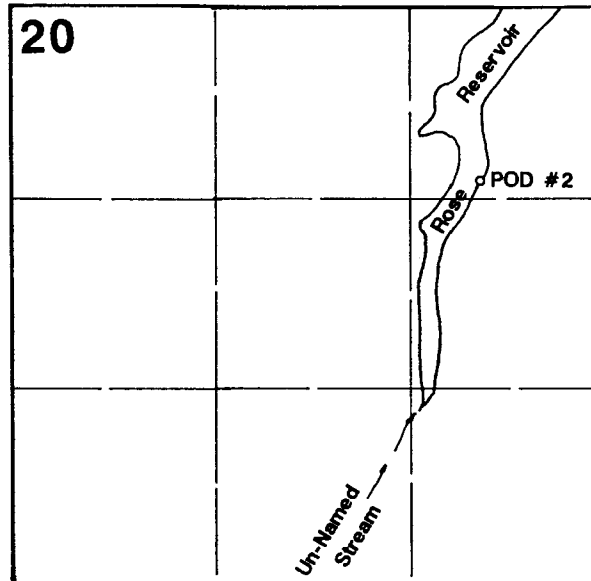

Area Irrigated

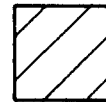

Supplemental from POD

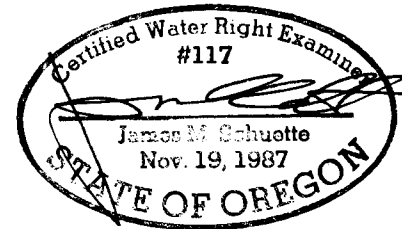
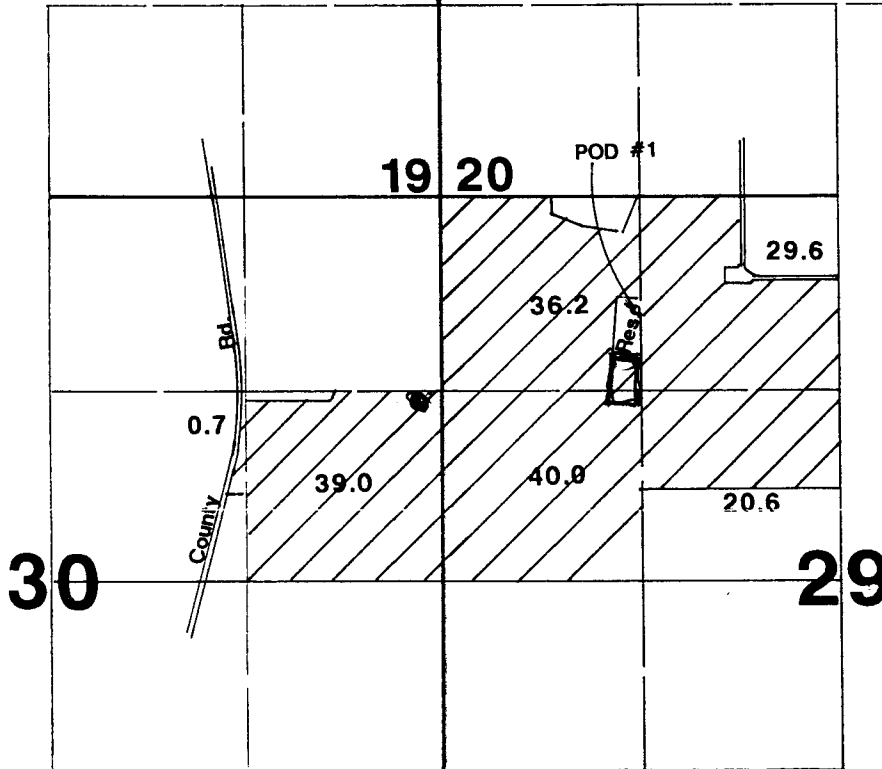

Lonny Neme

POD #1 located 800'S & 1300'E from NW corner Section 29.
POD #2 located 1430'N & 3100'E from W¼ corner Section 20.

Application Map

Roselawn Seed Inc.

THIS MAP WAS PREPARED FOR THE PURPOSE OF IDENTIFYING THE LOCATION OF A WATER RIGHT ONLY AND IS NOT INTENDED TO PROVIDE LEGAL DIMENSIONS OR LOCATION OF PROPERTY OWNERSHIP LINES.

Application #: 5-81034 Permit #: 53441