

Application No. 73172

Permit No. S-53608

RECEIVED

JAN 15 1993

WATER RESOURCES DEPT.
SALMON, OREGON

T. 14S. R. 5W. W.M.

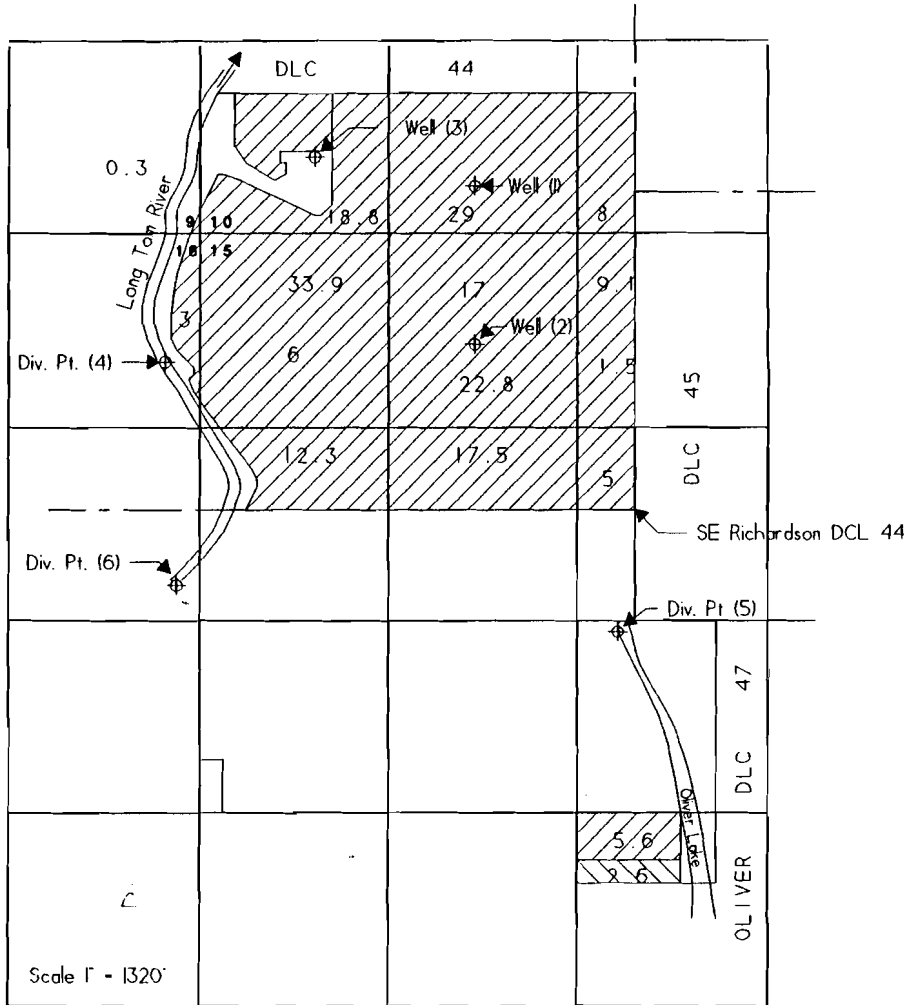

Supplemental

Primary



Diversion Point Locations:

Div. Pt. (6) - Section ¹⁶4, T 14 S., R 5 W., W.M.

5320 feet North and 3850 feet West from SW Corner, Oliver DLC 47.
Pump on Long Tom River

Div. Pt. (4) - Section ¹⁴4, T 14 S., R 5 W., W.M.

940 feet North and 3260 feet West from SE Corner, Richardson DLC 44.
Pump on Long Tom River