

~~SUPERSEDED~~

Application No. 70470

APPLICATION MAP Permit No.

IN THE NAME OF ROBERT M. LOFTIN

SECTIONS 5, AND 8, T29S, R14W, W.M.

FOR SUPPLEMENTAL FLOOD HARVEST

FROM POINT OF DIVERSION # 2

MAP 6 OF 6

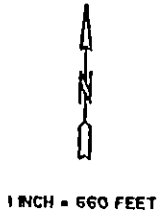

THE PURPOSE OF THIS MAP IS TO IDENTIFY THE LOCATION OF THE WATER RIGHT. IT IS NOT INTENDED TO PROVIDE INFORMATION RELATIVE TO THE LOCATION OF PROPERTY OWNERSHIP BOUNDARY LINES.

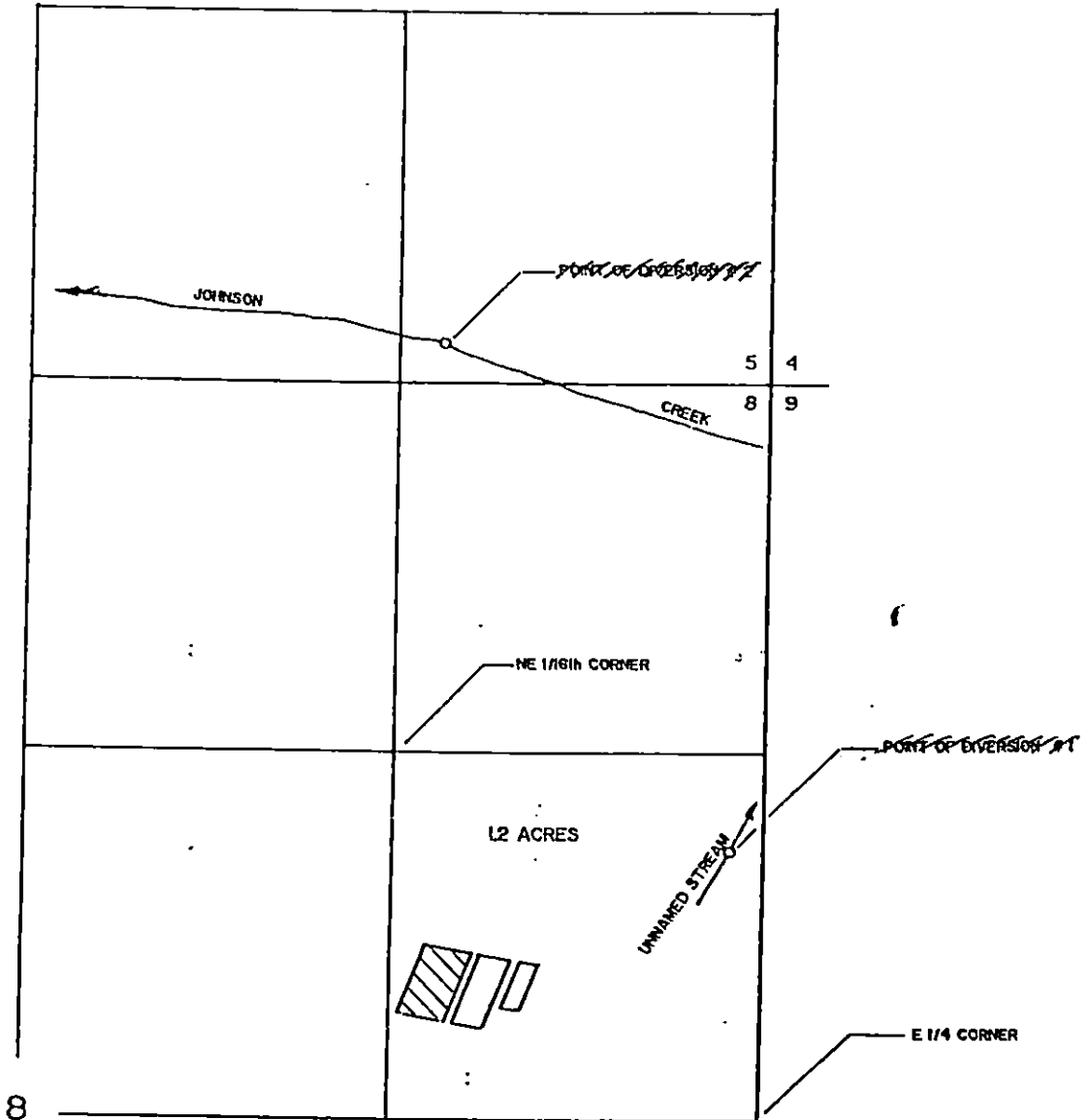

POINT OF DIVERSION # 1 IS TO BE LOCATED 970 FEET NORTH AND 120 FEET WEST FROM THE EAST 1/4 CORNER OF SECTION 8, BEING WITHIN THE SE 1/4 OF THE NE 1/4 OF SECTION 8, TOWNSHIP 29 SOUTH, RANGE 14 WEST, W. M.

POINT OF DIVERSION # 2 IS TO BE LOCATED 1450 FEET NORTH AND 170 FEET EAST FROM THE NORTHEAST 1/16th CORNER OF SECTION 8, BEING WITHIN THE SE 1/4 OF THE SE 1/4 OF SECTION 5, TOWNSHIP 29 SOUTH, RANGE 14 WEST, W. M.

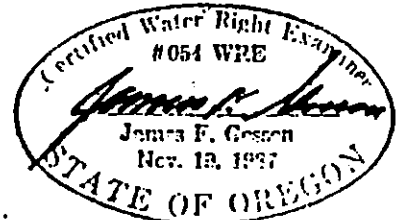

SUPERSEDING

RECEIVED

APPLICATION MAP

APR - 2 1997

IN THE NAME OF ROBERT M. LOFTIN

WATER RESOURCES DEPT.
SALEM, OREGON

SECTIONS 8 & 9, T 29 S, R 14 W, W.M.

A - 70470
P - 53614



1 INCH = 1320 FEET

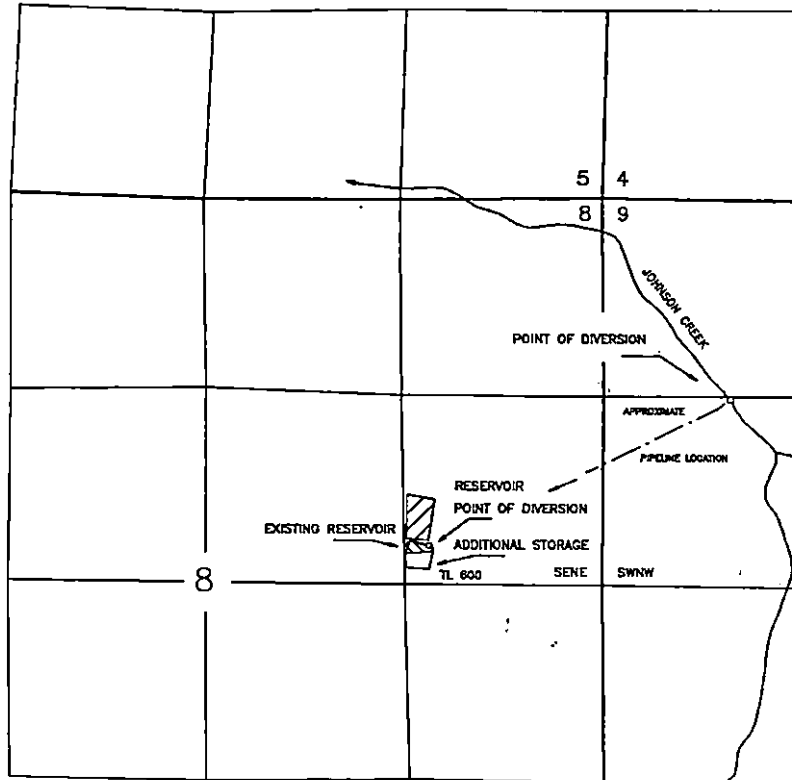

THE POINT OF DIVERSION FROM JOHNSON CREEK IS LOCATED 1,350 FEET SOUTH AND 880 FEET EAST FROM THE NORTHWEST CORNER OF SECTION 9, BEING WITHIN THE SW¹/₄NW¹/₄ OF SECTION 9, TOWNSHIP 29 SOUTH, RANGE 14 WEST, W.M., COOS COUNTY.

THE POINT OF DIVERSION FROM THE RESERVOIR IS LOCATED 2,380 FEET SOUTH AND 1,175 FEET WEST FROM THE NORTHEAST CORNER OF SECTION 8, BEING WITHIN THE SE¹/₄NE¹/₄ OF SECTION 8, TOWNSHIP 29 SOUTH, RANGE 14 WEST, W.M., COOS COUNTY

THE PURPOSE OF THIS MAP IS TO IDENTIFY THE LOCATION OF THE WATER RIGHT. IT IS NOT INTENDED TO PROVIDE INFORMATION RELATIVE TO THE LOCATION OF PROPERTY OWNERSHIP BOUNDARY LINES.