

MAP TO ACCOMPANY APPLICATION FOR A PERMIT
 TO APPROPRIATE SURFACE WATER
 APPLICATION FILE NUMBER S-73764
 APPLICANT: BONNEVILLE POWER ADMINISTRATION
 SECTION 29, T. 3 N., R. 36 E., W.M.
 UMATILLA COUNTY, OREGON

RECEIVED

DEC 29 1964

WATER RESOURCES DEPT.
 SALEM, OREGON

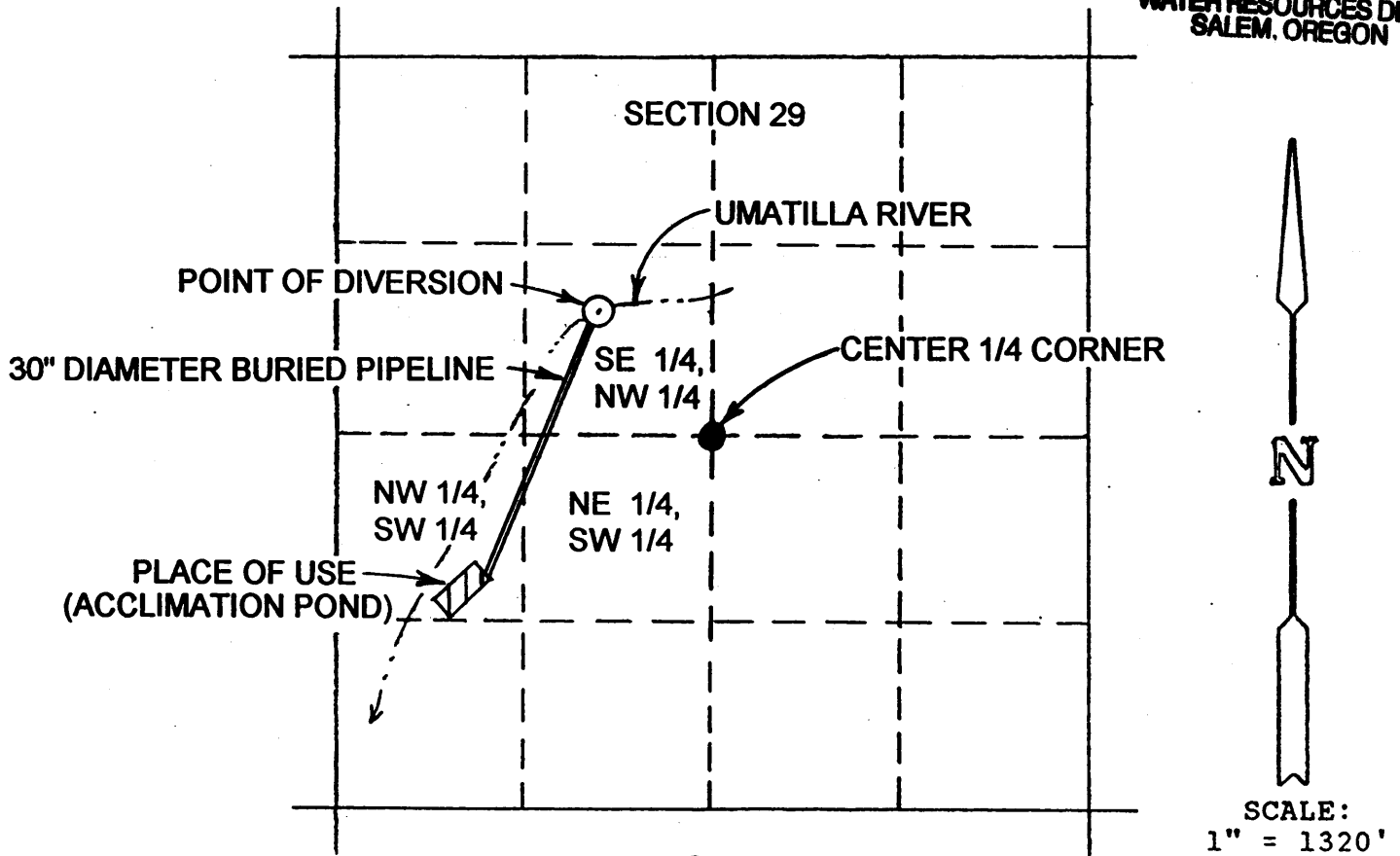

*App. 73764
 Per. 53644*

CORNER TIE:
 THE POINT OF DIVERSION IS 865 FEET NORTH AND 795 FEET WEST OF THE
 CENTER 1/4 CORNER OF SECTION 29, T. 3 N., R. 36 E., W.M.

THIS MAP IS PREPARED FOR
 THE EXPRESS PURPOSE TO
 SHOW WATER APPROPRIATION
 AND USE. IT IS NOT
 INTENDED TO SHOW OR LOCATE
 PROPERTY OWNERSHIP LINES.

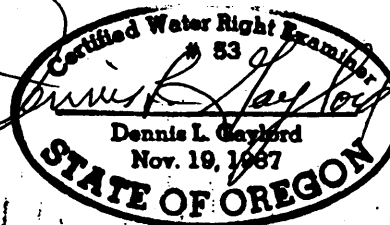

DENNIS L. GAYLORD, CWRE
 71614 S.W. LAKE DRIVE
 PENDLETON, OR 97801
 541-276-6260

RENEWS JUNE 30, 2001