

APPLICATION MAP S-83916

Per. 53649

SEC. 16 T.24S. R.5 W W.M.
DOUGLAS COUNTY

1" = 400'

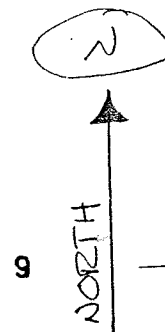

SEC. 15 T.24S. R.5 W W.M.
DOUGLAS COUNTY

1" = 400'

RECEIVED

DEC 15 1998

WATER RESOURCES DEPT.
SALEM, OREGON

