

Application No. 5-84168
 Permit No. 53659

RECEIVED

JUN 08 1999

WATER RESOURCES DEPT.
 SALEM, OREGON

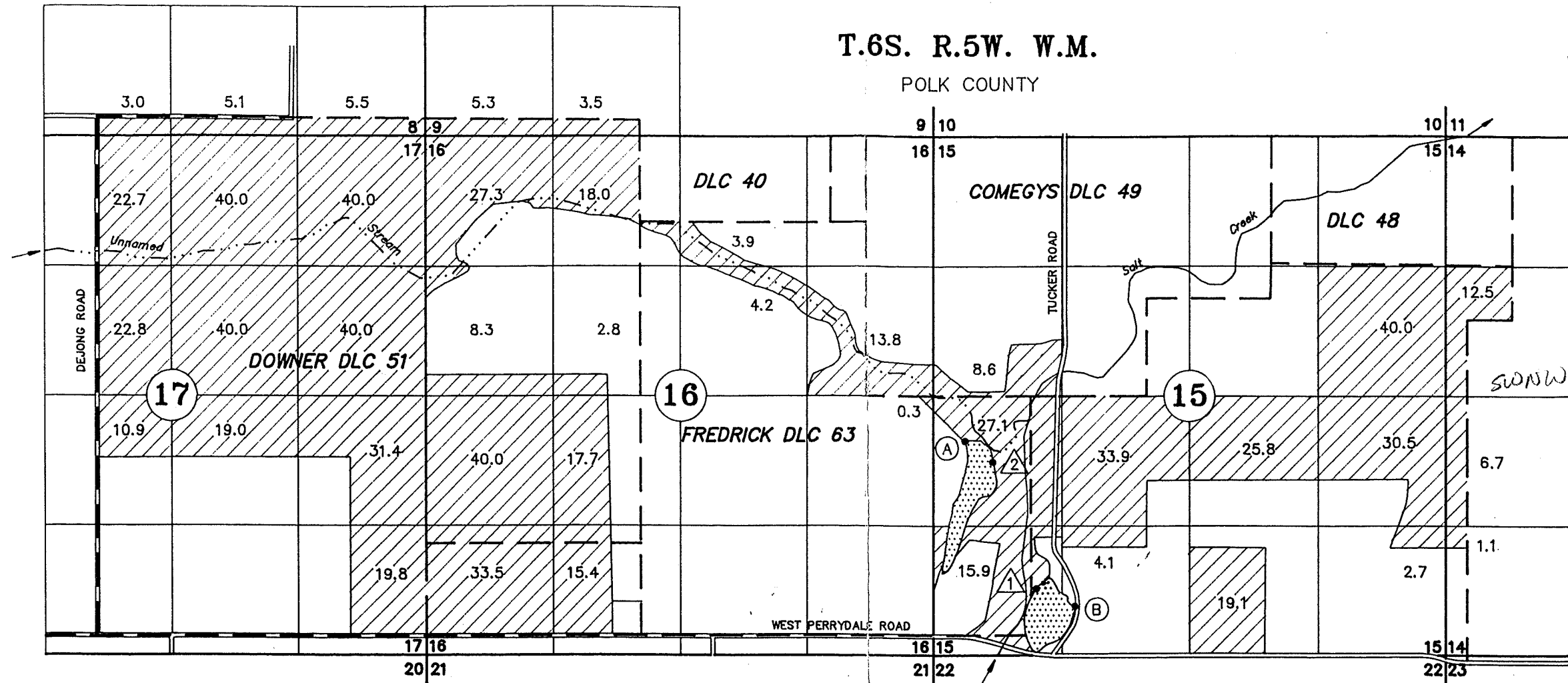

DIVERSION POINTS: RESERVOIR $\triangle 1$: 680' NORTH AND 1590' WEST FROM THE SOUTH 1/4 CORNER OF SECTION 15.
 RESERVOIR $\triangle 2$: 1970' NORTH AND 600' EAST FROM THE SOUTHWEST CORNER OF SECTION 15.

DIVERS'ON POINTS: PUMP $\circ A$: 2185' NORTH AND 325' EAST FROM THE SOUTHWEST CORNER OF SECTION 15.
 PUMP $\circ B$: 505' NORTH AND 1190' WEST FROM THE SOUTH 1/4 CORNER OF SECTION 15.

$\triangle 1$ R-45056 R-5319
 $\triangle 2$ R-54768 R-6543

TAX LOTS:

6 5W 17 00100, 00200, 00700, 00800, 00900, 01000
 6 5W 16 00100, 00101, 00200, 00300
 6 5W 15 00400, 00500, 00700, 00800

APPLICATION NO. 84168

PERMIT NO. _____

APPLICATION TO APPROPRIATE SURFACE WATER

SCHARF BROS. FARMS

JUNE 07, 1999
 SCALE 1" = 1320'

NOTE: This map is for the purpose of identifying the location of water rights and has no intent to dimension or locate property ownership lines.

