

—MAP—

Accompanying application of FRANK E. UPTON, of Central Point, Jackson C<sup>o</sup>, Oregon, for permit to the natural flow, waste, and surplus waters of "Upton" slough, tributary to Bear Creek, tri to Rogue River, Jackson C<sup>o</sup> Oregon, for Irrigation purposes.

— February 1922. —

Tp 36.5.R.2.W.W.M.

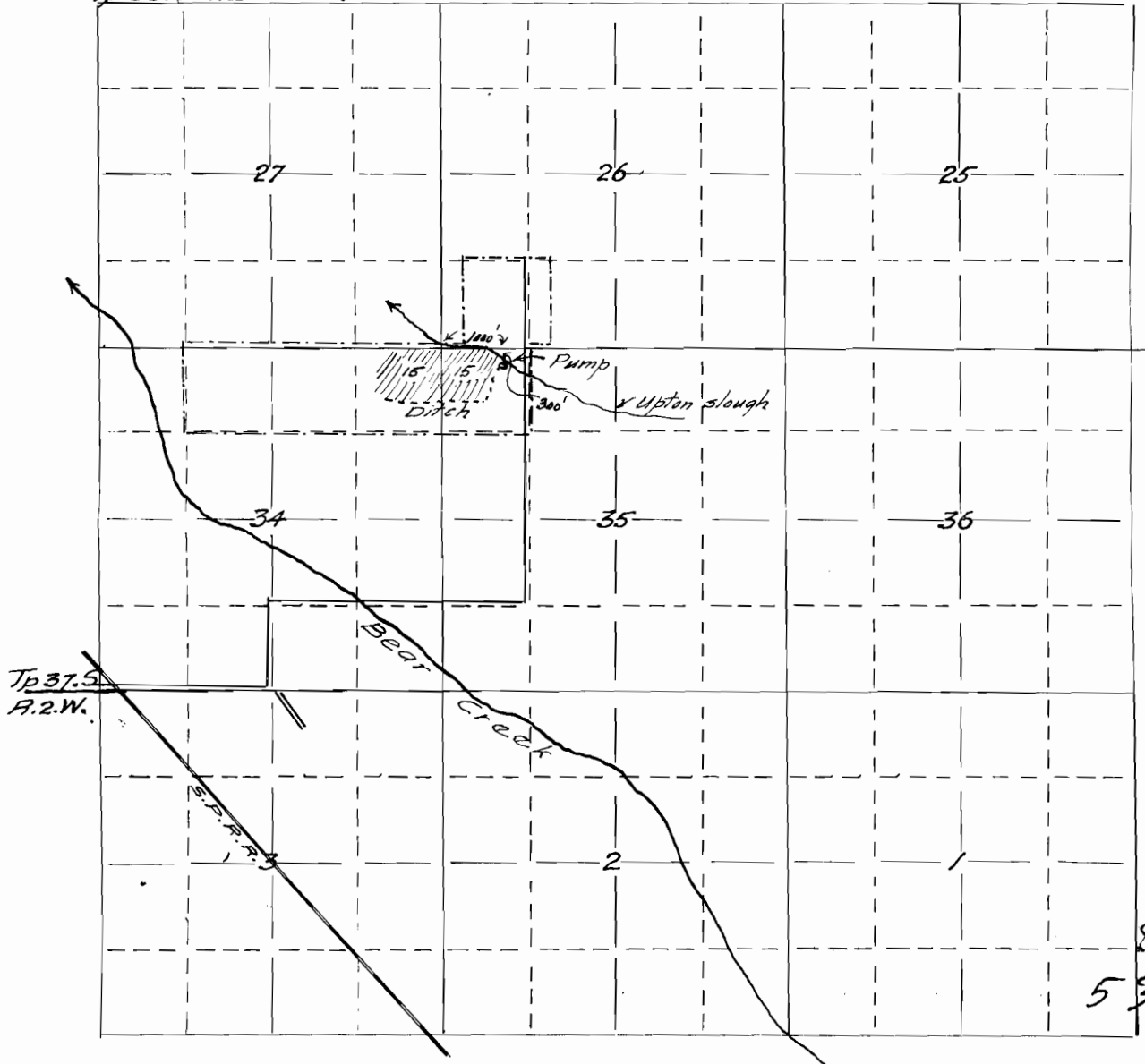

Map made from abstract plat of Frank E Upton lands the same correctly showing the lands to be irrigated to-gether with streams and ditches in immediate vicinity.  
compiled by.

— Fred. N. Cummings, C.E. —