

WATER RIGHT APPLICATION MAP FOR WILLAMETTE INDUSTRIES, INC. WARRENTON LUMBER MILL

RECEIVED
JUN 18 1999
WATER RESOURCES DEPT.
SALEM, OREGON

SECTIONS 15, 16, & 22
T. 8 N., R. 10 W., W.M.
CLATSOP COUNTY, OREGON
SCALE: 1"=400'-0"
115.0 ACRES ±

ONLY DOCUMENTS STAMPED
WITH RED INK ARE ORIGINALS

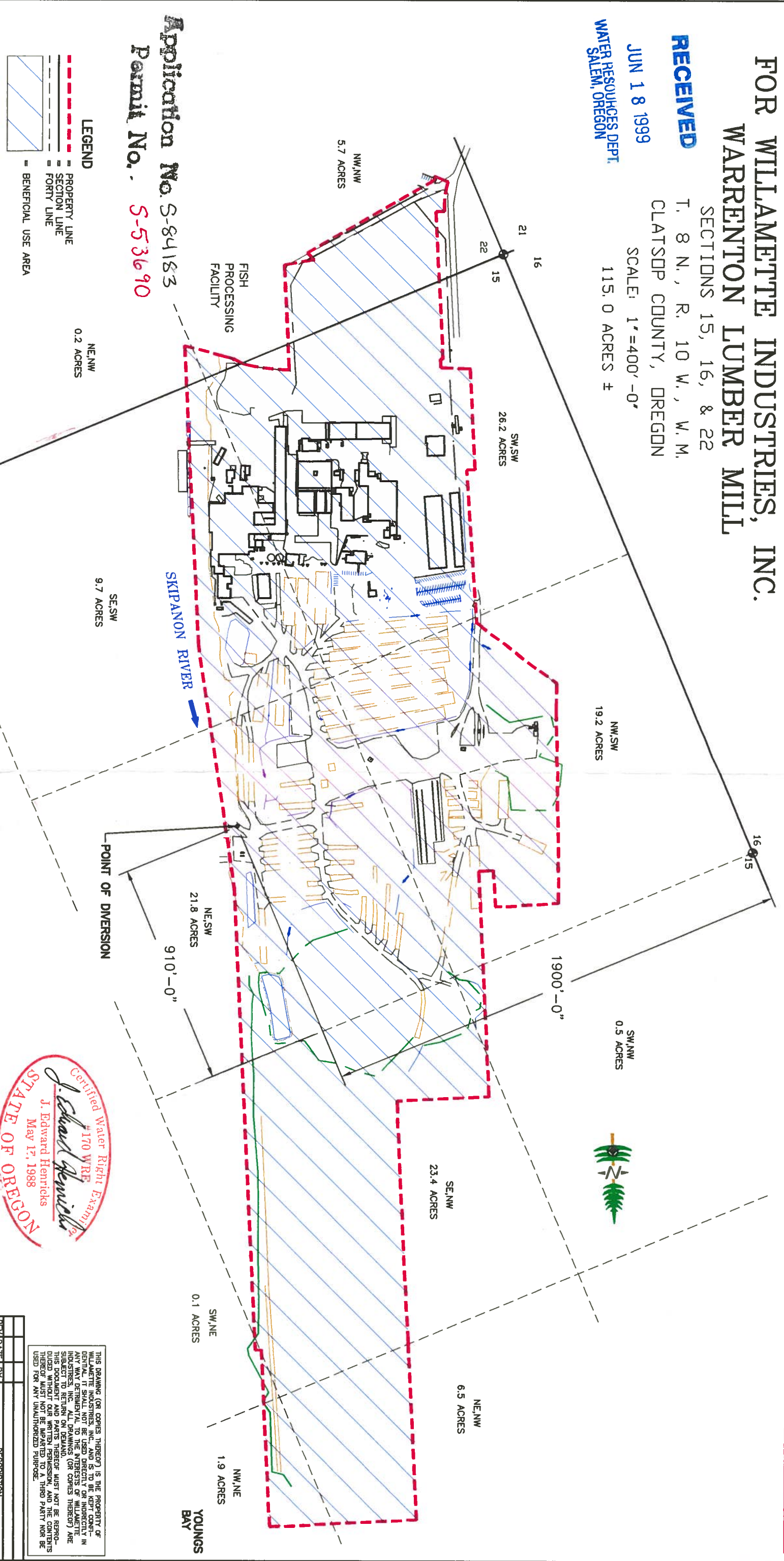

Application No. S-84183
Permit No. S-53690

LEGEND

- PROPERTY LINE
- SECTION LINE
- FORTY LINE
- BENEFICIAL USE AREA

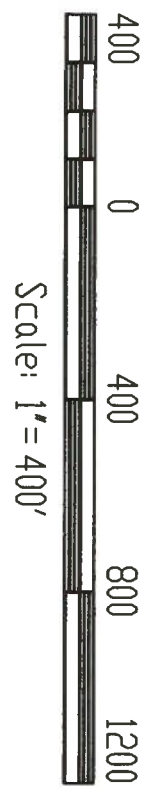

Certified Water Right Examiner
 J. Edward Henricks
 #170 WRE
 May 12, 1988
 STATE OF OREGON

I, J. EDWARD HENRICKS, BEING DULY SWORN AS A WATER RIGHT EXAMINER, LICENSE NO. 170, HAVE PREPARED THIS MAP FOR WILLAMETTE INDUSTRIES, INC. ON THIS 9th DAY OF SEPTEMBER 1998. THE AREAS HATCHED REPRESENT THE ACREAGES BEING APPLIED FOR.

PREPARATION OF THIS MAP IS FOR THE PURPOSE OF IDENTIFYING THE LOCATION OF THE WATER RIGHT ONLY AND HAS NO INTENT TO PROVIDE DIMENSIONS OR LOCATION OF PROPERTY OWNERSHIP LINES.

THIS DRAWING (OR COPIES THEREOF) IS THE PROPERTY OF WILLAMETTE INDUSTRIES, INC., AND IS TO BE KEPT CONFIDENTIAL. IT SHALL NOT BE USED DIRECTLY OR INDIRECTLY IN ANY MANNER THAT WOULD BE PREJUDICIAL TO THE INTERESTS OF WILLAMETTE INDUSTRIES, INC. ALL DRAWINGS (OR COPIES THEREOF) ARE SUBJECT TO RETURN ON DEMAND. THIS DOCUMENT AND PARTS THEREOF MUST NOT BE REPRODUCED WITHOUT OUR WRITTEN PERMISSION, AND THE CONTENTS MUST NOT BE REPRODUCED TO A THIRD PARTY NOR BE USED FOR ANY UNAUTHORIZED PURPOSE.

REV	DATE	DESCRIPTION

SURFACE WATER APPLICATION MAP	
WARRENTON SAWMILL	
PLANT or MILL WARRENTON	ACAD FILE 3823101
WILLAMETTE INDUSTRIES, INC. ENGINEERING DEPT. ALBANY, OR	
SCALE: 1"=400'	DATE: SEPT. 9, 1998
DRAWN BY: JEH	PLT: 1=480 TIME: 08:27
DRAWING: WAR-98-3823-1-01 REV. A	