

APPLICATION MAP

IN THE NAME OF JACK OR SHERI FUGATE OR BARBARA

SECTIONS 13 & 24, T 29 S, R 15 W, W.M.

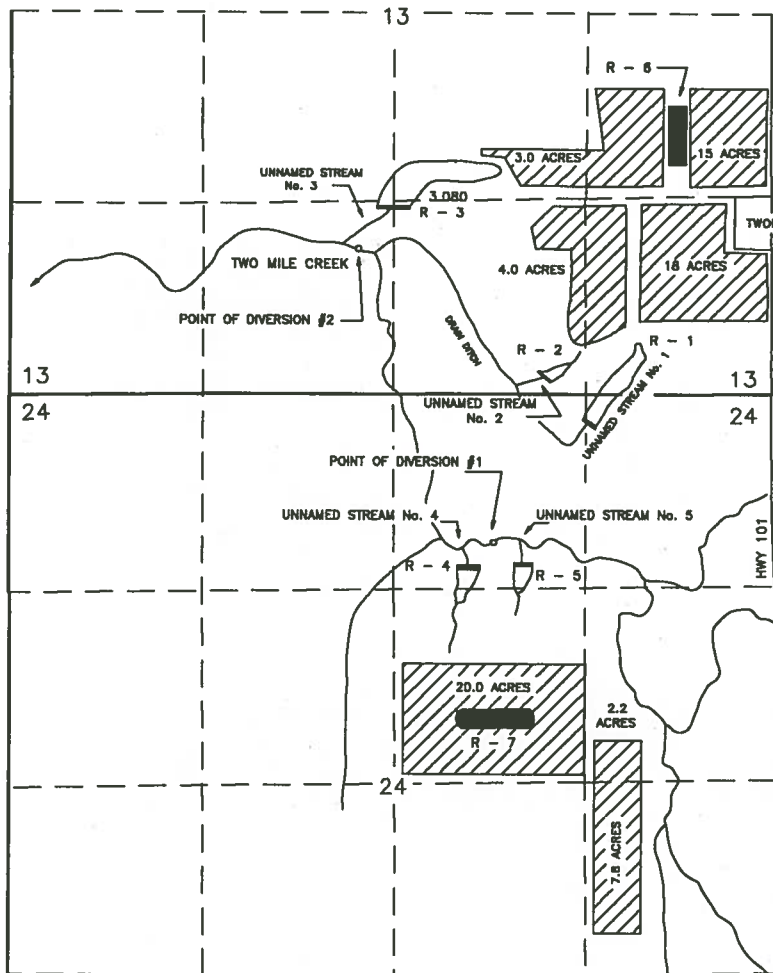

RECEIVED
 JAN 20 1994
 WATER RESOURCES DEPT.
 SALEM, OREGON

THE POINTS OF DIVERSION ARE TO BE LOCATED AS FOLLOWS:

POINT OF DIVERSION	FEET NORTH/SOUTH	FEET EAST	¼ ¼	SECTION
TWO MILE CREEK No. 1	990 SOUTH	3330 EAST	NW¼NE¼	24
TWO MILE CREEK No. 2	1030 NORTH	2380 EAST	SE¼SW¼	13
R - 1	171 SOUTH	3970 EAST	NE¼NE¼	24
R - 2 / UNNAMED STREAM No. 2	137 NORTH	3680 EAST	SW¼SE¼	13
R - 3	1310 NORTH	2620 EAST	SW¼SE¼	13
R - 4 / UNNAMED STREAM No. 4	1170 SOUTH	3150 EAST	NW¼NE¼	24
R - 5 / UNNAMED STREAM No. 5	1150 SOUTH	3520 EAST	NW¼NE¼	24
R - 6	1810 NORTH	4600 EAST	NE¼SE¼	13
R - 7	2220 SOUTH	3370 EAST	SW¼NE¼	24

ALL FROM THE SOUTHWEST CORNER OF SECTION 13 AND WITHIN TOWNSHIP 29 SOUTH, RANGE 15 WEST, W.M., COOS COUNTY.

Application No. 73857
 Permit No. 53694

THE PURPOSE OF THIS MAP IS TO IDENTIFY THE LOCATION OF THE WATER RIGHT. IT IS NOT INTENDED TO PROVIDE INFORMATION RELATIVE TO THE LOCATION OF PROPERTY OWNERSHIP BOUNDARY LINES.

