

APPLICATION MAP

IN THE NAME OF PAUL OR SANDY NORRIS



SECTIONS 29, 30, 31 & 32, T 25 S, R 6 W, W.M.

RECEIVED

MAY 27 1994

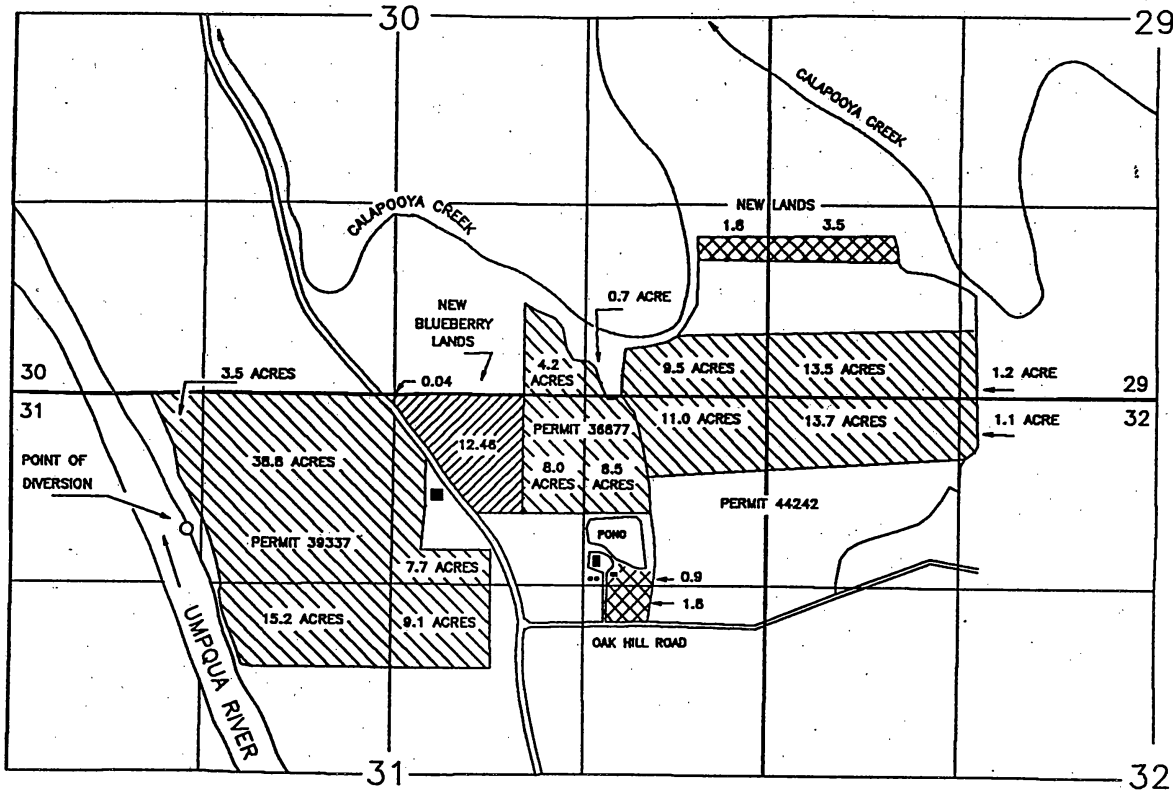
WATER RIGHTS DEPT.
SALEM, OREGON



-  ACREAGE TO RECEIVE ADDITIONAL DUTY (145.7 ACRES)
-  NEW ACREAGE @ 4.0 ACRE FOOT DUTY (12.5 ACRES)
-  NEW ACREAGE @ 2.5 ACRE FOOT DUTY (8.0 ACRES)



THE POINT OF DIVERSION IS LOCATED 900 FEET SOUTH AND 1,240 FEET EAST FROM THE NORTHWEST CORNER OF SECTION 30, BEING WITHIN THE NW¼ OF THE NW¼ OF SECTION 30, TOWNSHIP 25 SOUTH, RANGE 6 WEST, W.M., DOUGLAS COUNTY.

THE PURPOSE OF THIS MAP IS TO IDENTIFY THE LOCATION OF THE WATER RIGHT. IT IS NOT INTENDED TO PROVIDE INFORMATION RELATIVE TO THE LOCATION OF PROPERTY OWNERSHIP BOUNDARY LINES.

