

WATER RIGHT APPLICATION MAP  
T26S, R3W, WM

SCALE 1' = 400'  
DOUGLAS COUNTY

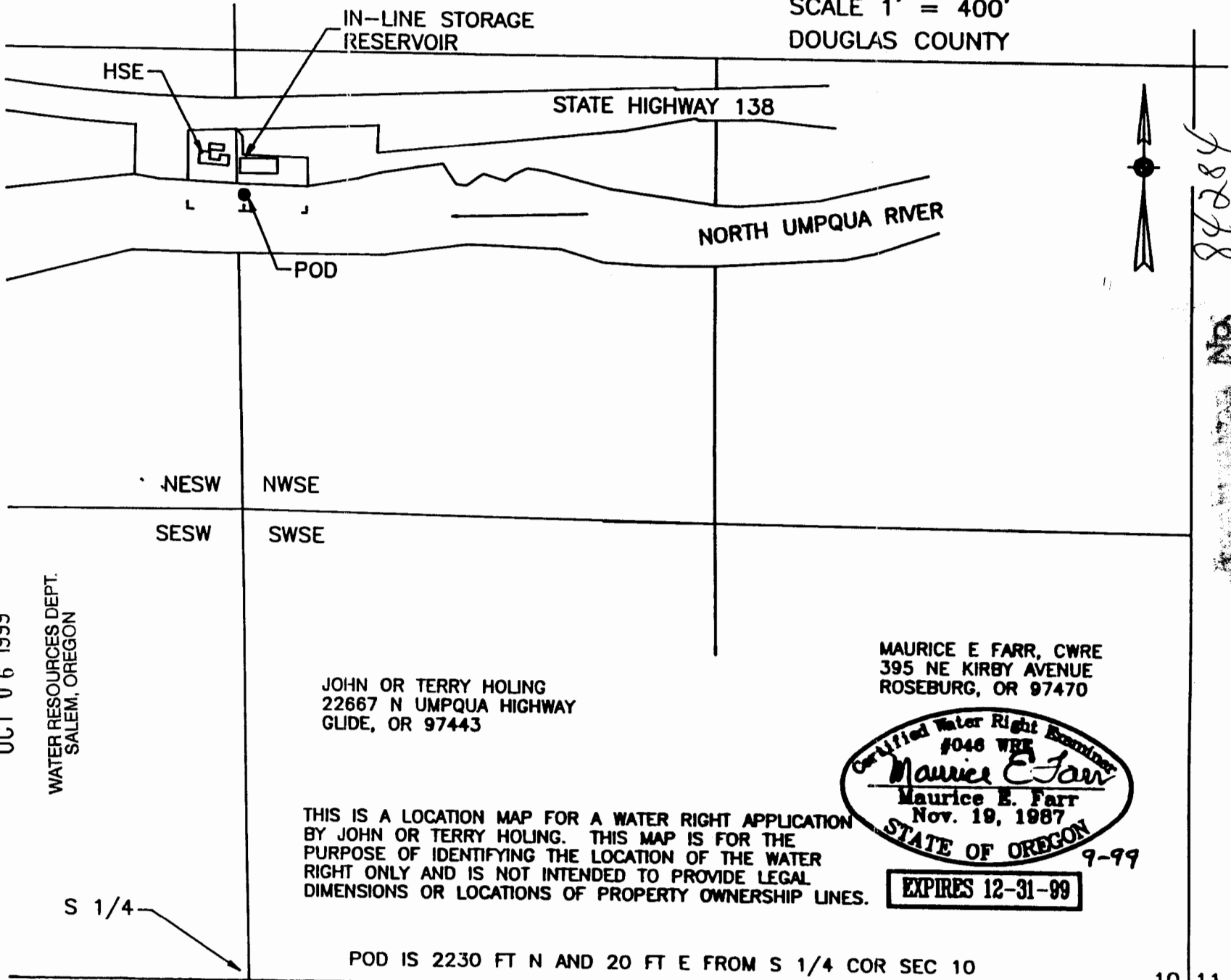

RECEIVED

OCT 06 1999

WATER RESOURCES DEPT.  
SALEM, OREGON

JOHN OR TERRY HOLING  
22667 N UMPQUA HIGHWAY  
GLIDE, OR 97443

MAURICE E FARR, CWRE  
395 NE KIRBY AVENUE  
ROSEBURG, OR 97470

Certified Water Right Examiner  
#046 WRB  
*Maurice E. Farr*  
Maurice E. Farr  
Nov. 19, 1987  
STATE OF OREGON 9-99

EXPIRES 12-31-99

THIS IS A LOCATION MAP FOR A WATER RIGHT APPLICATION BY JOHN OR TERRY HOLING. THIS MAP IS FOR THE PURPOSE OF IDENTIFYING THE LOCATION OF THE WATER RIGHT ONLY AND IS NOT INTENDED TO PROVIDE LEGAL DIMENSIONS OR LOCATIONS OF PROPERTY OWNERSHIP LINES.

POD IS 2230 FT N AND 20 FT E FROM S 1/4 COR SEC 10