

THIS MAP WAS PREPARED FOR THE PURPOSE OF IDENTIFYING THE LOCATION OF THE WATER RIGHT AND IS NOT INTENDED TO PROVIDE LEGAL DIMENSIONS OR LOCATIONS OF PROPERTY OWNERSHIP LINES.

App# S-84252
Permit# S-53775

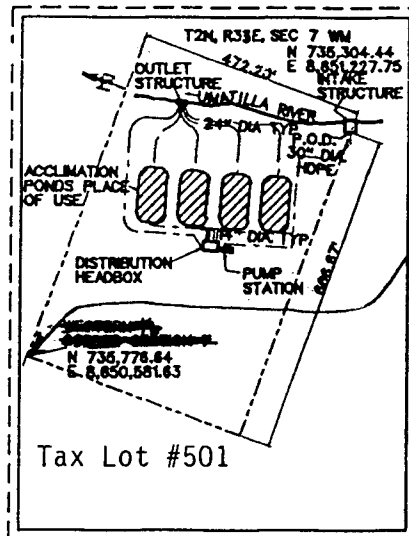

NW Corner of SW 1/4
NW 1/4 of Section 7

SITE PLAN
SCALE 1" = 400'

RECEIVED

DEC 10 2001

WATER RESOURCES DEPT.
SALEM, OREGON

RECEIVED

DEC 10 2001

WATER RESOURCES DEPT.
SALEM OREGON

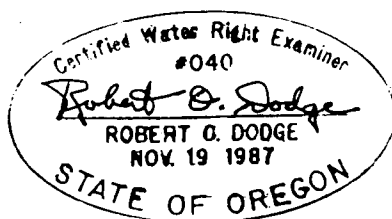

REVISIONS	DEPARTMENT of FISH & WILDLIFE STATE OF OREGON	
	UMATILLA SATELLITE AND RELEASE SITE	
	WATER RIGHTS MAP	
	CHIEF ENGINEER	
DATE: SEPTEMBER 10, 1998	APPROVED	DIRECTOR
DESIGN BY: ROD		
DRAWN BY: BJ		
CHECKED BY:	FILE NO.	SHT. 1 OF 1