

T.34S.,R.1W.,W.M.  
 Jackson County, Oregon  
 Tax Lot No. T.34S.,R.1W., Sec. 21D - 512

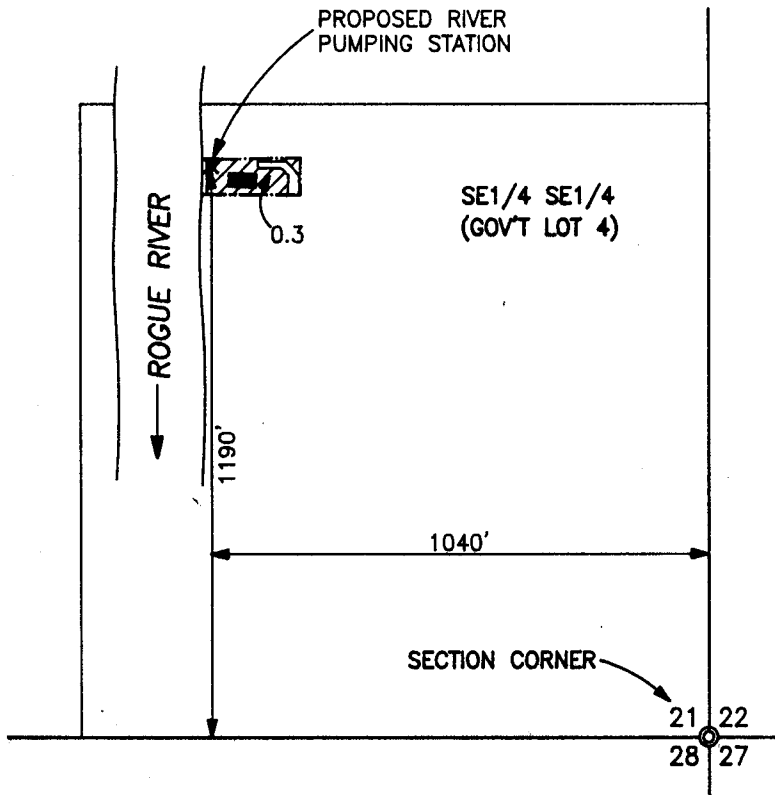

Application No. 84609  
 Permit No.

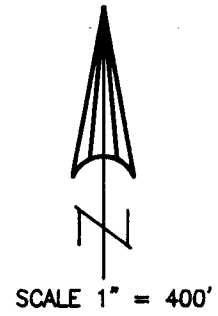
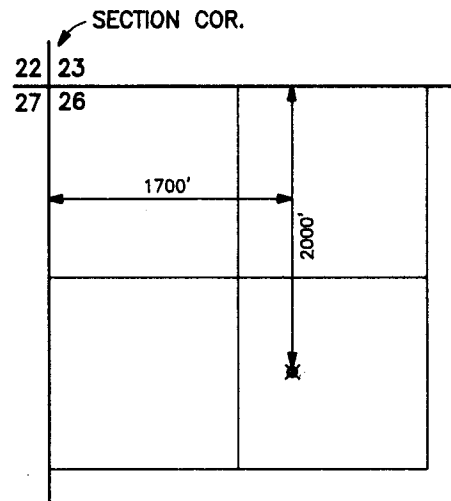

LOST CREEK RESERVIOR  
 POINT OF DIVERSION  
 T.33S.,R.1E.,W.M.  
 SCALE 1" = 1320'

MAP TO ACCOMPANY AN APPLICATION  
 FOR A PERMIT TO USE SURFACE WATER

FOR: HARRY W. SHERBOURNE  
 P.O. BOX 321  
 (20455 HWY. 62)  
 SHADY COVE, OR. 97539

NOTE: MAP PREPARED FOR  
 WATER RIGHT PURPOSES ONLY,  
 NOT FOR PROPERTY BOUNDARY  
 LOCATIONS.

PREPARED BY:  
 GARY D. KAISER  
 19440 HWY. 62  
 EAGLE POINT, OR.  
 97524

**RECEIVED**

NOV 24 2000

NOVEMBER 21, 2000

WATER RESOURCES DEPT.  
 SALEM, OREGON

