

NOV. 9 2000  
WATER RESOURCES DEPT  
SALEM, OREGON

JAN - 3 2001

WATER RESOURCES DEPT  
SALEM, OR

8 9  
17 16

2-31

Polk County

T. 7 South  
R. 4 West  
Sections 17 & 20  
W E  
S

This plan is subject to the provisions of  
Ordinance 11-2000, which provides for  
the payment of a fee for the use of  
any of the water rights shown on this  
plan. The fee is to be paid to the  
Oregon Department of Water Resources.  
112497  
WILLAMETTE VALLEY IRRIGATION CO.  
SALMON, OREGON

Application No. S8462  
Permit No. S-53800

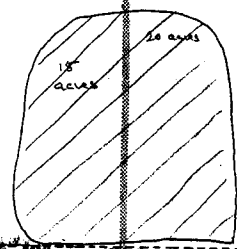

13-40

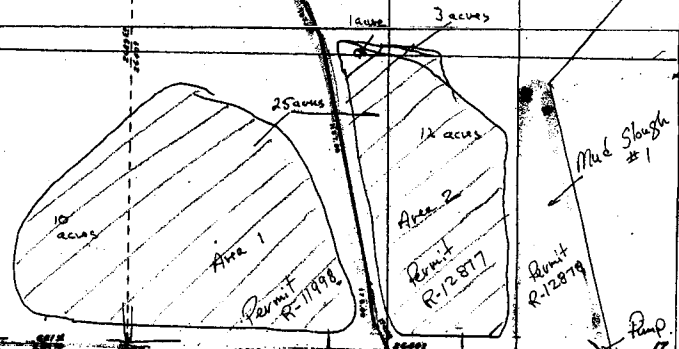

13-40

Mud Slough #1  
Area 1  
Area 2  
Major Pond Areas outlined in Blue

Pod 2-31

Pump Site  
255 ft West  
30 ft North  
of SE corner of Section 17

