

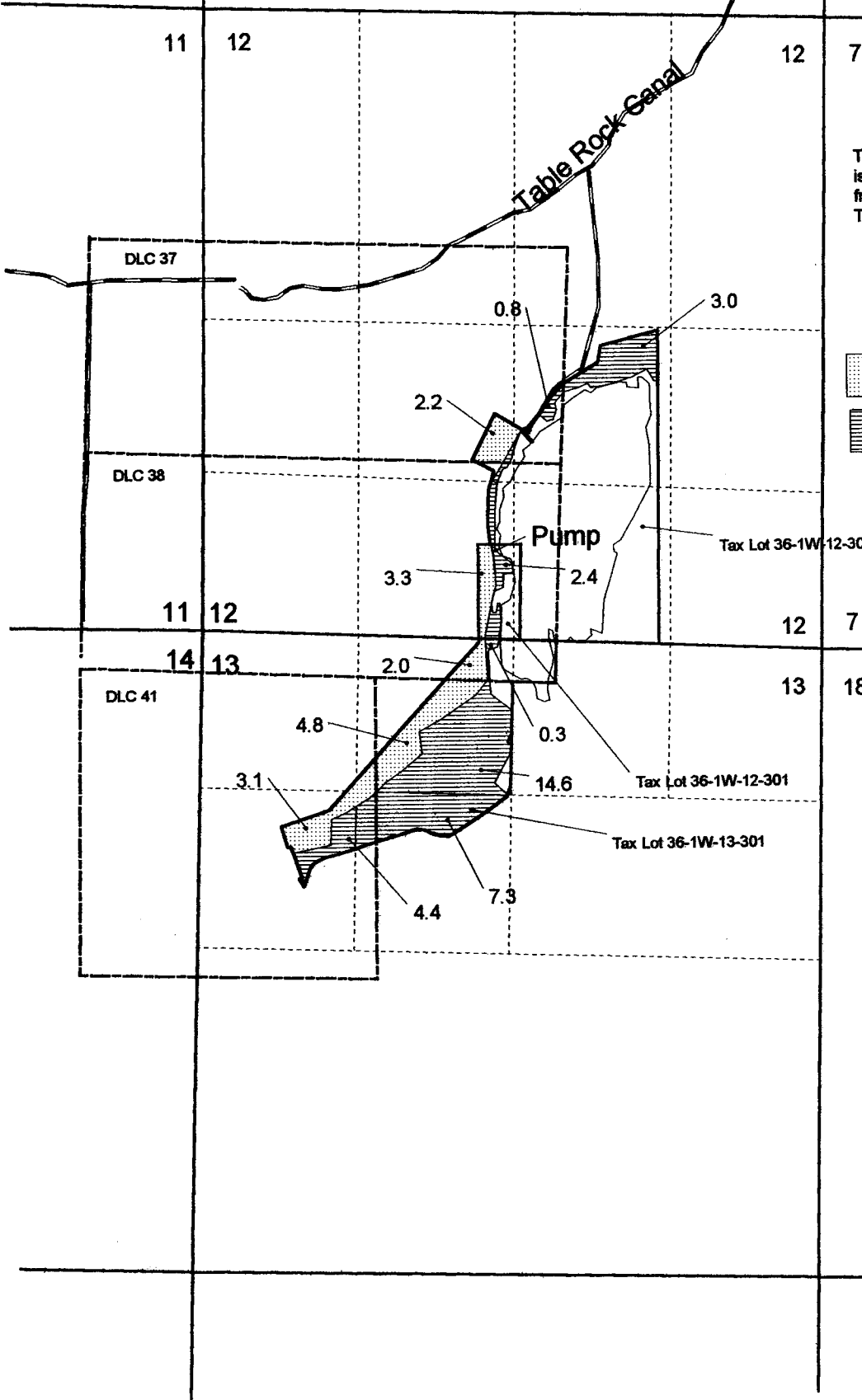

Township 36 South, Range 1 West, W.M.

Permit # 553805

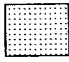

The Table Rock Canal Diversion is located 420 ft. South and 1810 ft. East from the NW Cor. of Section 6 T 36 S, R 1 W, W.M.

-  Area to receive Supplemental rights from Lost Creel This is supplemental to Cert. 65148
-  Area to receive Primary rights from Lost Creek Res



Scale 1" = 1320'

RECEIVED

APR 23 2001

WATER RESOURCES DEPT.
SALEM, OREGON