

~~MAP~~ TO ACCOMPANY AN APPLICATION
 FOR THE APPROPRIATION OF SURFACE
 WATER IN SECTION 31, T3N, R1W, W.M.
 MULTNOMAH COUNTY, OREGON, WILLAMETTE BASIN
 FOR
 DAVID AND KRISTI FAZIO
 16415 N.W. LUCY REEDER RD.
 PORTLAND, OR. 97231

PREPARED BY: A.M. KLEIN CWRE 213 (503/357-3394)
 01/25/01

MULTNOMAH CHANNEL

Application No. 84662
 Permit No. S-53809

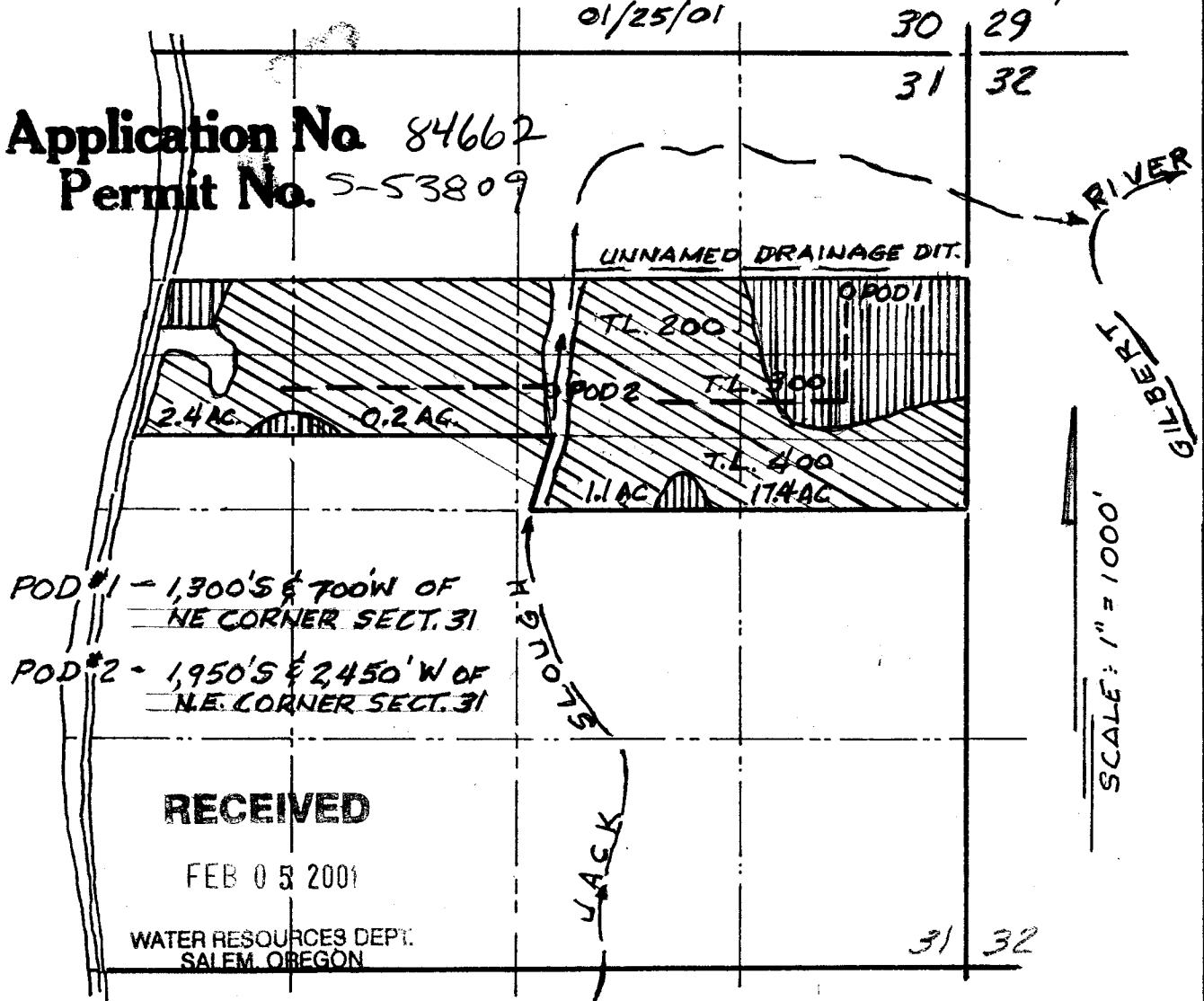

POD #1 - 1,300'S & 700'W OF
 NE CORNER SECT. 31
 POD #2 - 1,950'S & 2,450'W OF
 NE CORNER SECT. 31

RECEIVED

FEB 05 2001

WATER RESOURCES DEPT.
 SALEM, OREGON

 LANDS IRRIGATED UNDER
 PERMIT NO. 19464

 LANDS IRRIGATED UNDER
 THIS APPLICATION

6" MAINLINE
 PORTABLE
 IRRIGATION PIPE

Certified Water Right Examiner
 #213 WRE
A.M. Klein 01/25/01
 Andrew M. Klein
 May 30, 1939
 STATE OF OREGON

EXPIRES 6-30-2001