

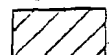

-  IRRIGATION
-  AGRICULTURAL
-  AGRICULTURAL - DEF. IN RIGHT

SECTION 28 T4S R4W W.M.
YAMHILL COUNTY
1" = 400'

SECTION 27 T4S R4W W.M.

40.2

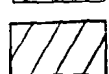

PREPARATION OF THIS MAP IS FOR THE PURPOSE OF IDENTIFYING THE LOCATION OF THE WATER RIGHT ONLY. THERE IS NO INTENT TO PROVIDE DIMENSIONS OR LOCATION OF PROPERTY OWNERSHIP LINES.

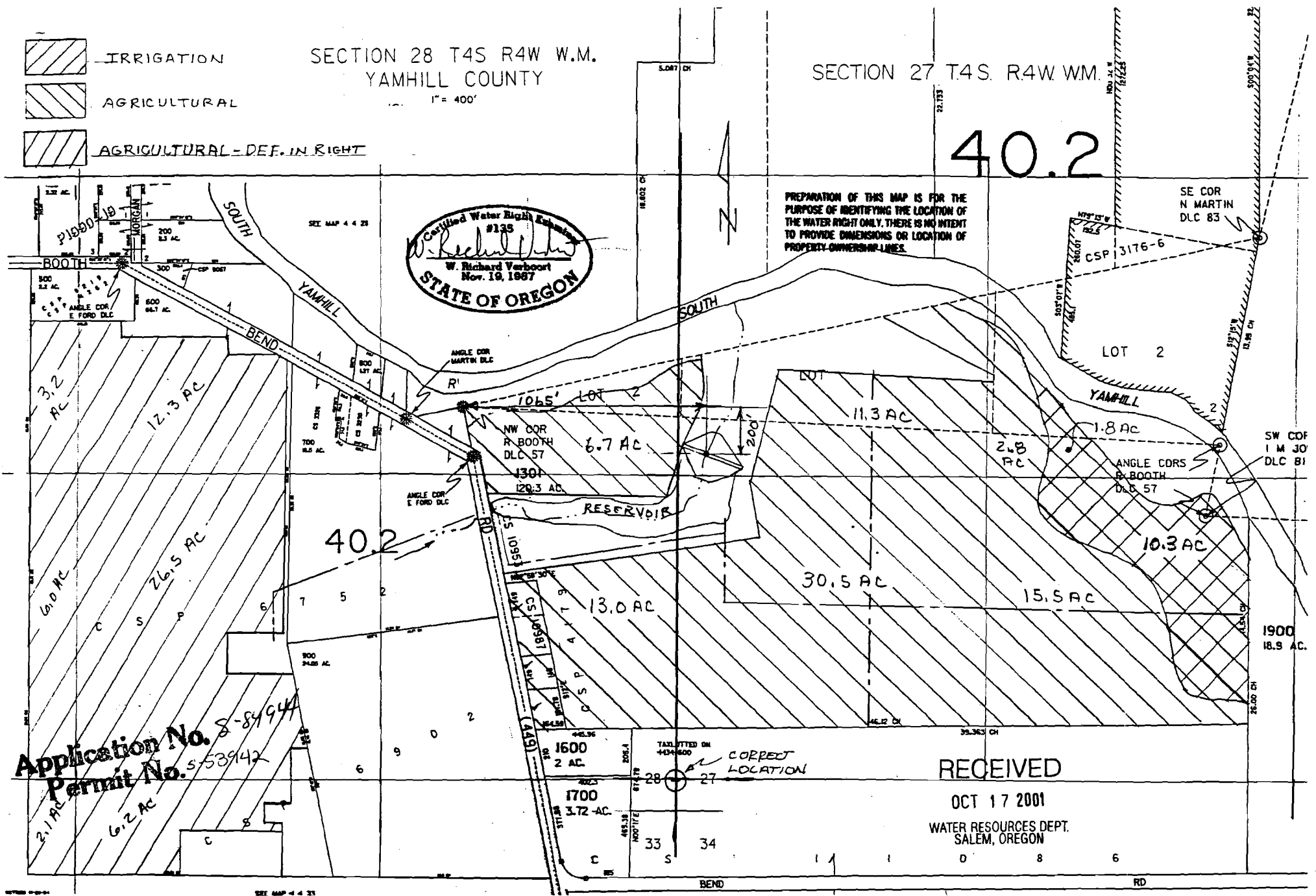

Application No. S-84944
Permit No. S-53942

RECEIVED
OCT 17 2001
WATER RESOURCES DEPT.
SALEM, OREGON

OREGON PRIDE NURSERIES, INC
5380 S.E. BOOTH BEND ROAD
MCMINNVILLE, OR 97128

designed by RV date 7-30-01
drawn by RV date 7-30-01
checked by RV date 7-30-01
drawing no. 01-B-10
sheet no. 1/1

VERBOORT ENGINEERING
AGRICULTURE • CIVIL • WATER RESOURCES
HILLSBORO, OREGON