

RECEIVED

APPLICATION MAP

APR 03 2000

IN THE NAME OF CARTER AND SEEHAWER **WATER RESOURCES DEPT.
SALEM, OREGON**

SECTIONS 14, 15, 22 & 23, T. 27 S., R. 4 W., W.M.

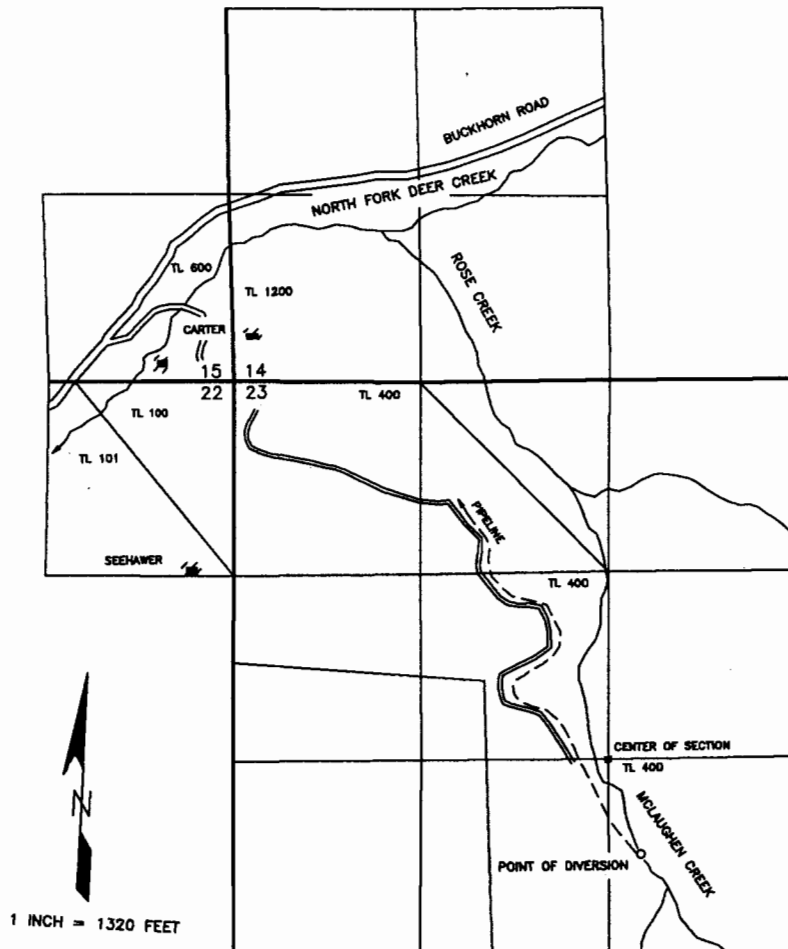

Application No. ^{S-}84405
Permit No. S-53996

THE POINT OF DIVERSION IS TO BE LOCATED 650 FEET SOUTH AND 220 FEET EAST FROM THE CENTER CORNER OF SECTION 23, BEING WITHIN THE NW¹/₄SE¹/₄ OF SECTION 23; TOWNSHIP 27 SOUTH; RANGE 4 WEST, W.M.; DOUGLAS COUNTY.

THE PURPOSE OF THIS MAP IS TO IDENTIFY THE LOCATION OF THE WATER RIGHT.
IT IS NOT INTENDED TO PROVIDE INFORMATION RELATIVE TO THE LOCATION OF
PROPERTY OWNERSHIP BOUNDARY LINES.