

**APPLICATION FOR A PERMIT TO APPROPRIATE GROUND WATER
AND
APPLICATION FOR A PERMIT TO APPROPRIATE STORAGE
IN THE NAME OF OCEAN SPRAY CRANBERRIES, INC.**

RECEIVED
SEP 17 2001
WATER RESOURCES DEPT.
SALEM, OREGON

SECTIONS 4, 5, 6, 8 & 9; TOWNSHIP 29 SOUTH, RANGE 14 WEST, W.M.
AND
SECTION 1, TOWNSHIP 29 SOUTH, RANGE 15 WEST, W.M.

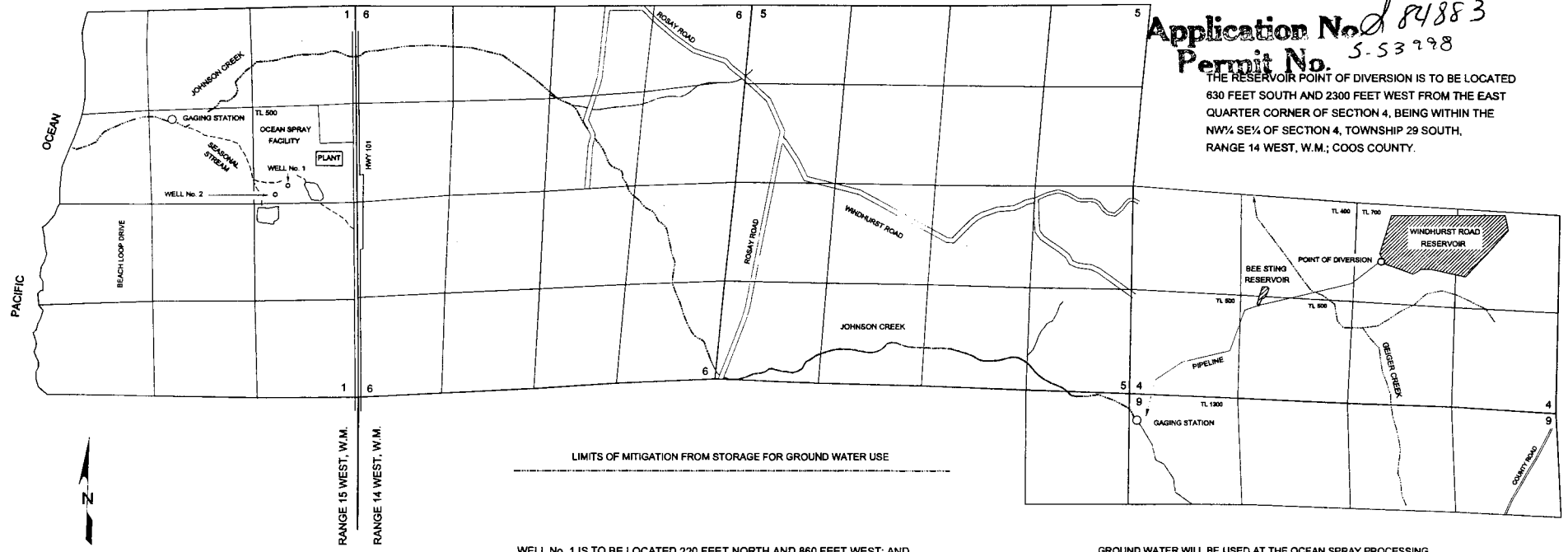

Application No. 84883
Permit No. 5-53298

THE RESERVOIR POINT OF DIVERSION IS TO BE LOCATED 630 FEET SOUTH AND 2300 FEET WEST FROM THE EAST QUARTER CORNER OF SECTION 4, BEING WITHIN THE NW¼ SE¼ OF SECTION 4, TOWNSHIP 29 SOUTH, RANGE 14 WEST, W.M.; COOS COUNTY.

LIMITS OF MITIGATION FROM STORAGE FOR GROUND WATER USE

WELL No. 1 IS TO BE LOCATED 220 FEET NORTH AND 860 FEET WEST; AND WELL No. 2 IS TO BE LOCATED 100 FEET NORTH AND 1020 FEET WEST, BOTH FROM THE EAST QUARTER CORNER OF SECTION 1, BEING WITHIN THE SE¼ NE¼ OF SECTION 1, TOWNSHIP 29 SOUTH, RANGE 15 WEST, W.M.; COOS COUNTY.

GROUND WATER WILL BE USED AT THE OCEAN SPRAY PROCESSING PLANT DURING THE CRANBERRY HARVEST SEASON. INITIAL MITIGATION FOR USE OF THE GROUND WATER WILL BE STORAGE RELEASES INTO JOHNSON CREEK FROM THE WINDHURST ROAD RESERVOIR.



THE PURPOSE OF THIS MAP IS TO IDENTIFY THE LOCATION OF THE WATER RIGHT. IT IS NOT INTENDED TO PROVIDE INFORMATION RELATIVE TO THE LOCATION OF PROPERTY OWNERSHIP BOUNDARY LINES.