

T.35S.,R.1W.,W.M.  
 Jackson County, Oregon  
 Tax Lot No. 351W 5-2000

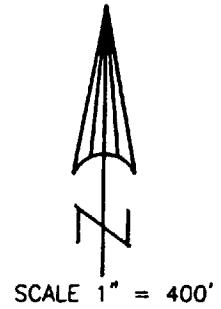

**Application No.** 184730  
**Permit No.**

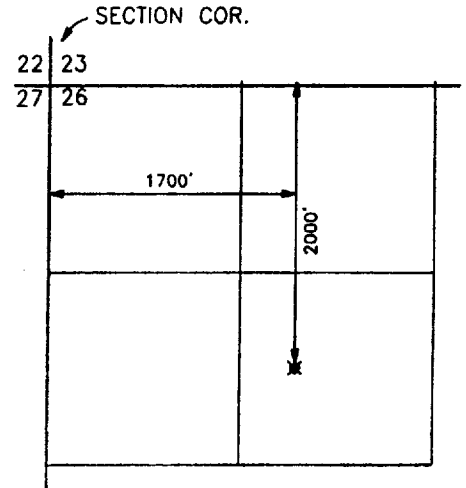
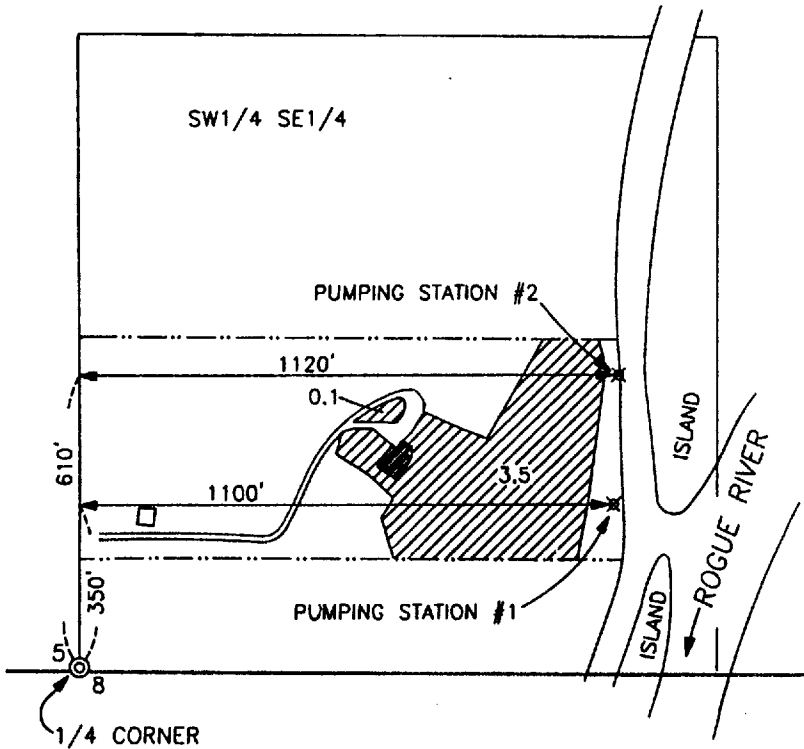

LOST CREEK RESERVIOR  
 POINT OF DIVERSION  
 T.33S.,R.1E.,W.M.  
 SCALE 1" = 1320'

MAP TO ACCOMPANY AN APPLICATION  
 TO APPROPRIATE SURFACE WATER

FOR: *PEAK FAMILY TRUST*  
 1800 ROGUE RIVER DR.  
 EAGLE POINT, OR. 97524

PREPARED BY:  
 GARY D. KAISER  
 19440 HWY. 62  
 EAGLE POINT, OR.  
 97524

JANUARY 26, 2001

NOTE: MAP PREPARED FOR  
 WATER RIGHT PURPOSES ONLY,  
 NOT FOR PROPERTY BOUNDARY  
 LOCATIONS.

**RECEIVED**

APR 04 2001

WATER RESOURCES DEPT.  
 SALEM, OREGON



**RECEIVED**

APR 23 2001

WATER RESOURCES DEPT.  
 SALEM, OREGON