

**T8S & T9S R3W WM**  
**MARION COUNTY**

SEP 29 2003

WATER RIGHT UNIT  
 2003-000

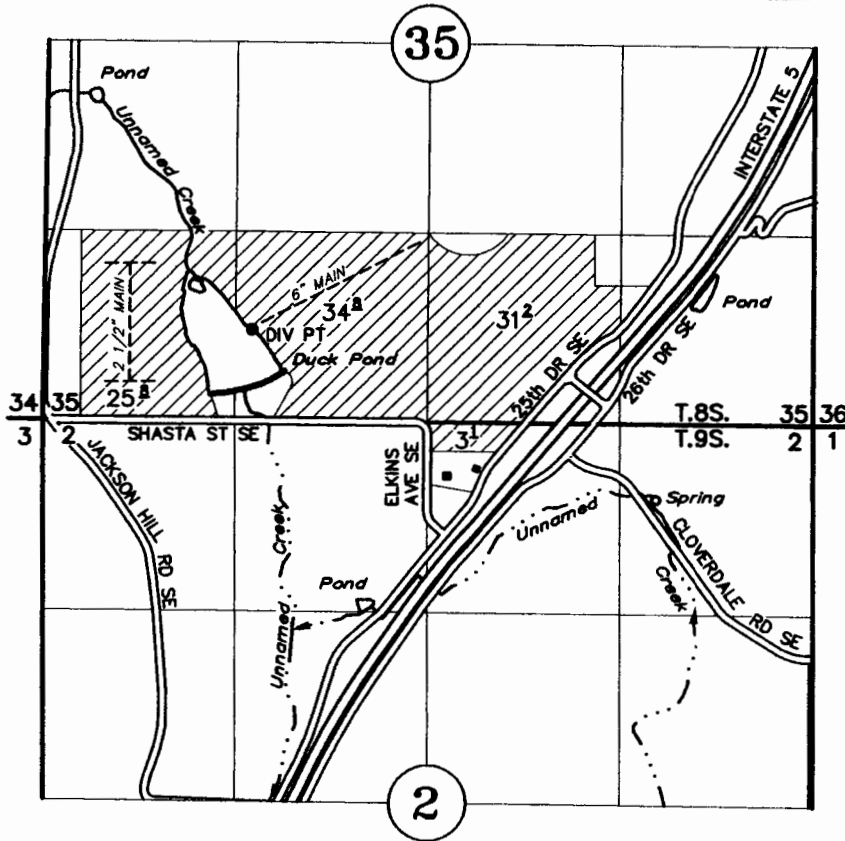

TAX LOT:  
 8 3W 35 800

DIV PT: 635' NORTH AND 1430' EAST OF SW CORNER OF SECTION 35

**APPLICATION TO APPROPRIATE SURFACE WATER**

|                                |                  |                       |
|--------------------------------|------------------|-----------------------|
| R-79850 (HB 2153)              | N/A              | 71621                 |
| S-83907                        | S-53601          | -                     |
| R-83906                        | R-12732          | -                     |
| Application No. <u>5-85817</u> | Permit No. _____ | Certificate No. _____ |

**EGM, LLC**

MARCH 31, 2003  
 SCALE 1" = 1320'

NOTE: This map is for the purpose of identifying the location of water rights and has not intent to dimension or locate property ownership lines.



EXPIRES 12-31-03