

# APPLICATION MAP TO APPROPRIATE SURFACE WATER AND STORAGE IN THE NAME OF DAVID REIGEL

## GALESVILLE DIVERSION

**SECTION 28, TOWNSHIP 31 SOUTH, RANGE 4 WEST, W.M.**

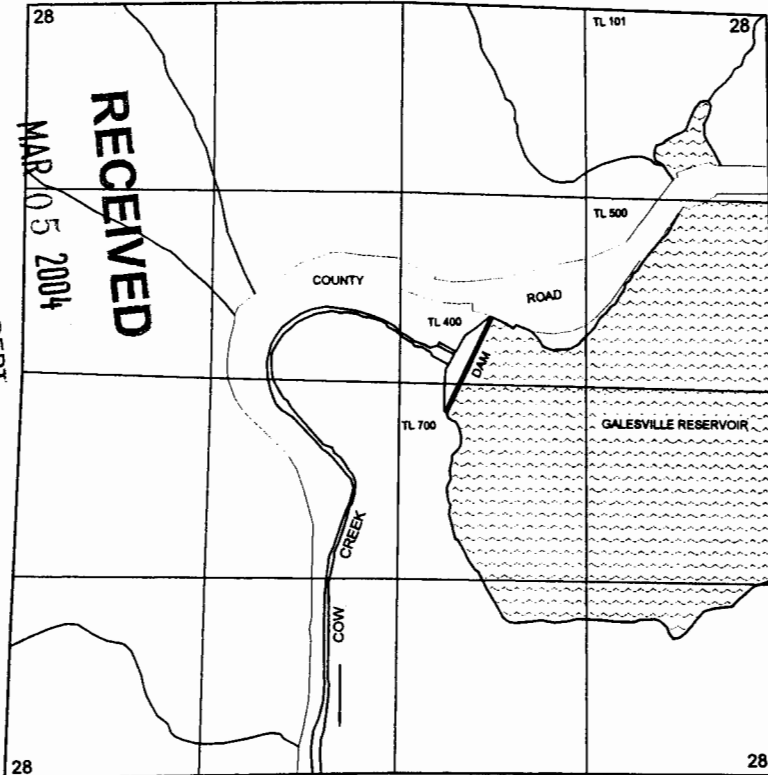

THE GALESVILLE RESERVOIR DIVERSION IS LOCATED 180 FEET NORTH AND 3030 FEET EAST FROM THE WEST QUARTER CORNER OF SECTION 28; BEING WITHIN THE SW¼ NE¼ OF SECTION 28, TOWNSHIP 31 SOUTH, RANGE 4 WEST, W.M.

THE PURPOSE OF THIS MAP IS TO IDENTIFY THE LOCATION OF THE WATER RIGHT. IT IS NOT INTENDED TO PROVIDE INFORMATION RELATIVE TO THE LOCATION OF PROPERTY OWNERSHIP BOUNDARY LINES.



1 INCH = 1320 FEET

## UMPQUA RIVER DIVERSION AND PLACE OF USE

**SECTION 30, TOWNSHIP 24 SOUTH, RANGE 7 WEST, W.M.**

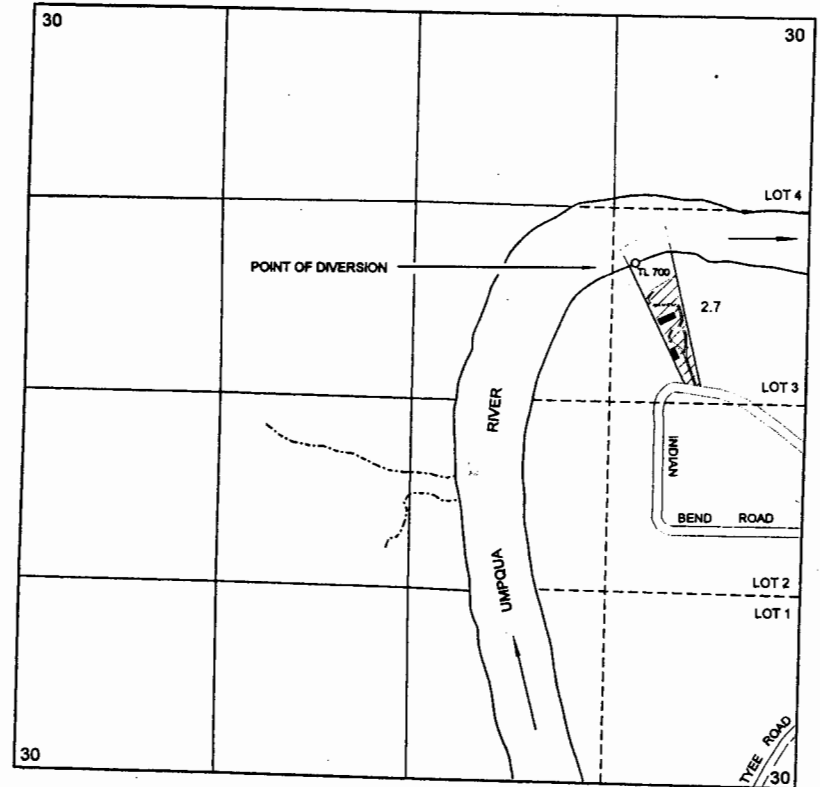

THE PROPOSED POINT OF DIVERSION IS TO BE LOCATED 965 FEET NORTH AND 1175 FEET WEST FROM THE EAST QUARTER CORNER OF SECTION 30; BEING WITHIN THE SE¼ NE¼ (LOT 3) OF SECTION 30, TOWNSHIP 24 SOUTH, RANGE 7 WEST, W.M.

Permit # 54105

App Nos 85959