

5-61849 → S-61849

T. 9 S, R. 45 E, W. M.

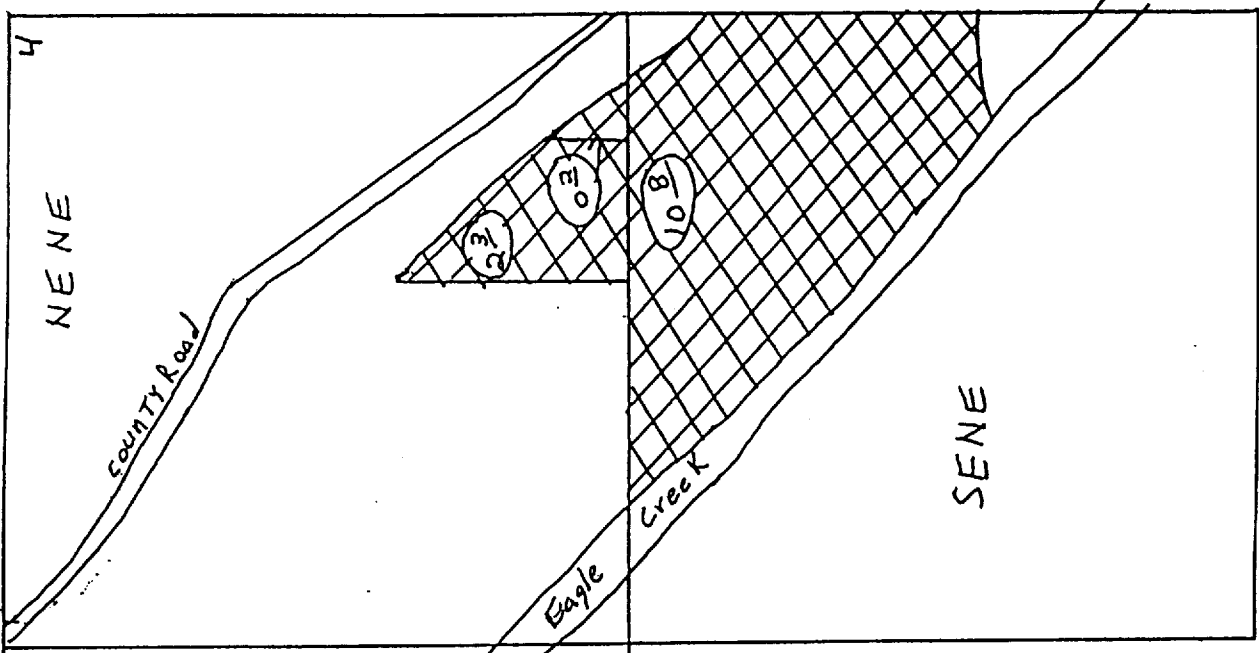

**RECEIVED**  
 JUN 21 2004  
 WATER RESOURCES DEPT  
 SALEM, OREGON

Scale 1" = 400'

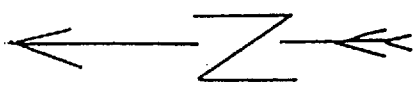

Amended  
 Application Map For  
 Eagle Valley Irr. Co.  
 attn: Eldon Deardorff  
 44256 Eagle Creek Road  
 Richland, OR 97870

T. 85, R. 45 E, W. M.

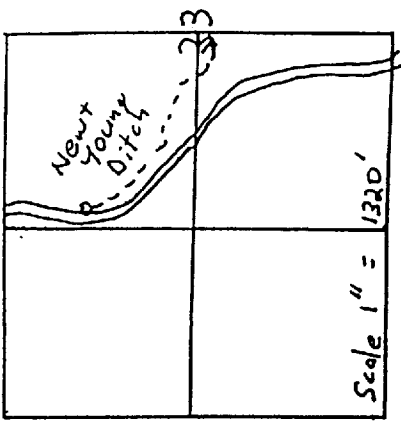

Div Pt located 1950'S & 1400'E  
 From NW cor. Sec. 33, T. 85, R. 45 E, W. M.  
 From Eagle Creek within the  
 SE NW Sec 33, T. 85, R. 45 E, W. M.

T. 6 S, R. 44 E, W. M.

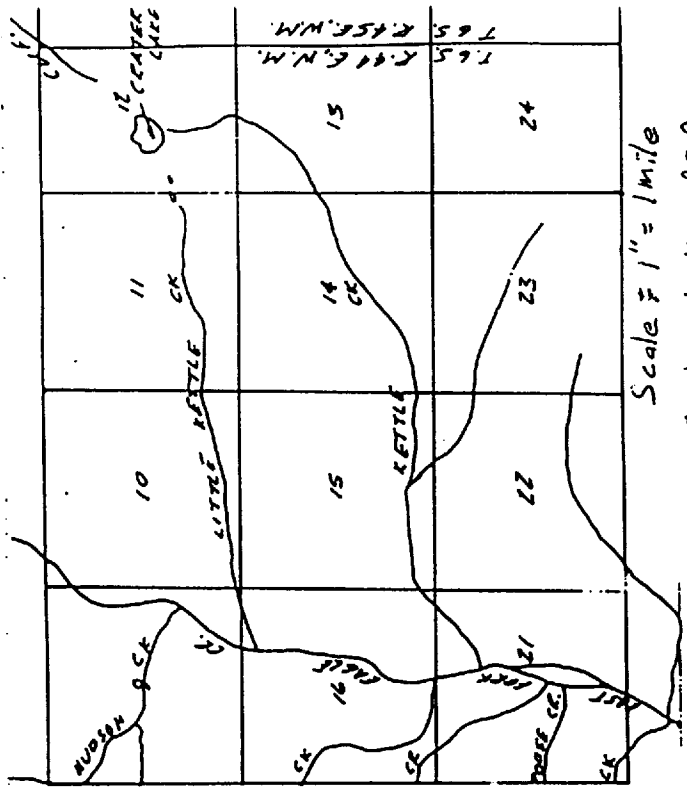

Scale 1" = 1 mile

Location of Proposed  
 Place of use under  
 application # S-61849

Crater Lake P00  
 1245' N & 1590' E from  
 the SW corner of Section  
 13, within the SESW Sec 12  
 T. 6 S, R. 44 E, W. M.