

Bud. Combe

T.37S., R.6W., W.M.

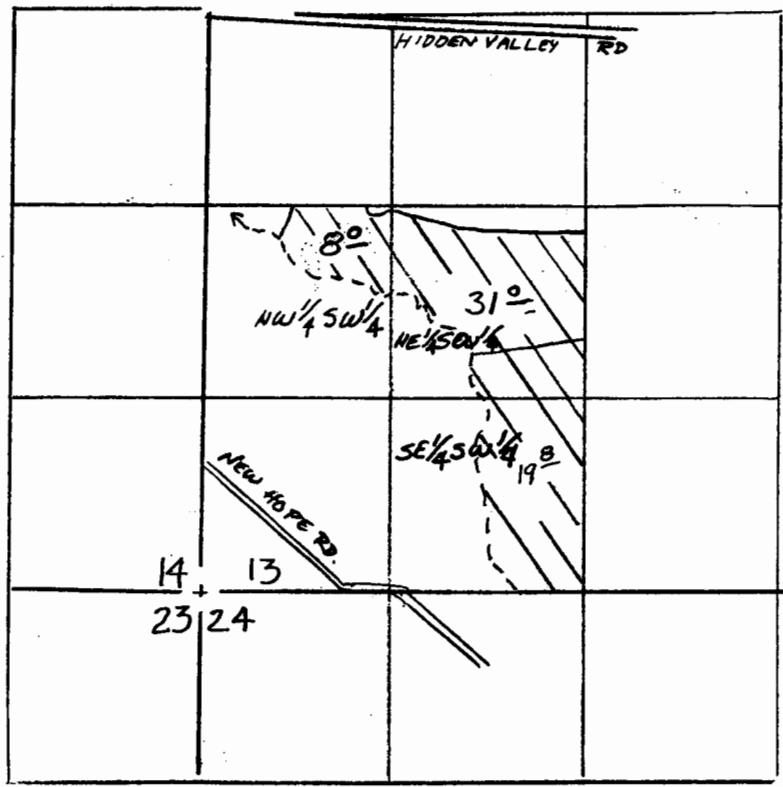

SCALE 4" = 1 MILE

Permit no. 54126  
 App no. S-85923

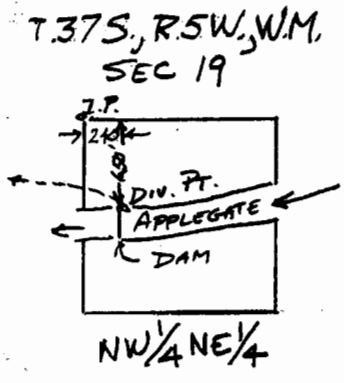

APPLICATION FOR:

CLYDE C. & D. BUD COMBE  
 APPLEGATE RESERVOIR STORED WATER

RECEIVED

JAN 28 2004

WATER RESOURCES DEPT  
 SALEM, OREGON