

**T.24S., R.13W., W.M.
SECTION 10
MAP TO STORE WATER IN A RESERVOIR
COOS BAY LUMBER
TAX LOTS 708 & 900
MAP NO. 241310
COOS COUNTY, OREGON
JULY 26, 2004**

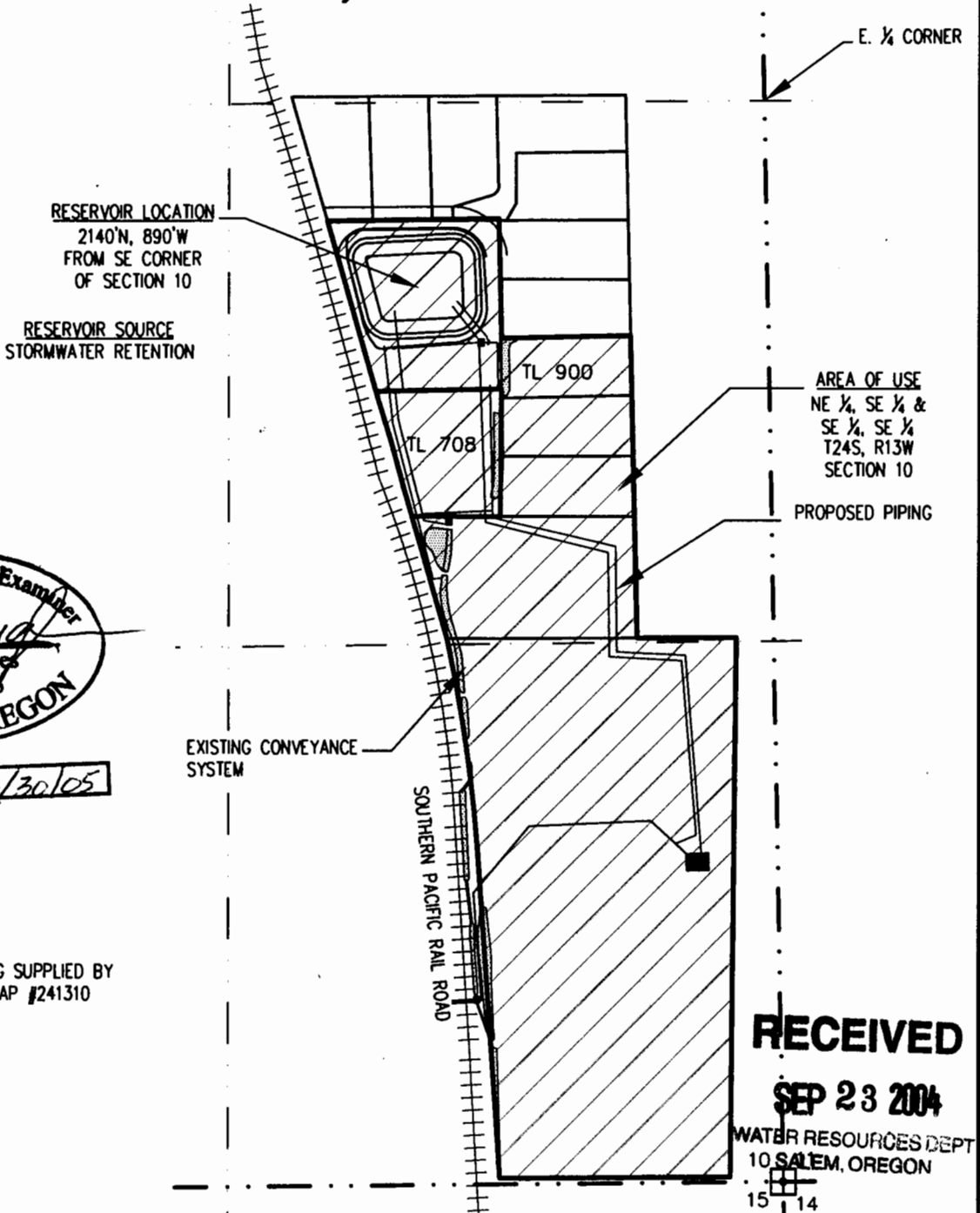

EXPIRATION DATE: 6/30/05

BASE MAPPING SUPPLIED BY
 ASSESSORS MAP #241310
 SCALE: 1" = 400'

RECEIVED
SEP 23 2004
 WATER RESOURCES DEPT
 10 SALEM, OREGON
 15 14

THIS MAP IS FOR THE PURPOSE OF LOCATING A WATER RIGHT AND IS NOT INTENDED TO PROVIDE LEGAL DIMENSIONS FOR LOCATION OF PROPERTY BOUNDARIES.

EGR & Associates, Inc.
 Engineers and Geologists
 2535B Prairie Road Eugene, Oregon 97402 (541) 688-8322
 Fax (541) 688-8087

C:\5297-00-0141\Coos Bay Lumber - Durwood\Water Rights\WaterRightMap.dwg Sep 17, 2004 - 8:14am LAYOUT=RESERVOIR MAP