

RECEIVED

JUN 26 2000

WATER RESOURCES DEPT.  
SALEM, OREGON

JUN 06 2000

RECEIVED

SEE MAP 13 5 24

80' each

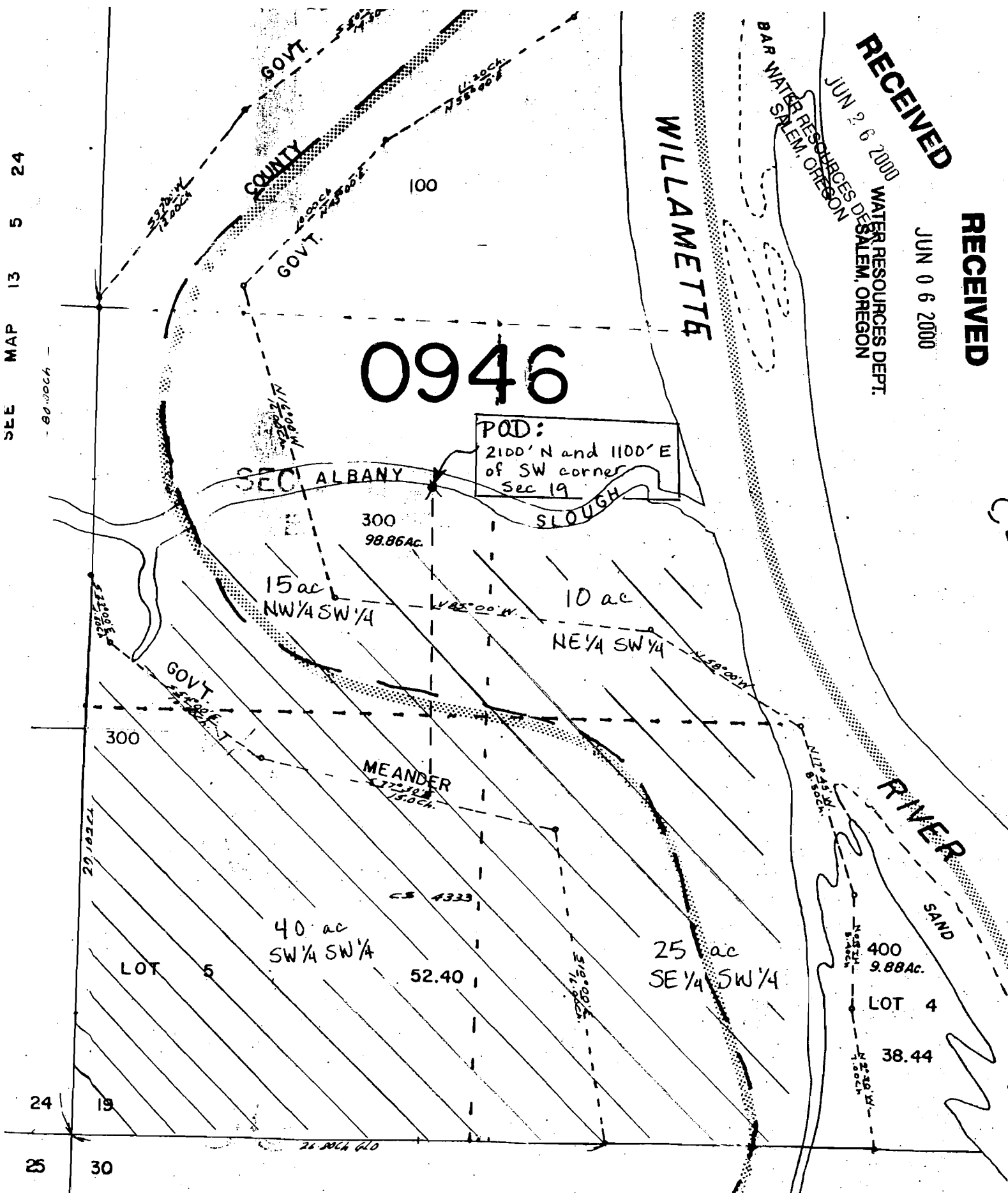

0946

POD:  
2100' N and 1100' E  
of SW corner  
Sec 19

SEC 19 ALBANY

SLOUGH

RIVER SAND

300

300  
98.86 ac

15 ac  
NW 1/4 SW 1/4

10 ac  
NE 1/4 SW 1/4

GOVT.

MEANDER  
375.00  
175.00 ch.

CS 4333

40 ac  
SW 1/4 SW 1/4

25 ac  
SE 1/4 SW 1/4

400  
9.88 ac

LOT 4

38.44

LOT 5

52.40

24

19

25

30

26.80 ch 610

--- 1/4 - 1/4 Sec Boundaries

T13S R4W Sec 19 TL 300  
 AN  
 Scale: 1" = 400'  
 --- Mainline

SEE MAP 13 4 30

Application No.  
 Permit No. 84470