

WORK
COPY

T11S, R4W, W.M.

RECEIVED

JUN 14 2004

WATER RESOURCES DEPT
SALEM, OREGON

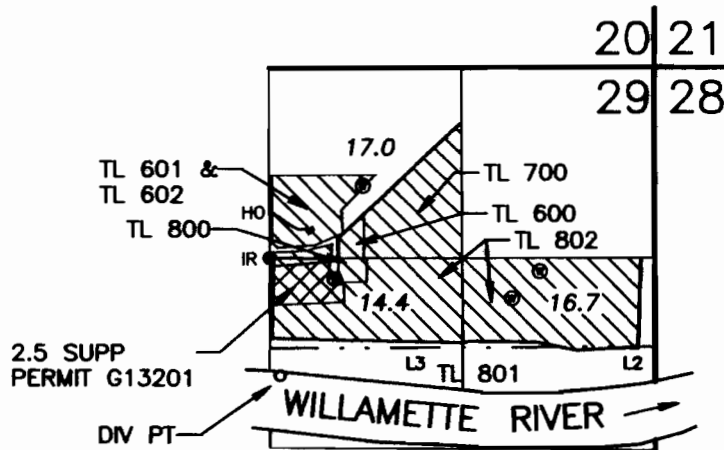

DIV PT: SOUTH 780 FT & EAST 60 FT FROM ^{cn} 1/16 CORNER SECTION 29, T11S, R4W, W.M. IN THE SW1/4 NE1/4 (LOT 3) SECTION 29.

TAX MAP 11-4-29
TL 600, 700, & 800 CURRENTLY OWNED BY MARCHAL. APPLICATION IS WITH PERMISSION

⊙ EXISTING WELL

GROUND WATER REGISTRATION GR-3639, CERTIFICATE GR-4136, 24.0 ACRES IN THE SW1/4 NE1/4 (LOT 3) AND SE1/4 NE1/4 (LOT 2) ARE NOT SHOWN.

APPLICATION MAP
FOR
SURFACE WATER

1" = 1320'

IN THE NAME OF
OREGON STATE BOARD OF HIGHER EDUCATION,
OREGON STATE UNIVERSITY,
OSU COLLEGE FORESTS

Prepared May 5, 2004
PARSONS SURVEYING
1915 S.E. Stone St.
Corvallis, OR 97333
(503) 752-7515
Project No. 0406

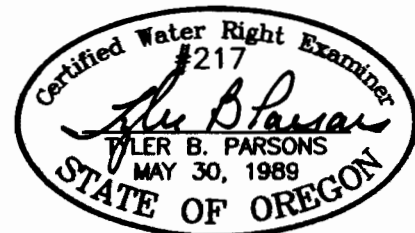

EXP: 12/31/2004

This map is for location of Water Right Application only and does not constitute a boundary survey.