

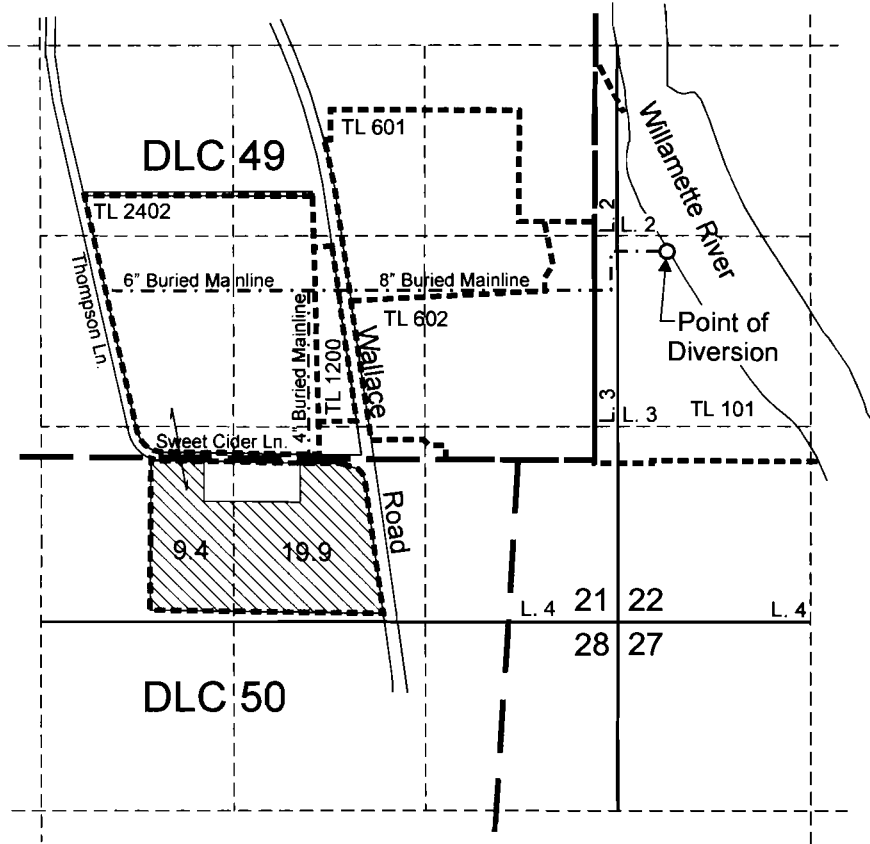

T.4S. R.3W. Sec. 21 & 22



Point of diversion is located 1,440 feet north and 500 feet east from the SE corner of DLC 49

 Area (29.3 Acres) proposed for supplemental irrigation from stored water

 Tax Lot boundary

RECEIVED

JAN 27 2005

WATER DEPARTMENT
SALEM, OREGON

app # S-86157

Scale: 1" = 1,320'

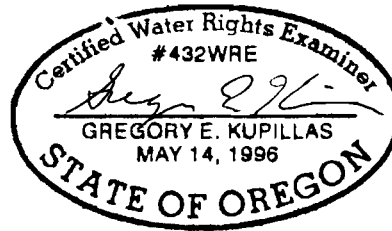

EXPIRATION DATE: 6/30/04

This map was prepared for the purpose of identifying the location of a water right only and is not intended to provide legal dimensions or location of property ownership lines.



Water Right Application Map

Carlton Nursery Company LLC
T.4S. R.3W. Sec. 21 and 22
(Dayton-3/Currie)

Pacific Hydro-Geology Inc.

12/2004