

Surface water right Application for
Cliff Curry

RECEIVED

OCT 12 2005

WATER RESOURCES DEPT
SALEM, OREGON

RECEIVED

AUG 08 2005

WATER RESOURCES DEPT
SALEM, OREGON

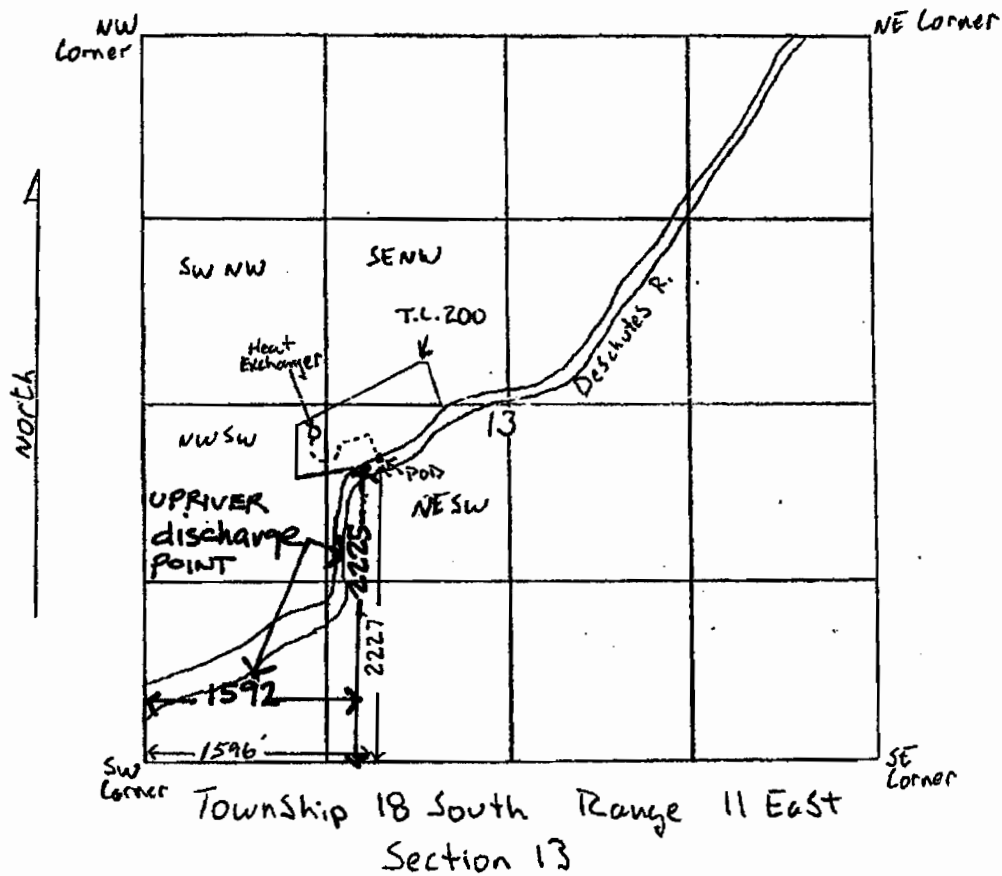

Scale - 1" = 1320'

POD - 2227' north & 1596' East of the SW Corner of Section 13
Township 18 South Range 11 East, W.M.

App No S 86392
Permit No