

# T.6S. R.1E. Sec. 27, 33 & 34, W.M.

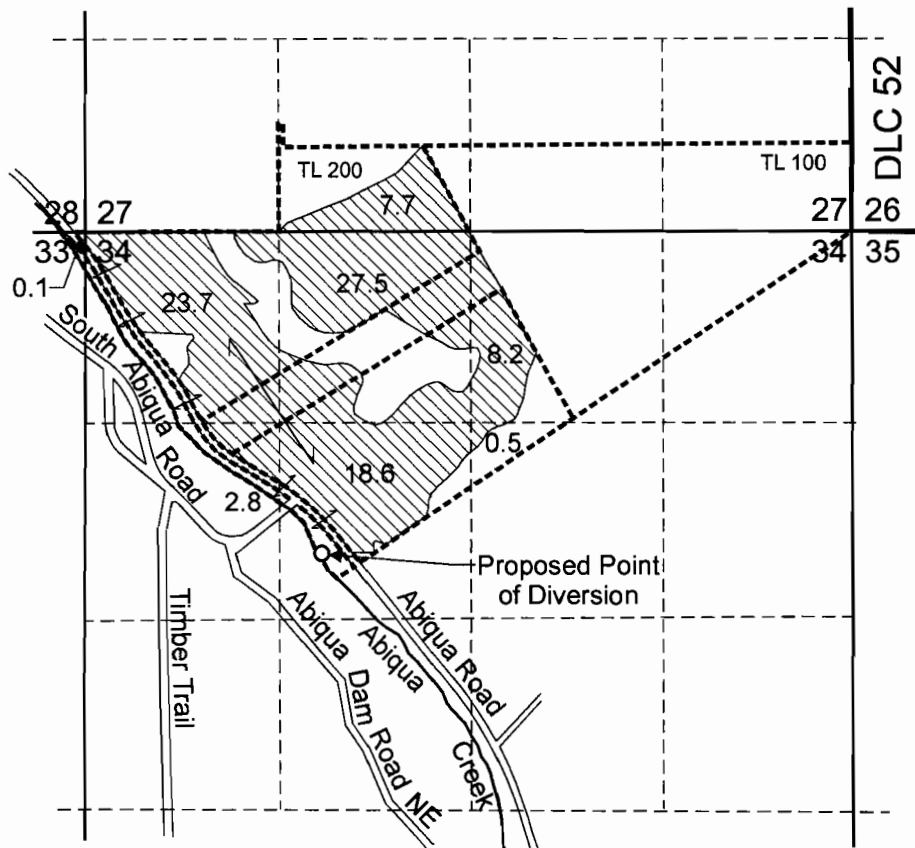

Proposed Point of Diversion is located 2,220 feet south and 1,610 feet east from the NW corner, Section 34.

Area (89.1 Acres) to be irrigated.

Tax lot boundary

Application S-86403

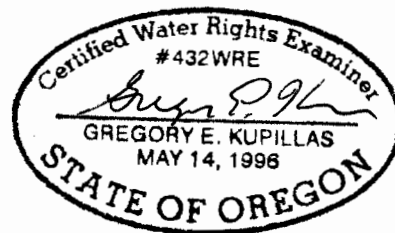

EXPIRATION DATE: 6/30/07

**RECEIVED**

**AUG 25 2005**

WATER RESOURCES DEPT  
SALEM, OREGON

Scale: 1" = 1,320'



This map was prepared for the purpose of identifying the location of a water right only and is not intended to provide legal dimensions or location of property ownership lines.



Water Right Application Map

Paul Kraemer  
T.6S. R.1E. Sec. 27, 33, and 34, W.M.

Pacific Hydro-Geology Inc.

5/2005

PKraemerHmSWApp.cdr

app no S-86403 Permit no