

T. 7S., R. 38E., W.M.

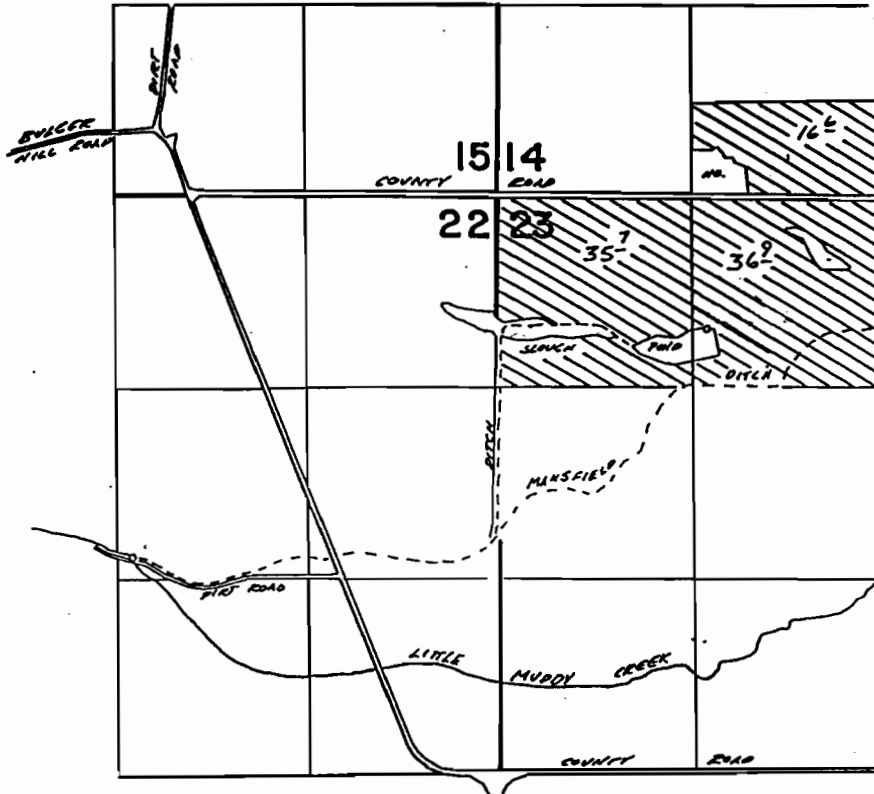

T.L.
4000

DIV. PT. LOCATED 890'S. & 1400'E. FROM NW COR. SEC. 23

SCALE: 4" = 1 MILE

APPLICATION MAP FOR USE OF STORAGE FROM STEPHENS
FAMILY POND & RESERVOIR

RICHARD D. STEPHENS
14400 NO ROCK CR LANE
HAINES, OR 97833

APRIL 4, 2006

RECEIVED
 APR 07 2006
 WATER RESOURCES DEPT
 SALEM, OREGON

2312

appno 5-86572