

WORK COPY

T.3S., R.1W., W.M.

RECEIVED

NOV 30 2005

WATER RESOURCES DEPT
SALEM, OREGON

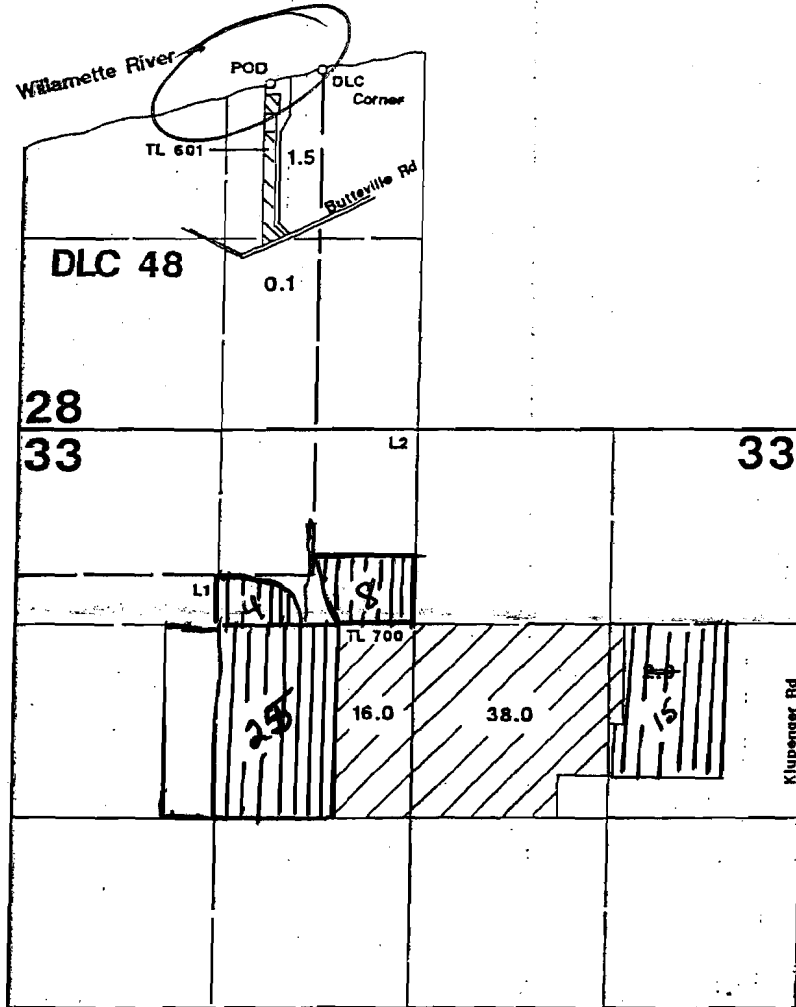

1" = 1320'

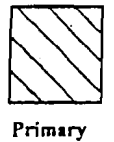

Area Irrigated



POD is located 100'N & 8'E from a point located S74° 29' 20"W 426.29' from NE corner DLC 48.

Final Proof Survey

In Name Of

Klupenger Nursery

Application #: S-80145

Permit #: 52747

Surveyed on September 15, 2000 by JM Schuette

*Applying
for Supplemental
Stored Water*

This Map Was Prepared For The Purpose Of Identifying The Location Of A Water Right Only And Is Not Intended To Provide Legal Dimensions Or Location Of Property Ownership Lines.

app no S-86490

