

T.3&4N, R. 30E., W.M. Umatilla Co. Basin 7.

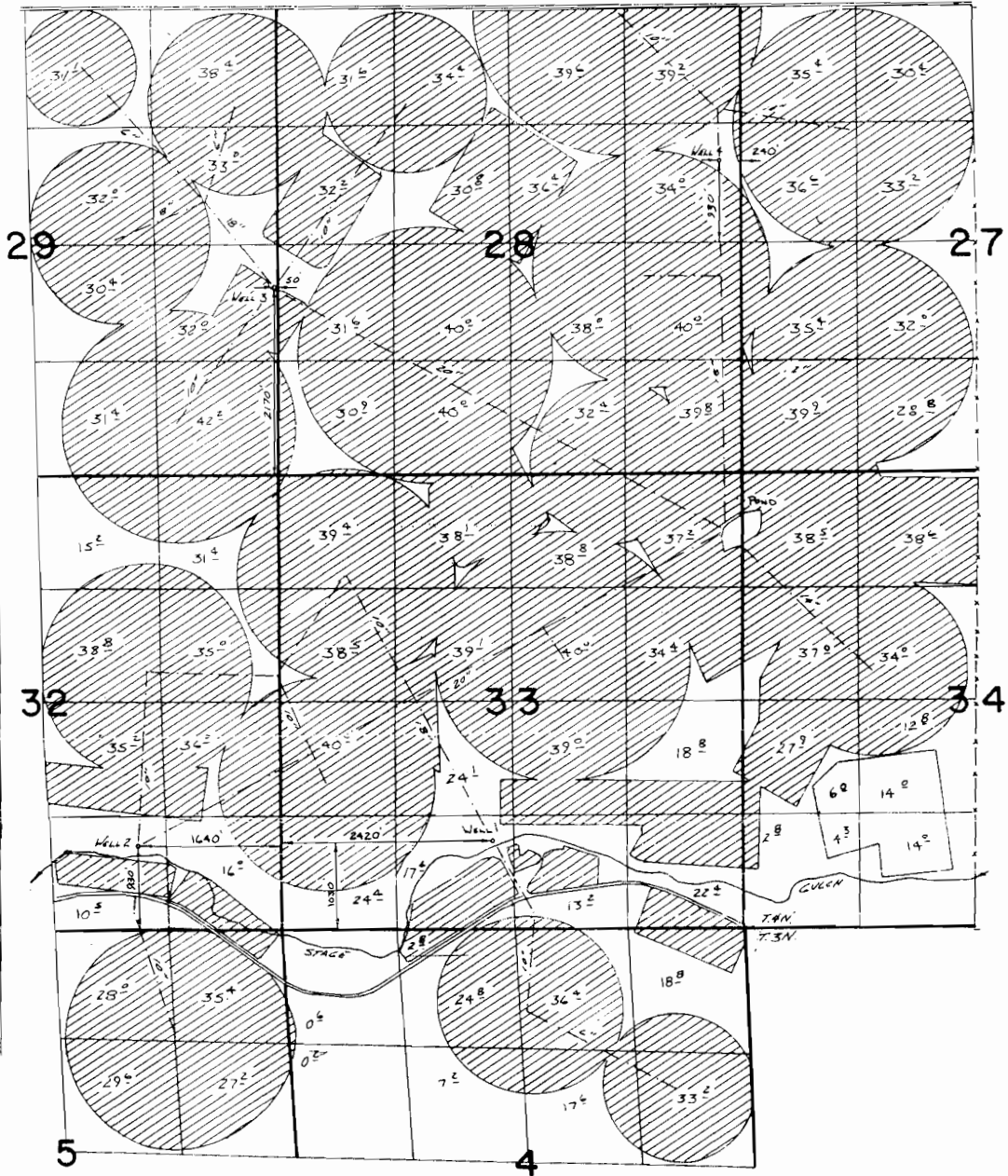

FINAL PROOF SURVEY
UNDER

Scale: 1" = 1320'

APPL. G-8647 PER. G-7929
IN NAME OF

ALL Irr. Acreage
defined by this Final
Proof Survey map in the
amount of 2289.4 acres
applying for Supplemental from
Columbia River.

MERLE GEHRKE

SURVEYED 4-19-1983, BY *V.L. Church*

2/8L 4-10-83

Key:

Proposed place of use:

//// Acreage to be Supplemental
from the Columbia River per
this application. See breakout
of acreage & Tax Lot numbers
on attachment "C", "D".

RECEIVED

NOV 17 2006

WATER RESOURCES DEPT
SALEM, OREGON

Attachments A-D
accompany this map

App No S-86717

T. 4N., R. 30E., Sections 29, 30, 31, 32 Umatilla Co. Basin 7

Attachment "A"
 Primary Water Rights
 Locations (applying
 for). From the
 Columbia River



Scale: 1" = 1320'

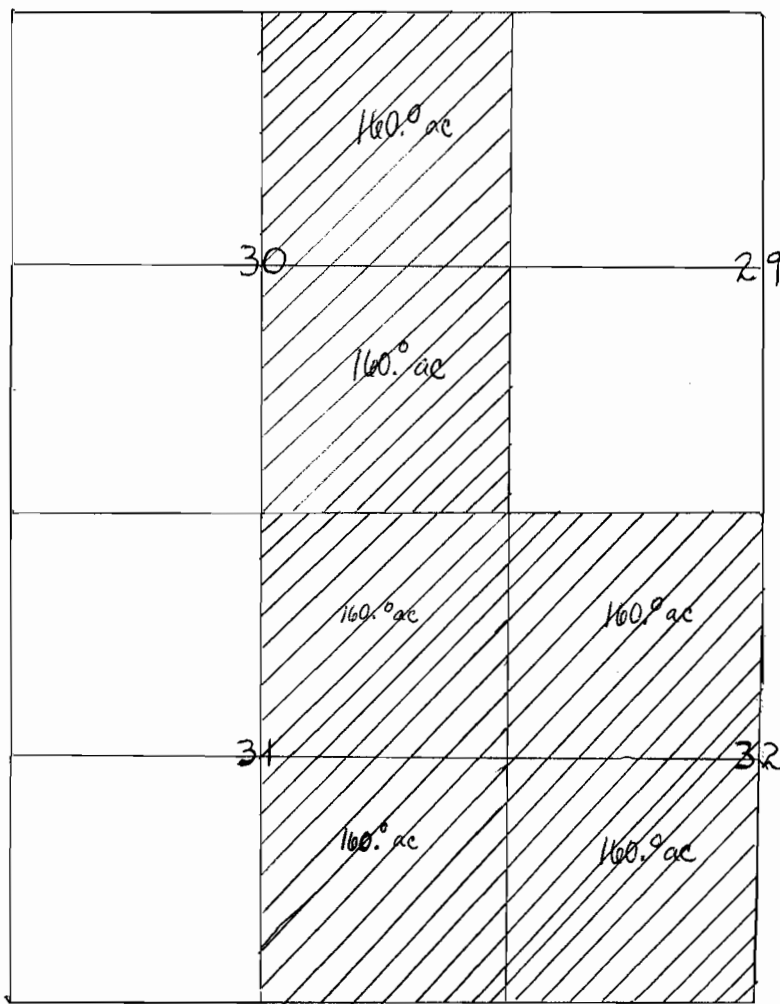

Key

Proposed place of use for
 Primary Irrigation
 from Columbia River
 total: 960 acres

Primary Irrigation

- 160.0 ac NE 1/4
- 160.0 ac SE 1/4
- T. 4N, R. 30E, Sec 30 (TL 3200)

- 160.0 ac NE 1/4
- 160.0 ac SE 1/4
- T. 4N R. 30E, Sec 31 (TL 3200)

- 160.0 ac NW 1/4
- 160.0 ac SW 1/4
- T. 4N, R. 30E, Sec. 32 (TL 3200)

* Portions of these lands
 are currently under temporary
 transfers 9899, 9643.

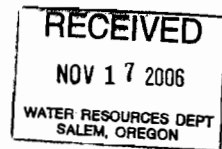

Pod Location : 2910' North & 120' East
from the SW Corner
Sec. 8., T. 5N., R. 30E. WM.

Attachment "B"
Columbia River Pod
to Serve all 3249.4 acres

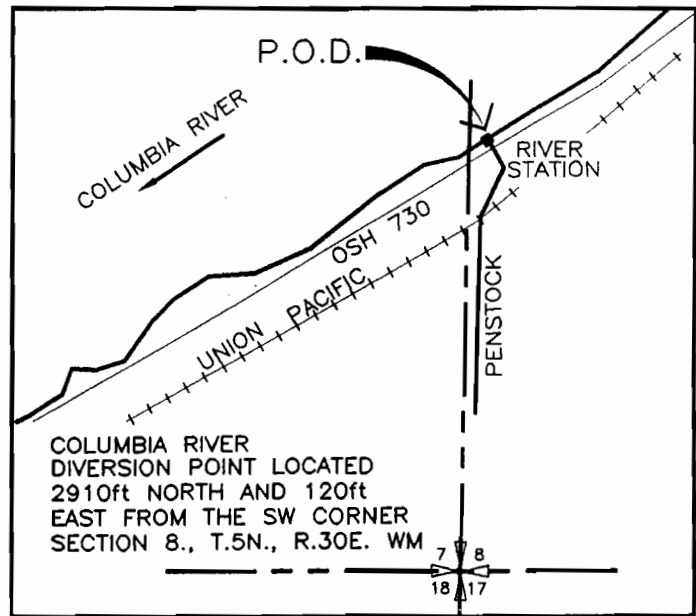

RECEIVED
NOV 17 2006
WATER RESOURCES DEPT
SALEM, OREGON

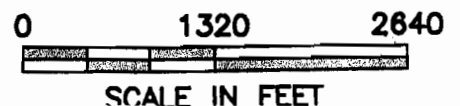
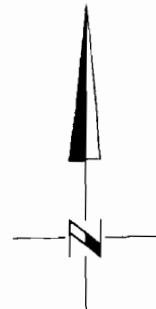

app no S-86717 permit no S-54385