

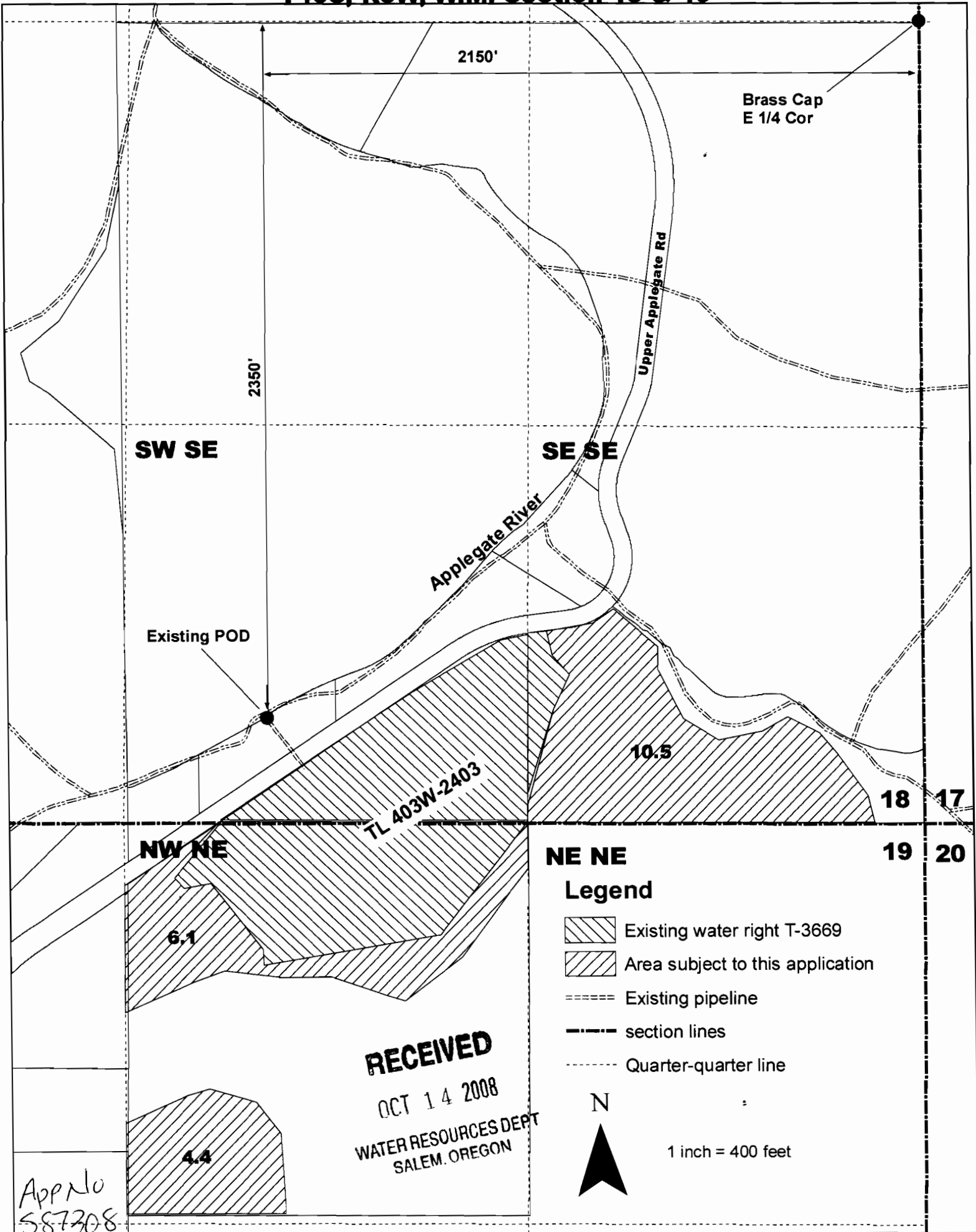





T40S, R3W, W.M. Section 18 & 19



NE NE

18 17
19 20

Legend

-  Existing water right T-3669
-  Area subject to this application
-  Existing pipeline
-  section lines
-  Quarter-quarter line

N



1 inch = 400 feet

RECEIVED

OCT 14 2008
WATER RESOURCES DEPT
SALEM, OREGON

App No
587308