

This Map is the  
 NW 1/4 OF  
 Sec. 2 T. 28 S  
 R7 W W.M.  
 Douglas County

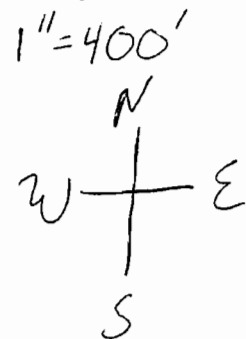

Joseph M. Black

SEE MAP 28 7 3

W COR  
 M LYLE  
 LC NO. 44

**RECEIVED**  
 OCT 31 2007  
 WATER RESOURCES DEPT  
 SALEM, OREGON

1401  
 1602  
**SEE MAP**  
 1603  
 28 7 2C

P.O.D. LOCATED FROM  
 CENTER SECTION 2  
 1775 ft SOUTH  
 760 ft WEST

SEE M 68-26

NW 1/4 NW 1/4 NE 1/4 NW 1/4  
 N88°31'47"W 1324.54'

SEE CS FOR  
 HAYWARD REED

SEE CS  
 55/145

1301 tax Lot 1301 also owned  
 6.92 AC by Joseph Black has current  
 water right piping & point of diversion adjacent

1500 fire  
 29.50 AC SW 1/4 NW 1/4  
 tax lot 1500  
**TOTAL**  
 comprising 29.5  
 acres is proposed

1300  
 16.09 AC SE 1/4 NW 1/4

1600  
 8.56 AC

NW COR  
 DLC 40

1700  
 87.11 AC

LOT 4  
 9.61

SEE M 68-25

26.3A  
 SEE M 52-46  
 new irrigation  
 area.

For Agriculture  
 by Joseph Black  
 EAST 748.56'

Current  
 6" PVC  
 buried

NW 1/4 Sw 1/4  
 tax Lot 1000

3.2A

900

800

SE COR  
 DLC NO. 42

NE COR  
 DLC NO. 44

tax lot 2000

tax lot  
 1600

tax lot  
 2100

Current  
 Pipe  
 6" PVC  
 buried

Current  
 Pipe  
 6" PVC  
 buried

tax lot  
 1600

POD  
 Pump

tax lot  
 1600

2000  
 21.42 AC

LOT 6

8.54

1703  
 9.88 AC

1800  
 3.96 AC

1900  
 130.21 AC

Point of Diversion  
 is 1000 feet  
 South of  
 South East Corner  
 OF DLC #42  
 see 2nd map  
 SW 1/4 Sec 2 T28 R7  
 For Further P.O.D.  
 Details

PARTITION

CEN  
 SEC

NO