

Greenberry Irrigation District

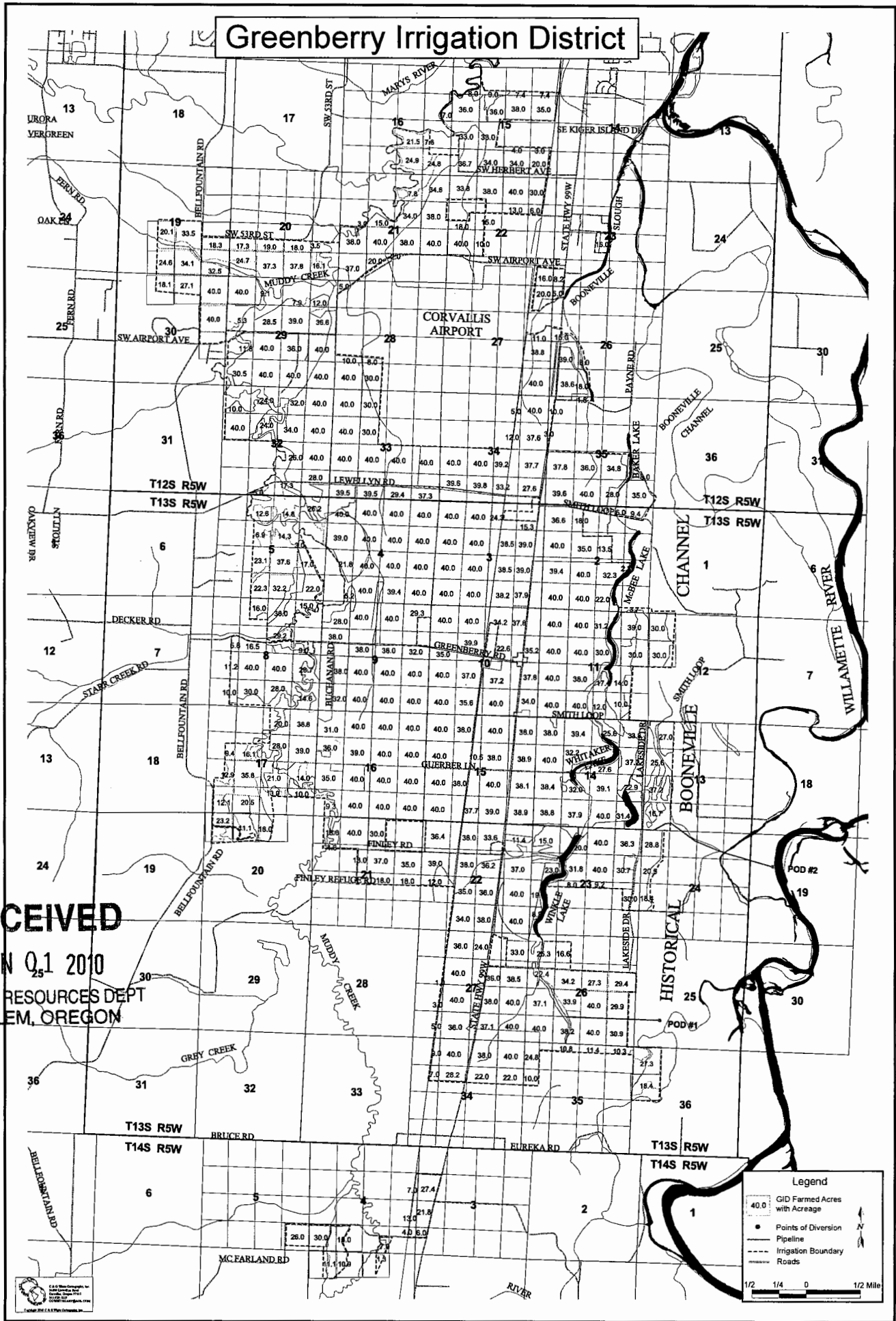

RECEIVED

JAN 01 2010

WATER RESOURCES DEPT
SALEM, OREGON

Legend

- 40.0 GID Farmed Acres with Acreage
- Points of Diversion
- Pipeline
- - - Irrigation Boundary
- Roads

1/2 1/4 0 1/2 Mile



PT ID	TWP	RNG	MER	SEC	Q-Q	Measured Distances
1	13 S	5 W	WM	23	NE NW	690 FEET SOUTH AND 3090 FEET WEST FROM NE CORNER, SECTION 23
2	13 S	5 W	WM	23	NE NW	550 FEET SOUTH AND 3250 FEET WEST FROM NE CORNER, SECTION 23
3	13 S	5 W	WM	23	SE NW	1940 FEET SOUTH AND 3600 FEET WEST FROM NE CORNER, SECTION 23
4	13 S	5 W	WM	23	SW NW	1680 FEET NORTH AND 2530 FEET EAST FROM SE CORNER, IRWIN DLC 51
5	13 S	5 W	WM	23	NW SW	1450 FEET NORTH AND 890 FEET WEST EAST FROM SW CORNER, SECTION 23
6	13 S	5 W	WM	23	NW SW	1850 FEET NORTH AND 580 FEET EAST FORM SW CORNER, SECTION 23
7	13 S	5 W	WM	26	NW NW	1260 FEET NORTH AND 1760 FEET EAST FROM SW CORNER, WINKLE DLC 48
8	13 S	5 W	WM	26	NW NW	385 FEET SOUTH AND 740 FEET EAST FROM NW CORNER, SECTION 26
9	13 S	5 W	WM	26	SW NW	130 FEET NORTH AND 1530 FEET EAST FROM SW CORNER, WINKLE DLC 48
10	13 S	5 W	WM	14	NE SW	460 FEET SOUTH AND 2440 FEET WEST FROM NE CORNER, DLC 47
11	13 S	5 W	WM	14	NE SW	2180 FEET NORTH AND 3760 FEET WEST FROM NE CORNER, SECTION 23
12	13 S	5 W	WM	14	NW NE	1200 FEET SOUTH AND 1250 FEET EASH, N 1/4 CORNER, SECTION 14
13	13 S	5 W	WM	14	SE NW	2550 FEET SOUTH AND 780 FEET WEST, N 1/4 CORNER, SECTION 14
14	13 S	5W	WM	14	SE NE	1410 FEET SOUTH AND 1290 FEET WEST FROM NE CORNER, SECTION 14

RECEIVED

JAN 28 2010

WATER RESOURCES DEPT
SALEM, OREGON

POINT OF DIVERSIONS

RECEIVED

JAN 19 2010

WATER RESOURCES DEPT
SALEM, OREGON

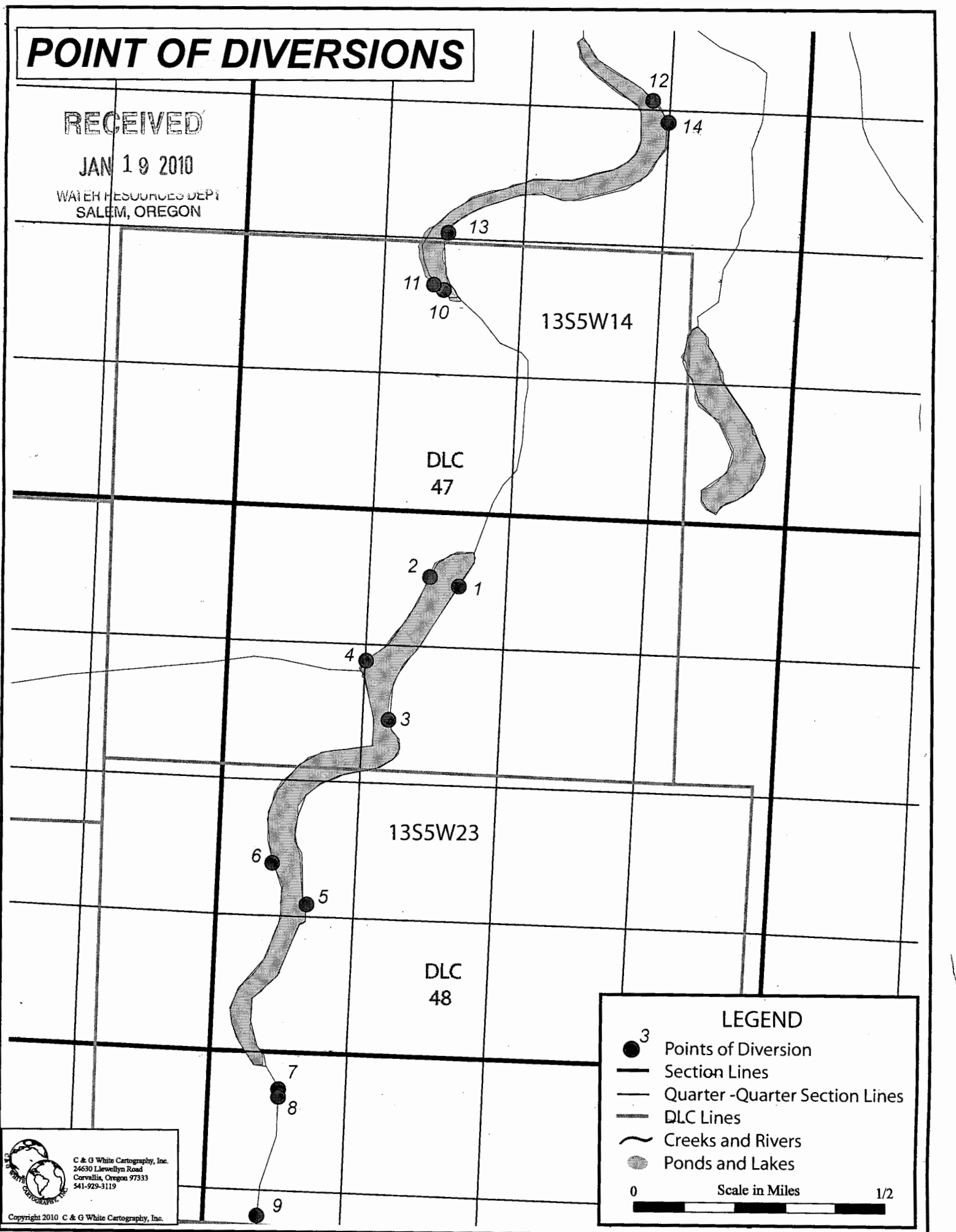

LEGEND

- Points of Diversion
- Section Lines
- Quarter-Quarter Section Lines
- DLC Lines
- ~ Creeks and Rivers
- Ponds and Lakes

0 Scale in Miles 1/2

C & G White Cartography, Inc.
24630 Llewellyn Road
Corvallis, Oregon 97333
541-929-3119

Copyright 2010 C & G White Cartography, Inc.