

THIS MAP WAS PREPARED FOR  
RECORDING PURSUANT TO ORS 201.005

NE 1/4 SE 1/4 SEC. 23 T. 9N. R. 1E. W. 1M.  
MULTNOMAH COUNTY

IN IE 230A  
PORTLAND

Project location

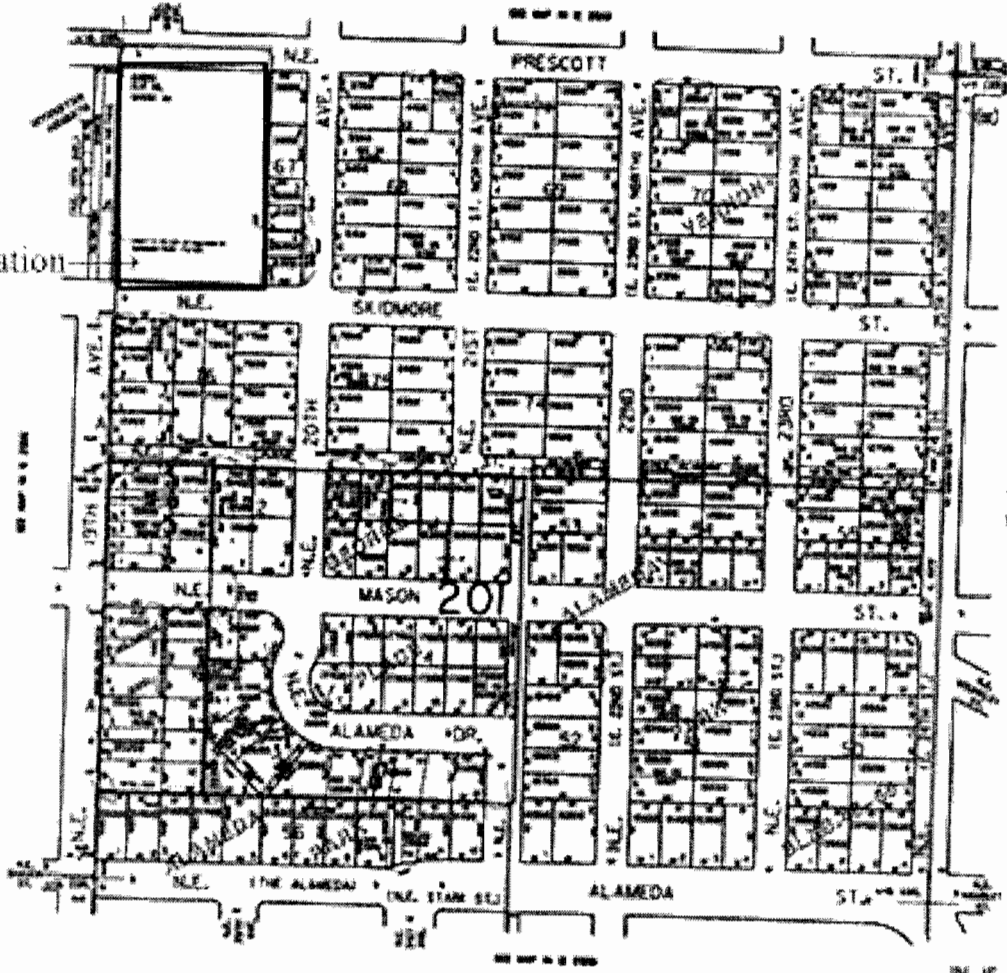

IN IE 230A  
PORTLAND

.../PPR/MSL/TML/DSC/MSM.dwg 1/27/2009 9:58:27 AM

**RECEIVED**

OCT 07 2009

WATER RESOURCES DEPT  
SALEM, OREGON