

NE. Cor. Sec. 15, T.1 N., R. 42E. W.M.

8435

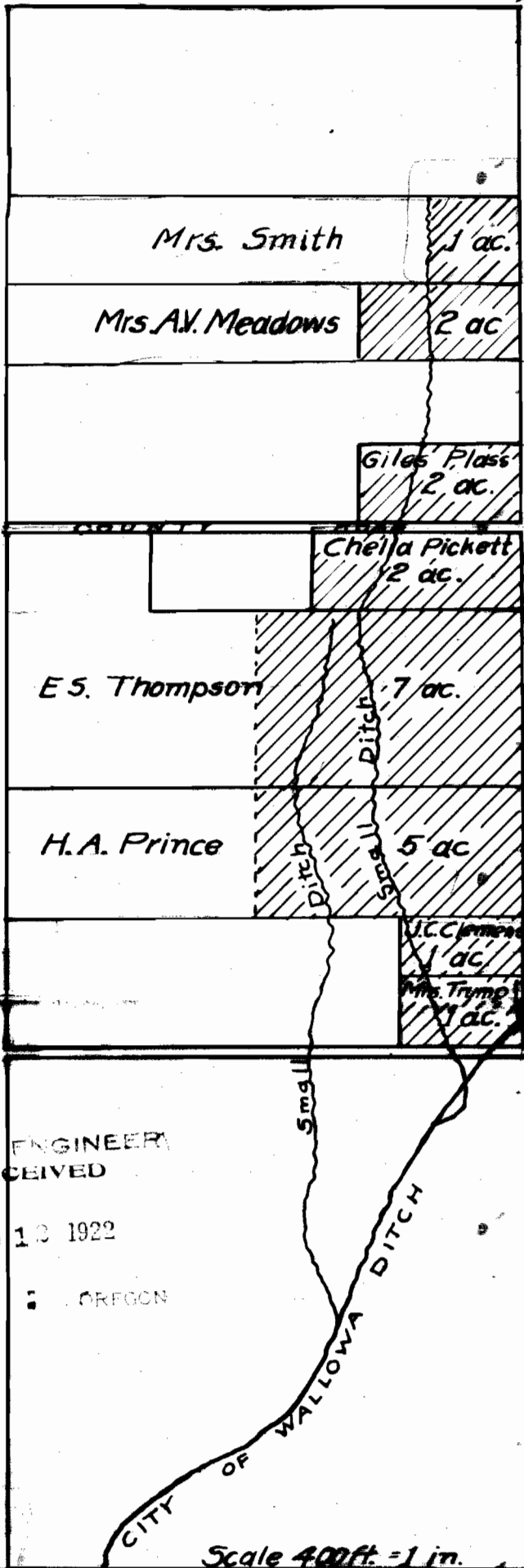

1/4 Cor. bet. Secs. 14 and 15, T.1 N., R. 42E.

STATE ENGINEER RECEIVED

JUN 12 1922

SALEM, OREGON

# MAP

Accompanying Application of Chella Pickett and Others of Wallowa, Oregon, for Permit to appropriate Water.

Certified Correct—  
*Lewis A. Stanley*  
Water Master Dist. 4.

Scale 400ft. = 1 in.  
Scale 2" = 1 mi.

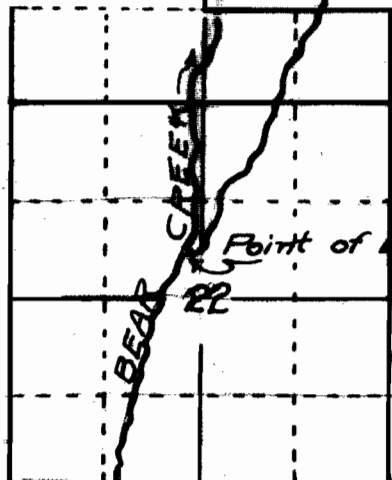

Application No. 8435  
Permit No. 5465

8432