

Application for a Permit to Use Surface Water (Reservoir Withdrawal)

Application in the Name of: **Hot Lake Springs Resort**

Tax Lot 04S39E0500901 in Union County

Township 4 South, Range 39 East, Section 5 (W.M.)

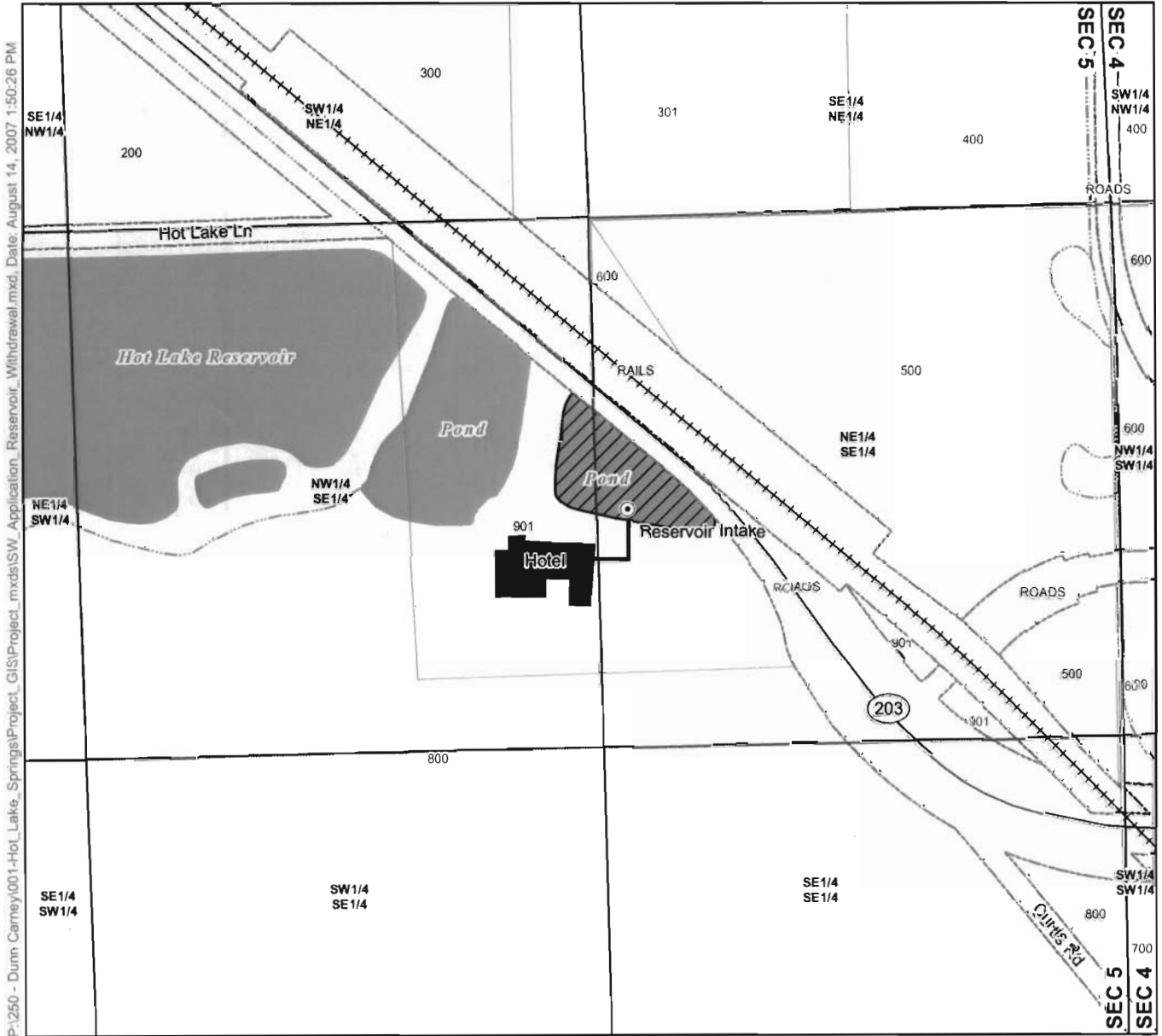

P:\250 - Dunn Carney\001-Hot_Lake_Springs\Project_GIS\Project_mxd\SW_Application_Reservoir_Withdrawal.mxd, Date: August 14, 2007 1:50:26 PM

Legend

- ⊙ Point of Diversion (POD)
- ▨ Reservoir
- Water Mainlines
- - - Road and Railroad ROW
- ++++ Railroad C/L
- Streams and Ditches
- ☘ Waterbodies
- Highway C/L
- ⊕ Tax Lots

POD Legal Description

Reservoir Intake
 Located 710 feet South and 1430 feet East from the center of Section 5, Township 4 South, Range 39 East (W.M.)

Map Information

Map Projection: Oregon State Plane North Zone
 Map Datum: North American Datum of 1983
 Map Date: August 8, 2007
 Prepared By: GSI Water Solutions, Inc.

Data Sources

Union County Planning Department, Oregon Water Resources Department (OWRD), Oregon Geospatial Enterprise Office (GEO)

Note

This map was prepared for the purpose of identifying the location of a water right only and it is not intended to provide legal dimensions or location of property ownership lines.



Scale

1 inch equals 400 feet
 0 100 200 400
 Feet

RECEIVED

RECEIVED OVER THE COUNTER SEP 13 2007

WATER RESOURCES DEPT
 SALEM, OREGON



Appno 5-86970