

RECEIVED

JAN 28 2011

WATER RESOURCES DEPT
SALEM, OREGON

SEC.17 T.26S. R.4W. W.M.
DOUGLAS COUNTY
Scale 1" =600'

Gerald and Penny Anderson Application Map

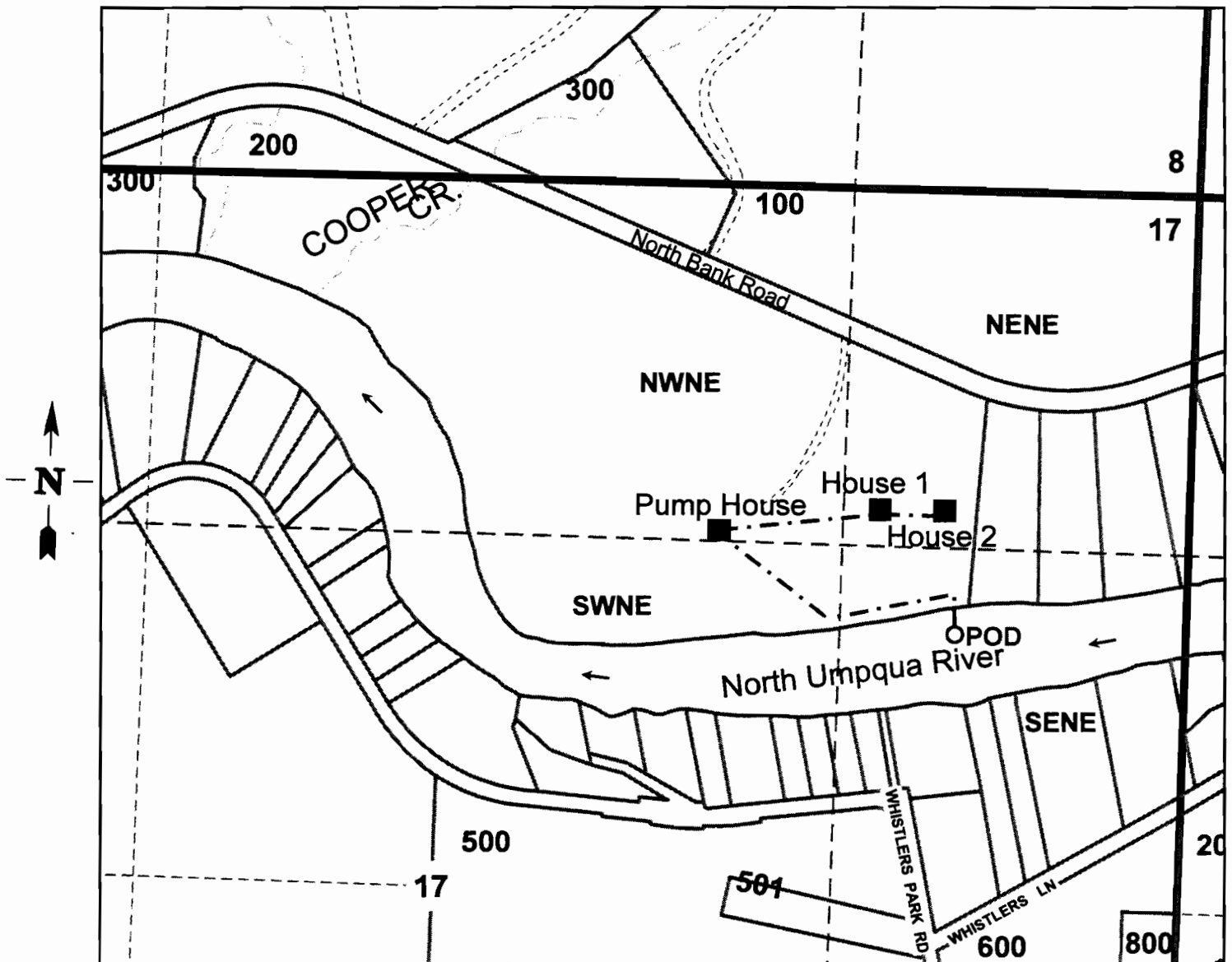

Point of Diversion is 1670 ft. South and 880 ft. West from the NE Corner of Section 17

S-87685