

T1S., R. 11W., W.M.

T1S. & T2S., R. 10 W., W.M.  
TILLAMOOK COUNTY

R. 11W.  
R. 10W.

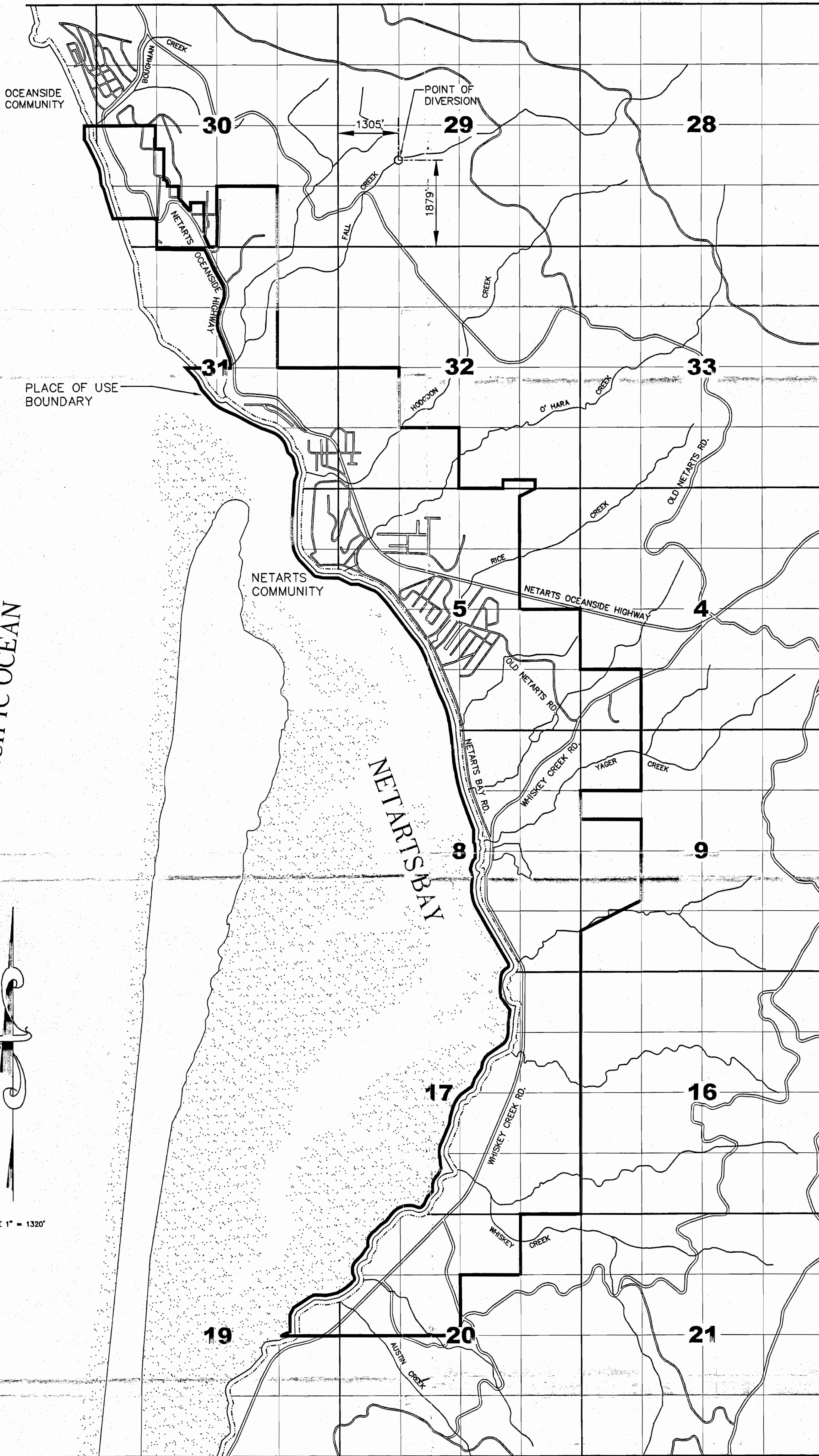

RECEIVED  
OCT 19 2006  
WATER RESOURCES DEPT  
SALEM, OREGON

PACIFIC OCEAN



SCALE 1" = 1320'

T. 1S.  
T. 2S.

THE PURPOSE OF THIS MAP IS TO IDENTIFY THE LOCATION OF THE WATER RIGHT. IT IS NOT INTENDED TO PROVIDE INFORMATION RELATIVE TO THE LOCATION OF PROPERTY OWNERSHIP BOUNDARY LINES.

WATER RIGHT APPLICATION MAP  
IN THE NAME OF  
NETARTS WATER DISTRICT  
(QUASI-MUNICIPAL USE)  
TILLAMOOK COUNTY, OREGON  
SEPTEMBER 18, 2006

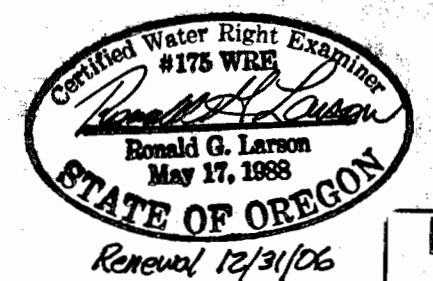

RECEIVED  
OCT 19 2006  
WATER RESOURCES DEPT  
SALEM, OREGON

NO.	DATE	DESCRIPTION	BY

SHEET

1

NETARTS WATER DISTRICT  
WATER RIGHT APPLICATION MAP

JOB NO. M05,244  
DATE SEPT. 18, 2006  
DESIGNED KMS  
DRAWN KMS/SBM  
CHECKED RGL

**HLB & Associates**  
INCORPORATED  
Surveying • Civil Engineering • Planning • Water Rights • Wetlands Consulting

<b>CLATSOP COUNTY</b> 4253A HWY 101 N. GEARHART, OR 97138 (503) 738-3425 FAX: (503) 738-7455	<b>PACIFIC COUNTY</b> 1715B N. PACIFIC AVE. LONG BEACH, WA 98631 (360) 642-4454 FAX: (360) 642-4054	<b>TILLAMOOK COUNTY</b> 160 LANEDA AVE. MANZANITA, OR 97130 (503) 368-5394 FAX: (503) 368-5844
--	---	--