

T.5S., R.3W., W.M.

RECEIVED

OCT 31 1989

WATER RESOURCES DEPT
SALEM, OREGON

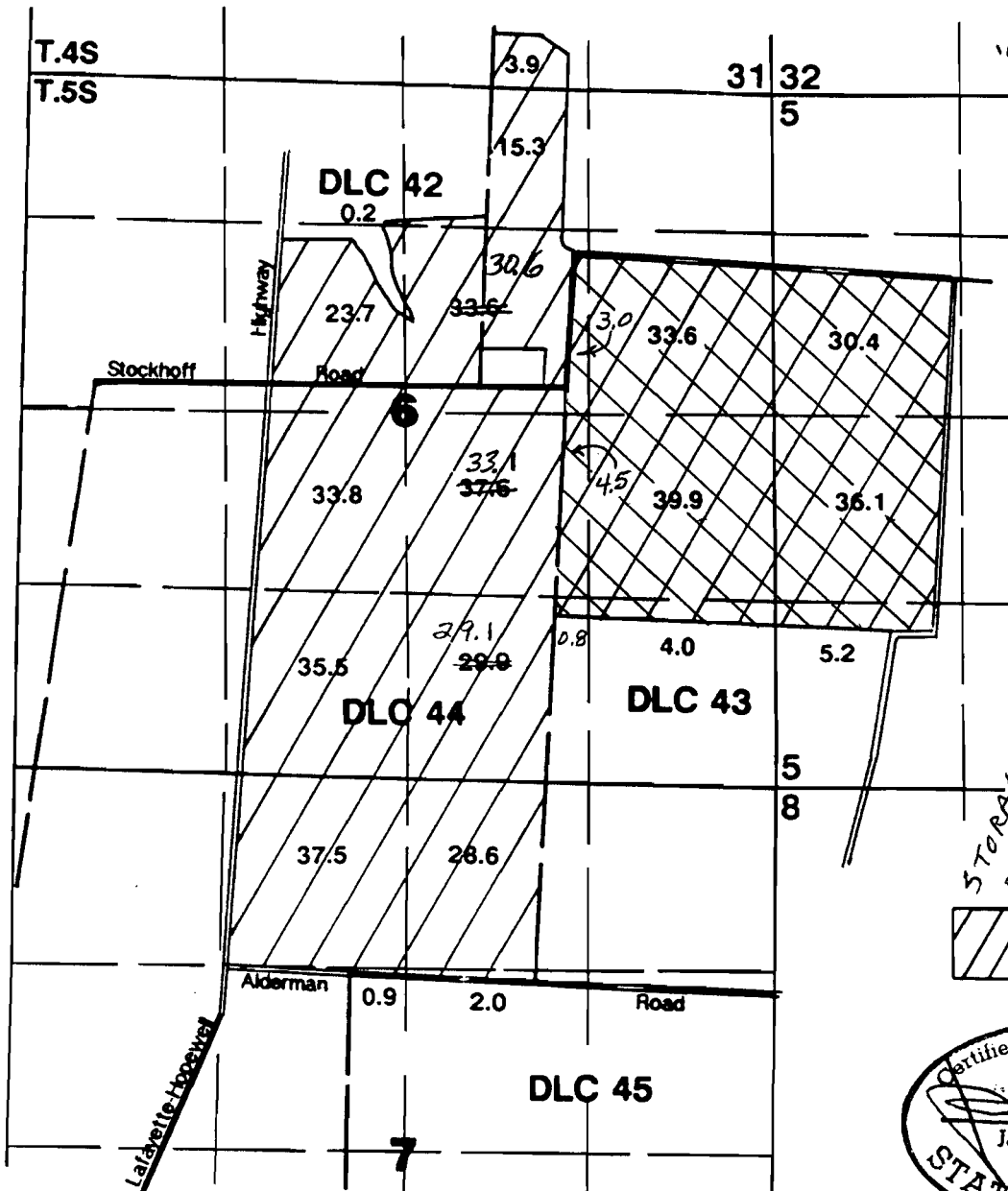

See attached map for location of Div. Pt.

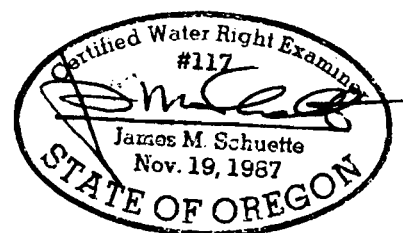

RECEIVED

DEC 20 1995

WATER RESOURCES DEPT
SALEM, OREGON

Palmer Creek Water District
for
Monrovia Nursery

Application Map

OTE: Map is for purpose of identifying location of water right and has no intent to dimension or locate property ownership lines.

Application No. 70110
Permit No.

REV. 12-20-95

Application No. 70110
Permit No.

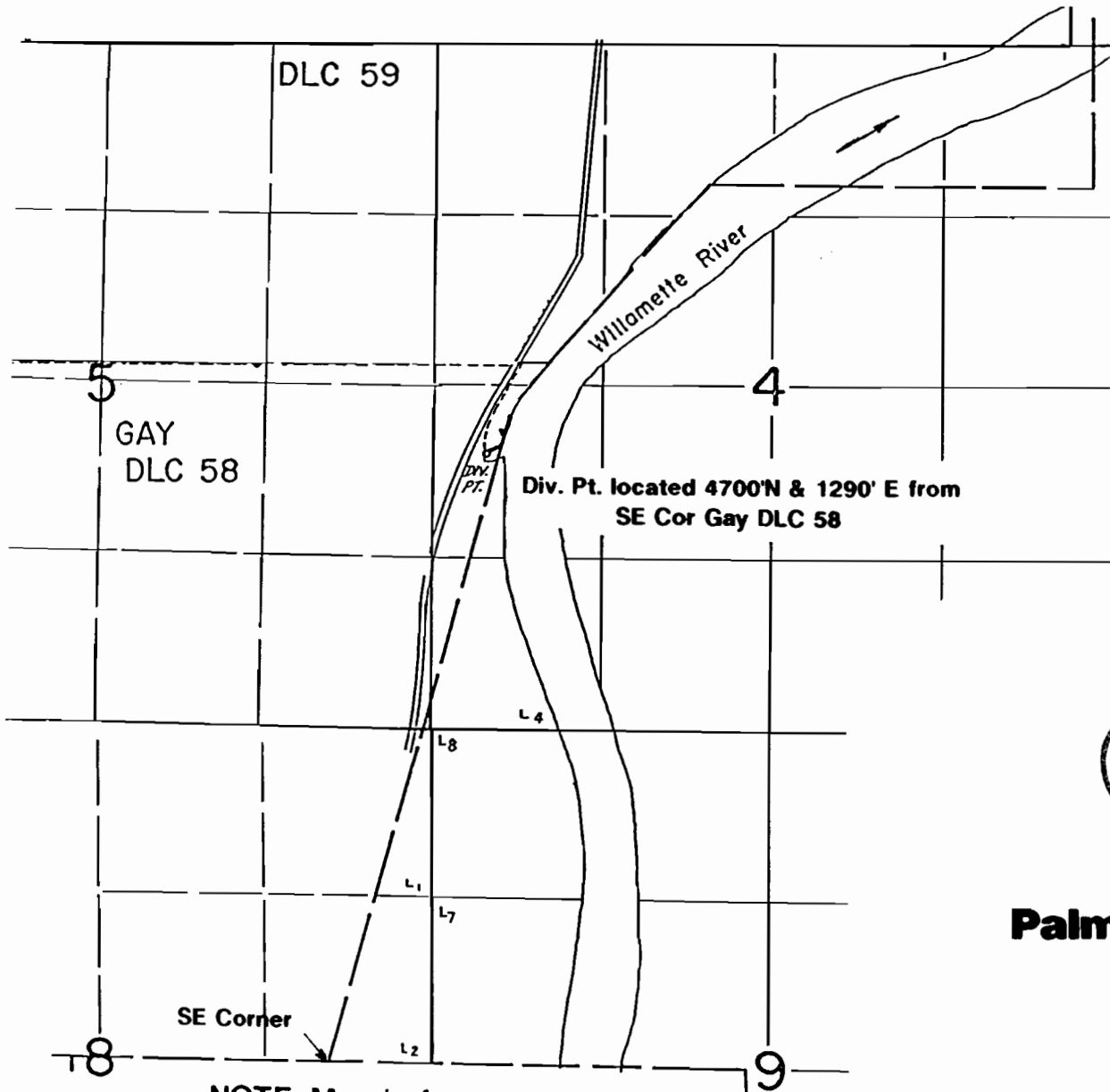

1"=1320'

RECEIVED

OCT 31 1989

T.6S. R.3W.

WATER RESOURCES DISTRICT
SALEM, OREGON

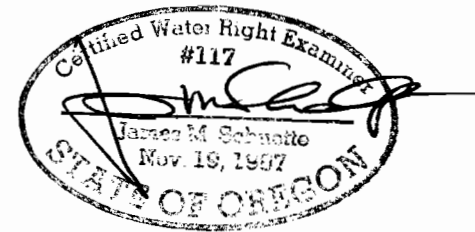

Palmer Creek Water District

for
Monrovia Nursery

Application Map

NOTE: Map is for purpose of identifying location of water right and has no intent to dimension or locate property ownership lines.