

T5S R3W & R4W, WM

YAMHILL COUNTY

RECEIVED

MAR 08 2011

WATER DIVISION OF DEPT. OF AGRICULTURE

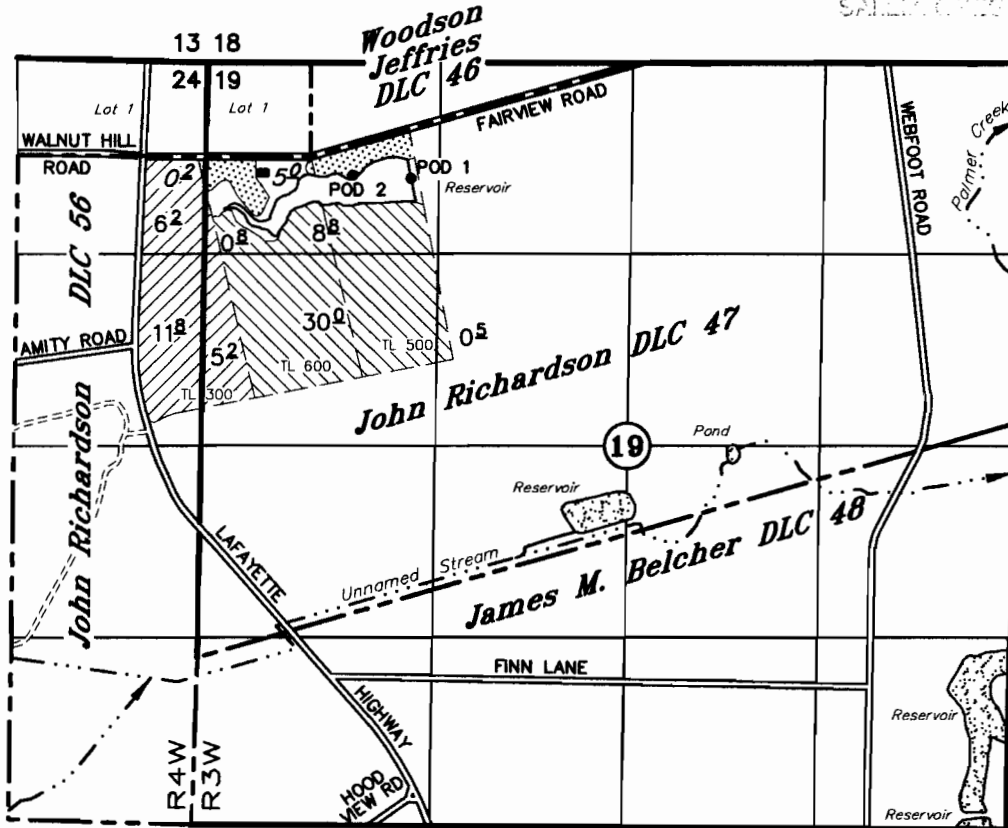



TAX LOTS:

5S 3W 19 500
5S 3W 19 600
5S 4W 24 300

POD 1: 150' S & 690' E OF SW COR JEFFRIES DLC 46
POD 2: 130' S & 290' E OF SW COR JEFFRIES DLC 46

--- TAX LOT LINE

-  Supplemental to Cert 21965
-  Supplemental to Cert 31656
-  Primary

APPLICATION TO APPROPRIATE SURFACE WATER

(STORED WATER ONLY)

UNDER

Application No. _____ Permit No. _____

IN THE NAME OF

MONTE WOOD

FEBRUARY 11, 2011

SCALE: 1" = 1320'

NOTE: This map is not intended to provide legal dimensions or locations of property ownership lines.



EXPIRES 12-31-11

S-87701