

T6S, R8W, WM

POLK COUNTY

RECEIVED

JUN 25 2008

WATER RESOURCES DEPT
SALEM, OREGON

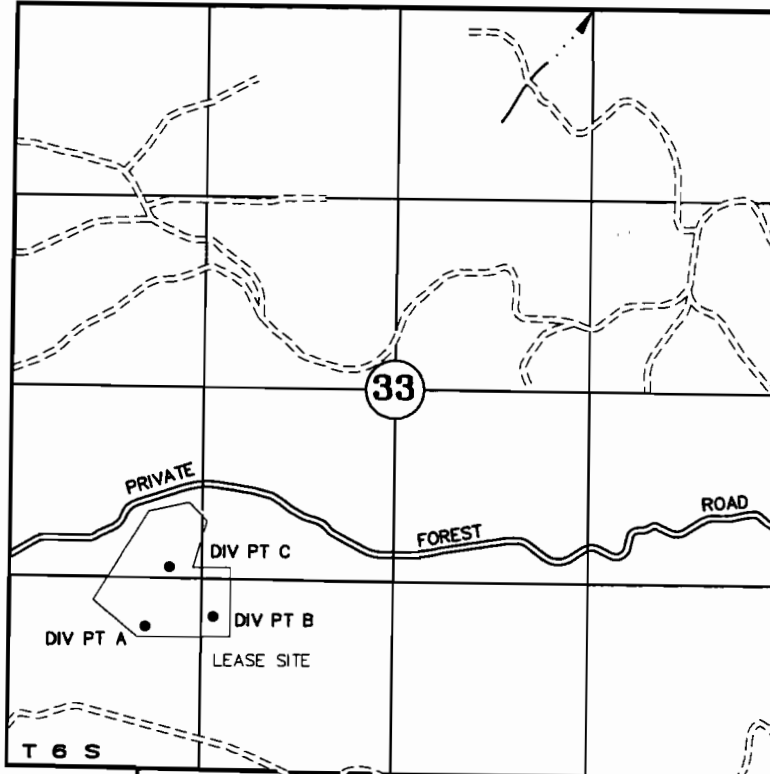

TAX LOT:
6 8W 1800

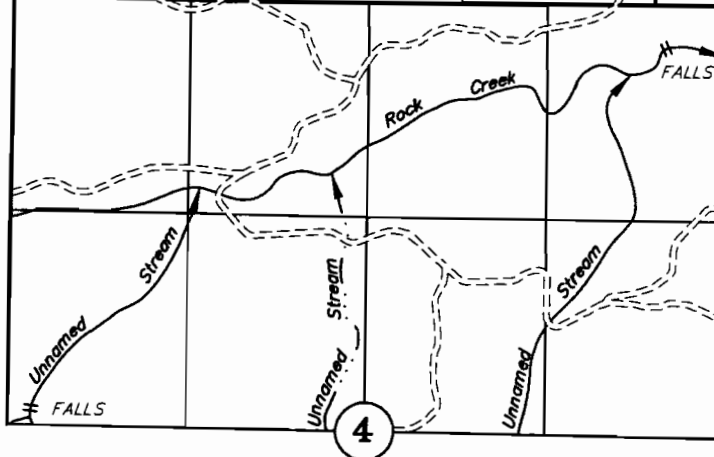

DIV PT A: 960' N & 945' E of SW Cor SEC 33
 DIV PT B: 1030' N & 1420' E of SW Cor SEC 33
 DIV PT C: 1375' N & 1115' E of SW Cor SEC 33

APPLICATION TO APPROPRIATE SURFACE WATER

UNDER

Application No. 5-87207 Permit No. _____

IN THE NAME OF

Grand Ronde Community
Water Association

February 24, 2008

SCALE: 1" = 1320'

NOTE: This map is not intended to provide legal dimensions or locations of property ownership lines.



RENEWAL DATE 12-31-2009

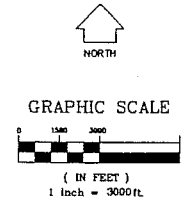
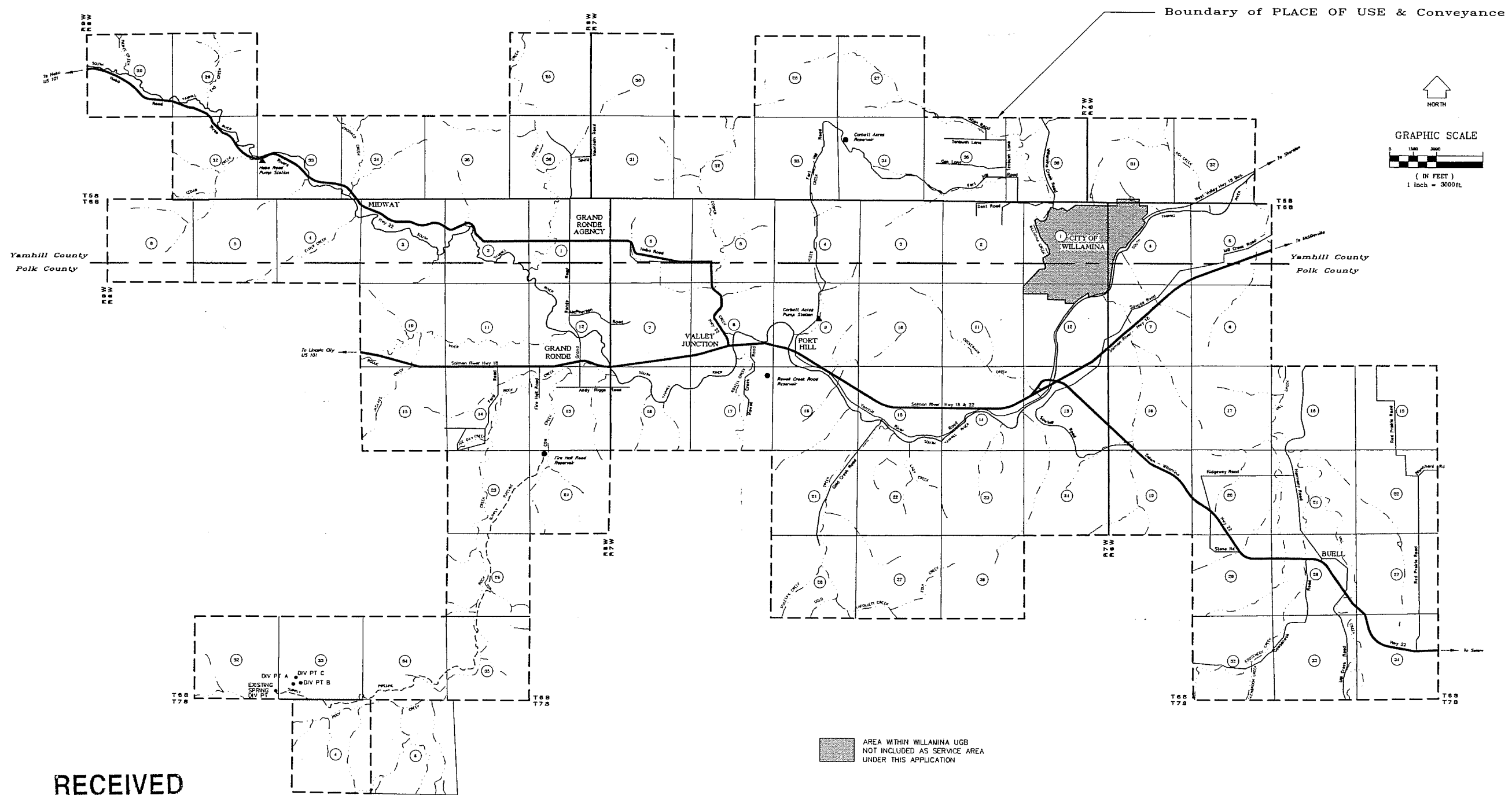

RECEIVED
 JUN 25 2008
 WATER RESOURCES DEPT
 SALEM, OREGON

REDUCTION
 Scale: 1" = 7000'

Grand Ronde Valley SERVICE AREA

NOTE: This map is not intended to provide legal dimensions or locations of property ownership lines.

	Grand Ronde Community Water Association PO Box 253 Grand Ronde, Oregon 97147 Service Area Boundary			
	T 5 & 6 S. R. 6, 7 & 8 W. W. 1 POLK & YAMHILL COUNTIES, OREGON			
	Scale: 1" = 3000' Design: JMB Drawn: JMB Chkd: CFB	Date: JUNE 25, 2008 Boatwright Engineering, Inc. 2613 12th Street SE, SALEM, OREGON 97302 TEL: (503) 363-9225 • FAX: (503) 363-1051		Revised: Job No. Sheet 1 of 1
	EXPIRES 12/31/07			

App No S-87207