

OF

T8S R5E WM, MARION COUNTY

P.O.D. LOCATED FROM SE CORNER SECT. 28
730 ft SOUTH
1250 ft WEST
S29 49V/ 80.48 CH

129

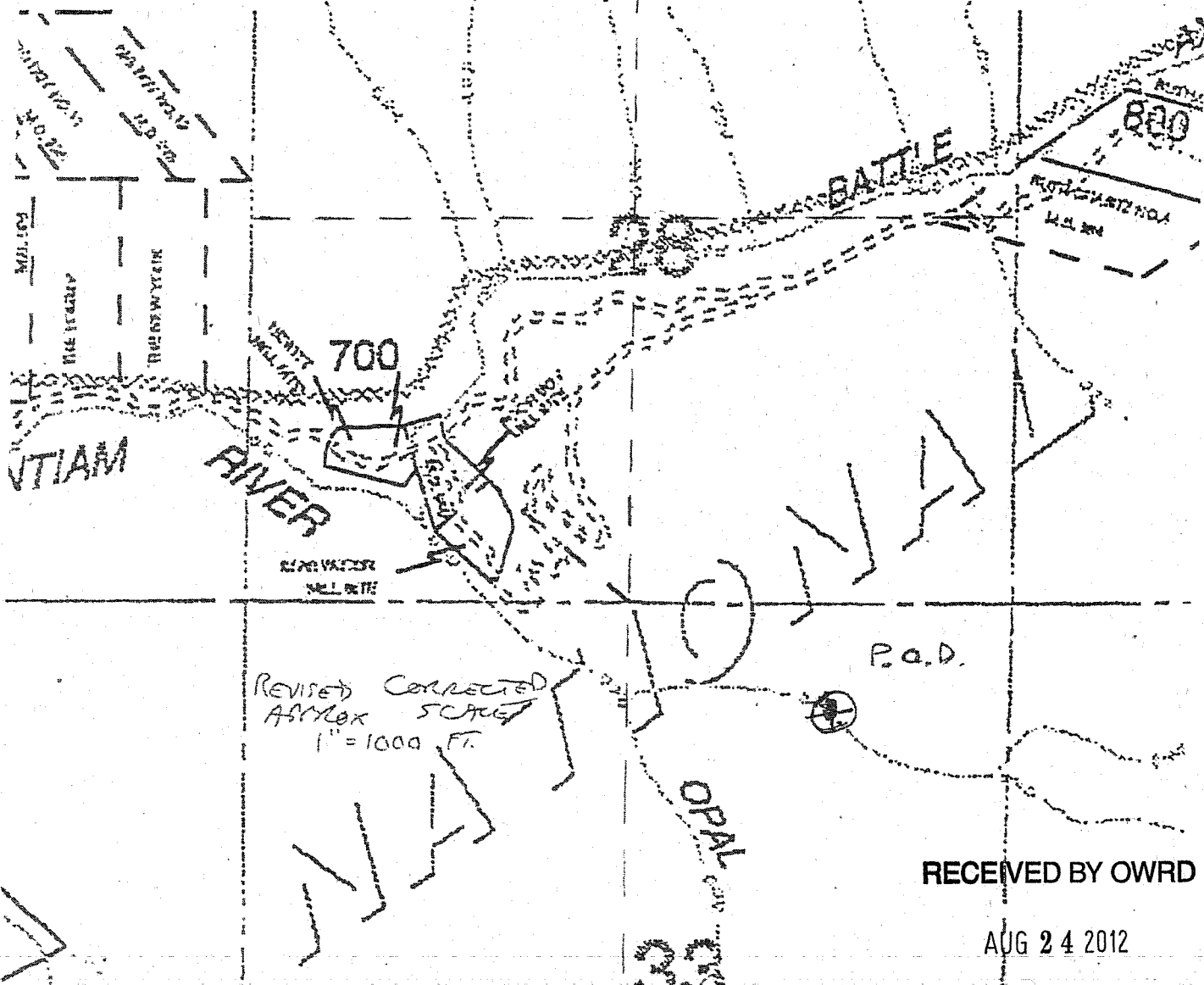

RECEIVED BY OWRD

AUG 24 2012

SALEM, OR

~~S-87883~~
S-87833

MARION COUNTY - T8S, R5E, Section 28, SWSW 1/4

RECEIVED BY OWRD

AUG 24 2012

SALEM, OR

End of the Woods
Wilderness

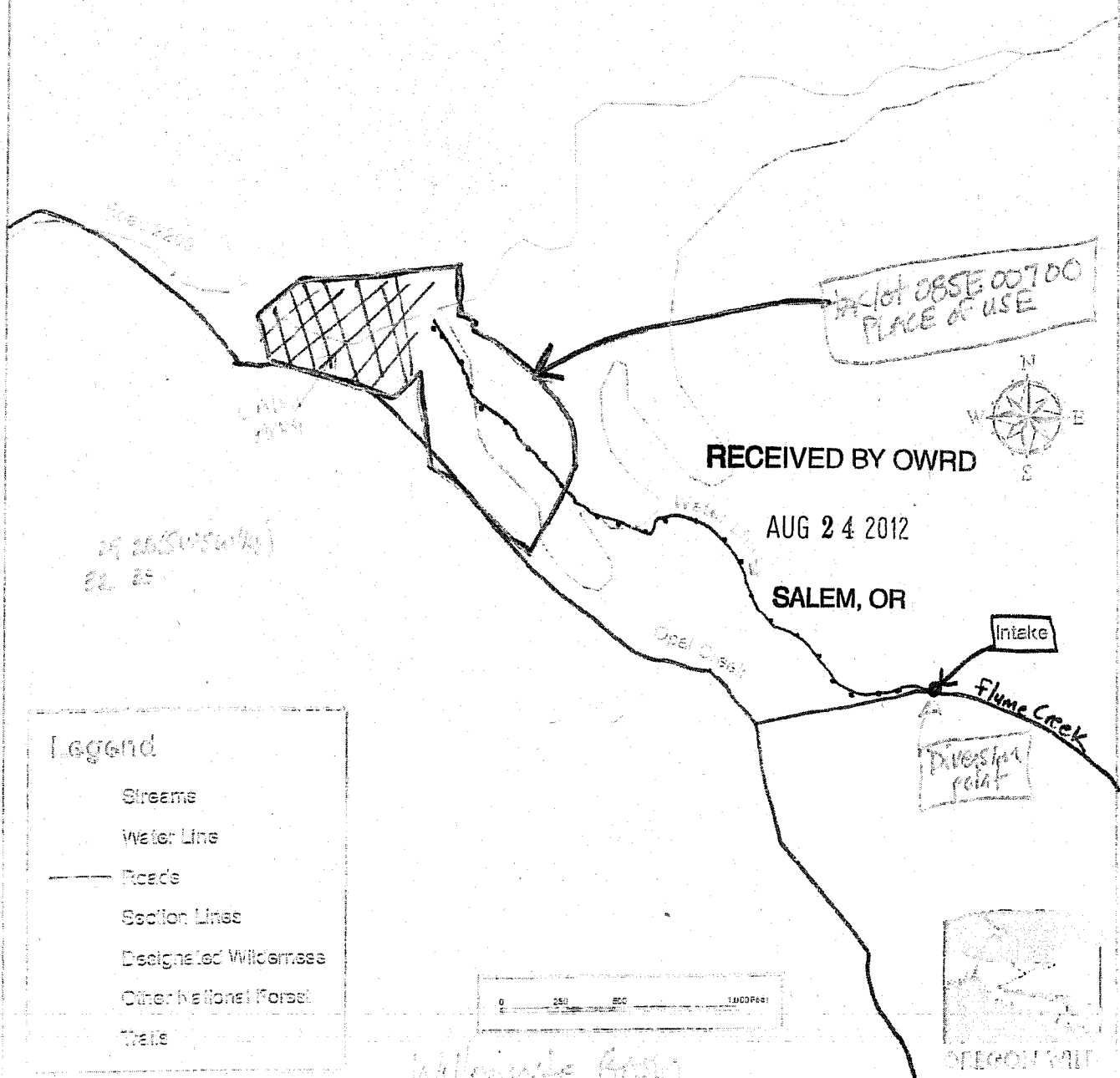

Parcel 085E 00700
PLACE OF USE

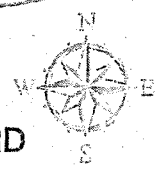

RECEIVED BY OWRD

AUG 24 2012

SALEM, OR

Intake

Diversion
point

Legend

- Streams
- Water Line
- Roads
- Section Lines
- Designated Wilderness
- Other National Forest
- Trails

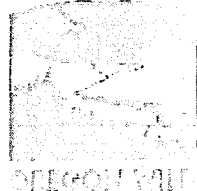

Wilderness Area

~~S-87883~~ P-87833