

Proposed Place of Use:
 0.45 acres 36S-3W-16 SW/SW
 1.20 acres 36S-3W-21 NW/NW
 Taxlot 1300

Point of Diversion: 36S-3W-16 SW/SW
 90' North & 700' East
 from the SW corner of Section 16

Reference Corner:
 SW Corner of Section 16

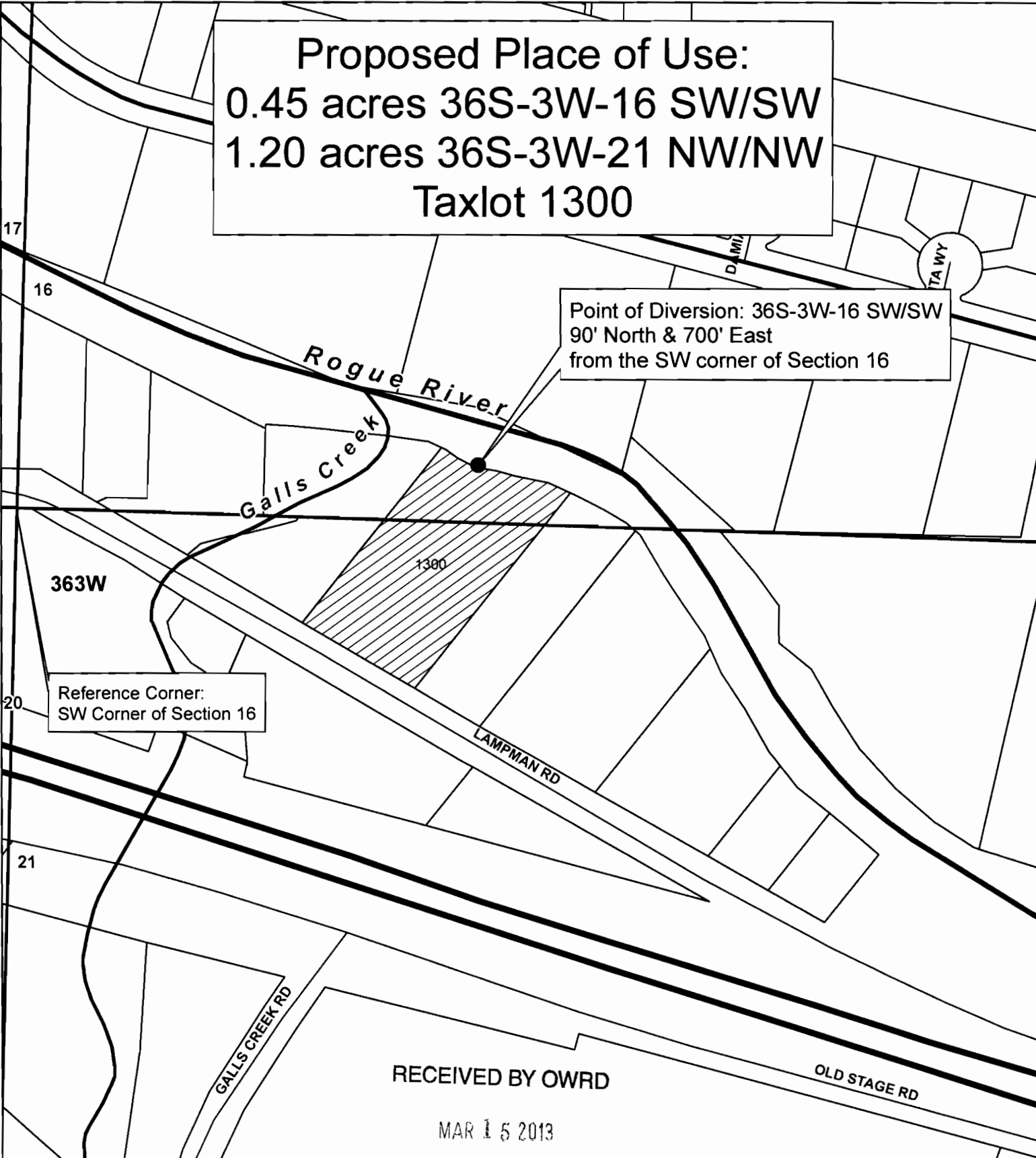

RECEIVED BY OWRD
 MAR 15 2013

Legend

- Place of Use
- Townships
- Taxlots
- Sections
- Point of Diversion

SALEM, OR
 1 inch = 200 feet

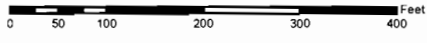

**JACKSON COUNTY
 WATERMASTER**

Prepared by Travis Kelly

This map is based on a digital database compiled by Jackson County from a variety of sources. Jackson County cannot accept responsibility for errors, omissions, or positional accuracy. There are no warranties, expressed or implied.

Date: 03/05/2013, 36-3W-21B-1300 Kook Nam.mxd, KellyTN

C-87879