

MAP TO ACCOMPANY AN APPLICATION FOR A PERMIT TO USE SURFACE WATER FOR:

Jack W. & Marcia E. Fitch
239 Hamilton Road
Jacksonville, OR 97530

T.39S., R.3W., Sec.3, W.M.
Jackson County, Oregon
Tax Lot No. 1800

Prepared by:
Kathy Balogh
Applegate River Watershed Council
6941 Upper Applegate River Rd.
Jacksonville, OR 97530
541-899-9982 x.4

RECEIVED BY OWRD

APR 01 2013

SALEM, OR

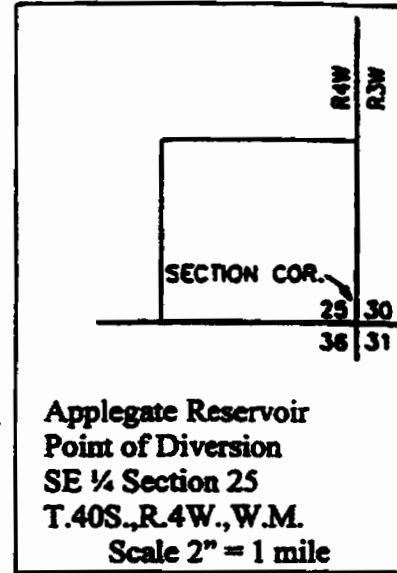

Scale 1" = 400'

6.0 ac NW NW

Point of Diversion: 800' S and 650' W of the NE corner of 39S., R3W, Sec.4
Being in the NE 1/4 NE 1/4 Sec.4

PLACE OF USE

