

T.5S. R.3W. Sections 3, 4, 9, and 10, W.M.

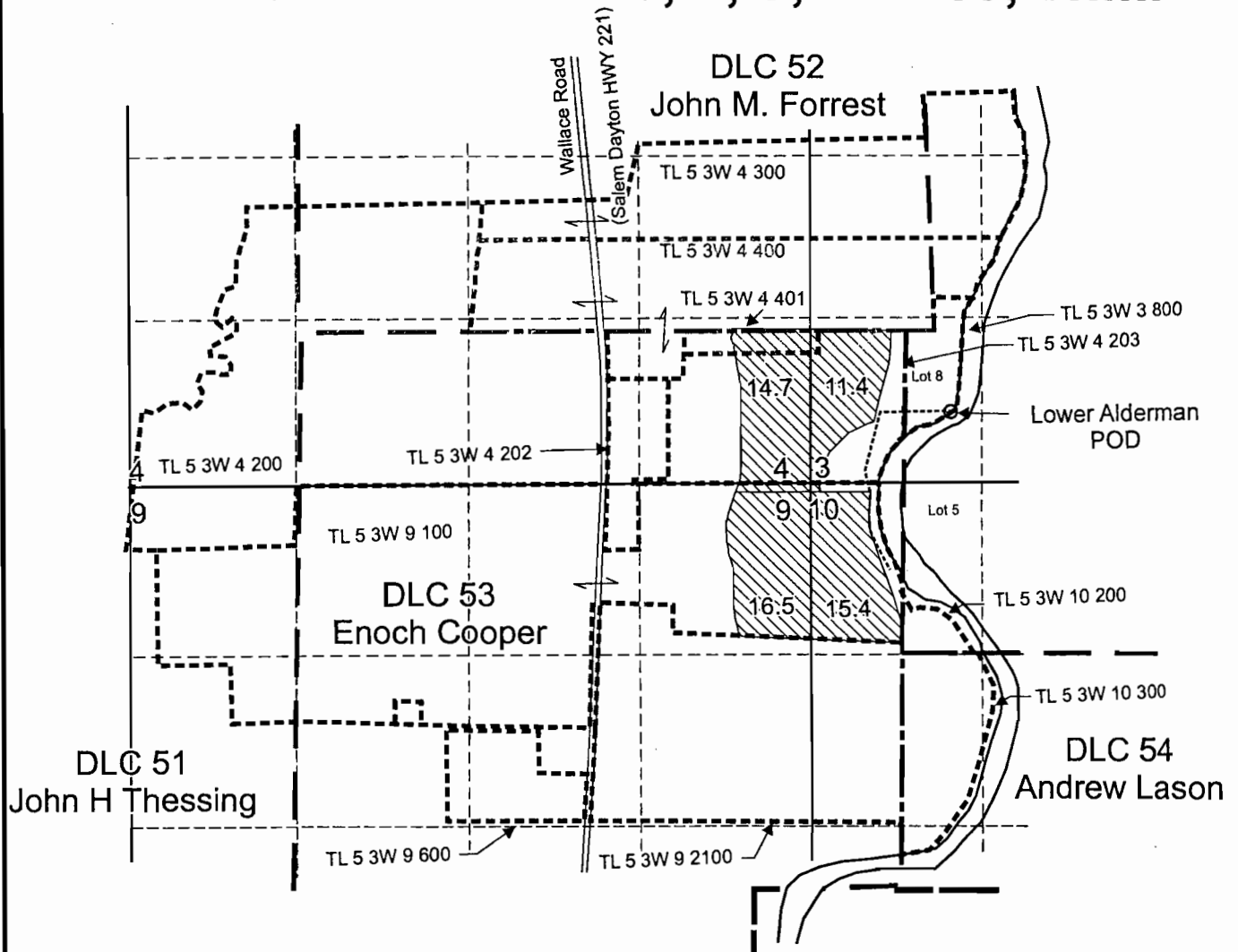

- Lower Alderman Point of Diversion (POD) is located 520 feet north and 1140 feet east from SW corner of Sec. 3
- Area (58 Acres) proposed irrigation use.
- Tax lot boundary
- Irrigation mainline

RECEIVED

MAR 01 2013

WATER RESOURCES DEPT
SALEM, OREGON

Scale: 1" = 1,320'

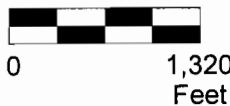

This map was prepared for the purpose of identifying the location of a water right only and is not intended to provide legal dimensions or location of property ownership lines.

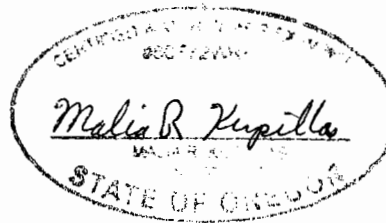

EXPIRATION DATE 6/30/13

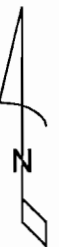

Water Right Application Map

Pacific Hydro-Geology Inc.

Carlton Nursery Co., LLC
T.5S. R.3W. Sections 3, 4, 9, and 10 W.M.

LowerAlderman.cdr

S-87875