

T26 S-R 6 & 7 W W.M.
DOUGLAS COUNTY

PERMIT APPLICATION MAP
FOR
RIVER BEND WEST IRRIGATION ASSOCIATION

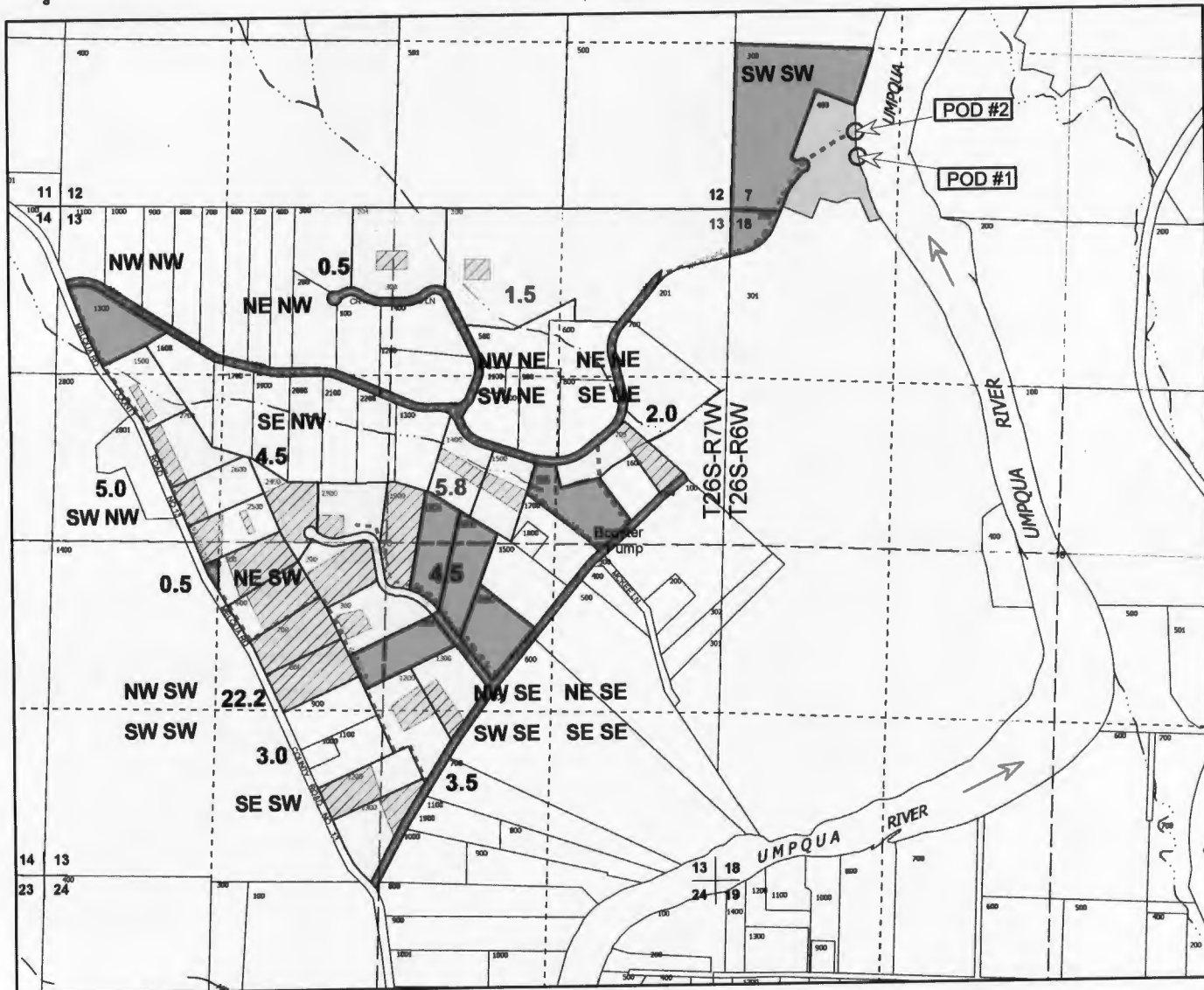

Scale: 1" = 1320'



POINTS OF DIVERSION (POD'S)
POD #1- 430' N & 990' E from SW CORNER SECTION 7
POD #2- 630' N & 960' E from SW CORNER SECTION 7

RECEIVED BY OWRD

MAY 28 2013

SALEM, OR

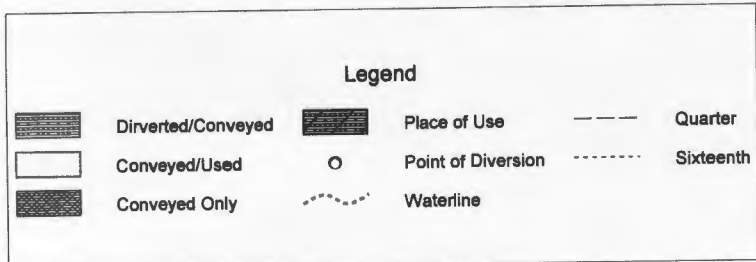

THIS MAP IS FOR THE PURPOSE OF IDENTIFYING THE LOCATION OF THE POINTS OF DIVERSION AND WATER RIGHT AND IS NOT INTENDED TO PROVIDE LEGAL DIMENSIONS OR LOCATION OF PROPERTY OWNERSHIP LINES.

5-87902

T26 S-R 6 & 7 W W.M.
DOUGLAS COUNTY

PERMIT APPLICATION MAP
FOR
RIVER BEND WEST IRRIGATION ASSOCIATION



Scale: 1" = 1320'

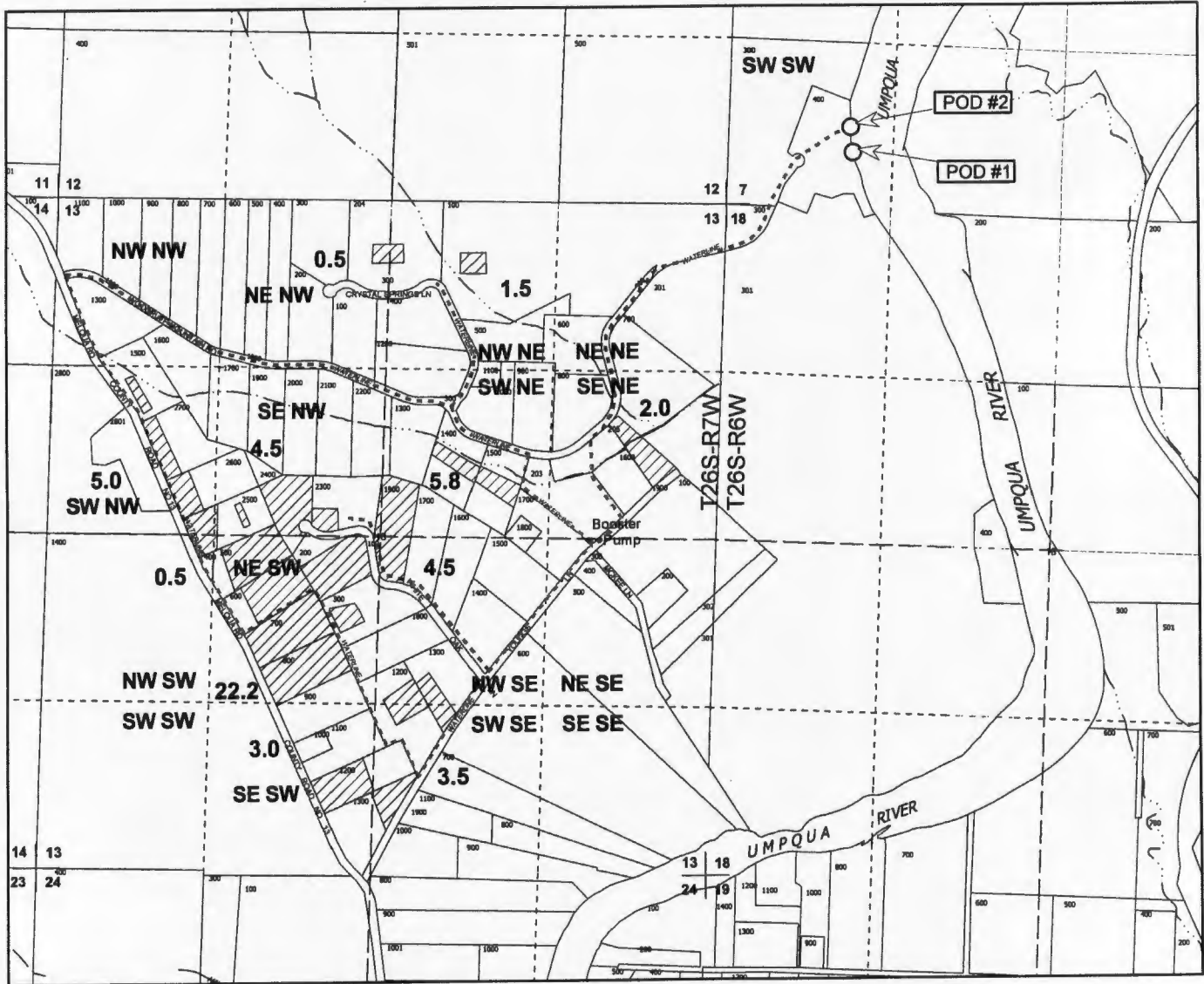

POINTS OF DIVERSION (POD'S)
POD #1- 430' N & 990' E from SW CORNER SECTION 7
POD #2- 630' N & 960' E from SW CORNER SECTION 7

RECEIVED BY OWRD

MAY 28 2013

SALEM, OR

Legend			
	Place of Use		Quarter
	Point of Diversion		Sixteenth
	Waterline		

THIS MAP IS FOR THE PURPOSE OF IDENTIFYING THE LOCATION OF THE POINTS OF DIVERSION AND WATER RIGHT AND IS NOT INTENDED TO PROVIDE LEGAL DIMENSIONS OR LOCATION OF PROPERTY OWNERSHIP LINES.

S-87902